



nutr^{ch}ef



NWIRBBQ99

Smart BBQ Grill Thermometer

Digital Display, Stainless Dual Probes

Safe to Leave in Outdoor Barbecue Meat Smoker

Wireless Remote Alert iOS Android Phone WiFi App

USER GUIDE



Screen Introduction

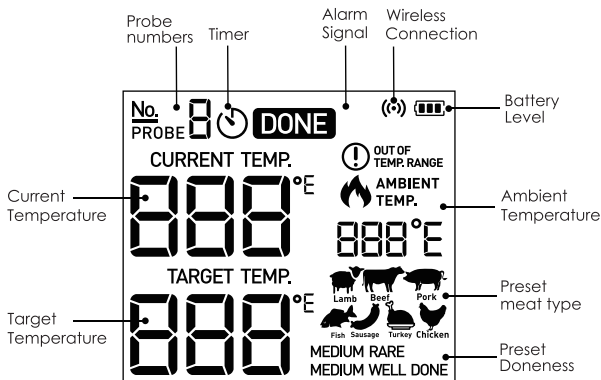

No probe inserted

LLL
Below temp. range

HHH
Above temp. range

☐☐☐
Charging

Battery Recharging

Please use Type-C cable to charge the device

☐ Flashing: Low power (Need to charge)

☐☐ Progress bar: Charging

☐☐☐ Full icon: Fully charged

Install the Probes

The device will keep scanning the sockets when its power is switched ON, the Probe icons on LCD will display one by one from 1 to 6 where probes are plugged in. Then insert the probes into the food, make sure the front tip of the probe is in the center of the food to get accurate temperature.

Download the APP

Search the keyword '**ToGrill**' in Appstore or Google Play, or scan the following QR code with your phone. Download and install it for free.

Make sure your phone meets the requirements:

iOS devices running version 11.0 or later.

Android devices running version 5.0 or later, with BT 4.0 module or later.



APP DOWNLOAD

Power ON/OFF

- Press and hold the button for more than 3 seconds when it is in OFF mode, it will be powered on. The LCD display will show 'ON'.
- If you do the same when it is in ON mode, it will be powered off.
- When there is no probe inserted in the device, it will be powered off automatically.

Activate device and pair with your phone

1. Switch ON your device and keep the BT switch of your phone on.

2. Activate device:

- Launch the '**ToGrill**' app,
- **Enable mobile phone permissions**
- Follow the instructions in the app to activate the device



DEVICE ACTIVATION

Use ToGrill APP to Scan



Scan the QR Code on the device or right

3. Pairing:

i: Sign up for an account in the app.

ii: Press and hold 'PAIR button' for 3 seconds and confirm that screen backlight is blinking.

(Open the stand at the back of the device)

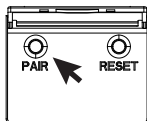

iii: Select 2.4GHz Wi-Fi network and enter password

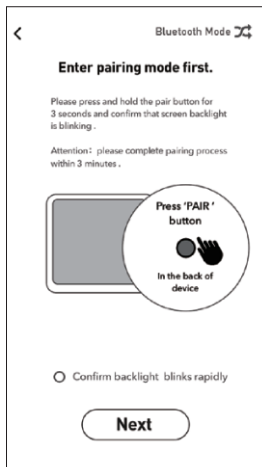

App UI figure: ii

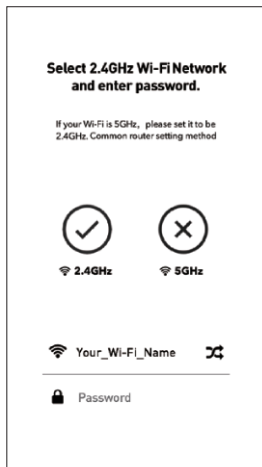

App UI figure: iii

4. Connected successfully.

Once Paired the device with your phone, you don't need to do it again, unless you change to other phones.

Enjoy your barbecue time

Choose food type and preference for the food where each probe is inserted, the app and the device will display its current and target temperature.

When the food is ready, the app and the device will alarm.

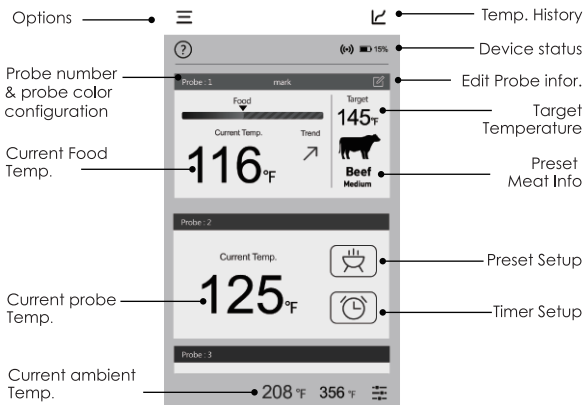

*The user interface of the app may be changed when upgrade.
Please follow the instructions in the app.*

Probe color configuration

It's difficult for you to distinguish different probes when you have several probes using at the same time.

The app provides 6 colors for each channel, which enables users set them to be identical to the color of the probes. The probes comes in 6 colors as well.

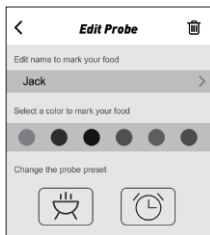

Setting the ambient temperature probe

1. After pairing, insert the pit probe into the socket with the fire/flame logo and the following screen will display.
2. Tap on  icon located at the bottom right of the screen to set your monitoring parameters of the pit probe.

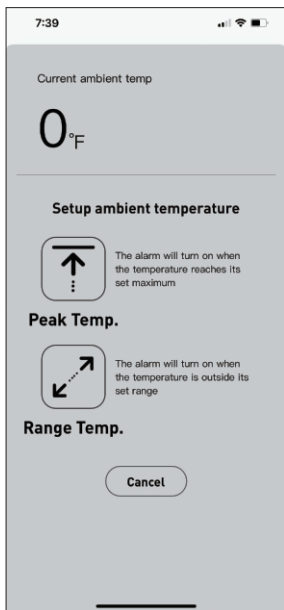
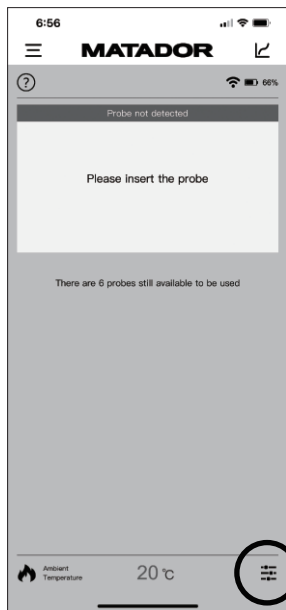

3. From this screen, you can set custom alarm notifications to monitor the cooking temperature of your barbecue/pit.

Setting your meat probes

1. Insert probes into the Thermometer sockets and the below screen will display on your phone.
2. To cook using preset or customised meat temperature settings, tap on the  icon.

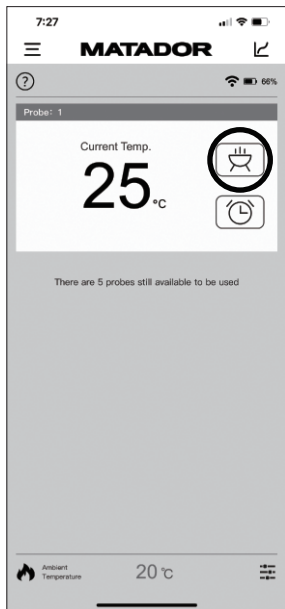

3. The menu selection screen will then display.

Reviewing menu options

1. From your home page, tap on the  icon in the top left-hand corner to open the menu side bar and the menu screen will display.

2. Select 'Settings' option to:

- Set temperature unit F°/C°
- Set an alarm ring tone, vibration alert or alarm interval.
- Toggle push notifications

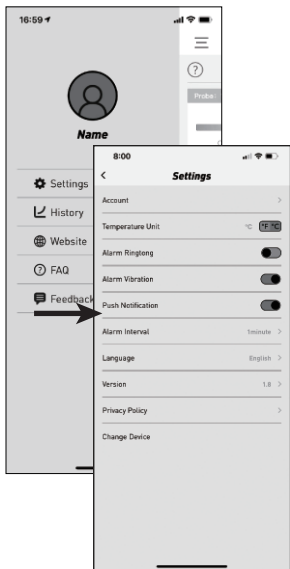
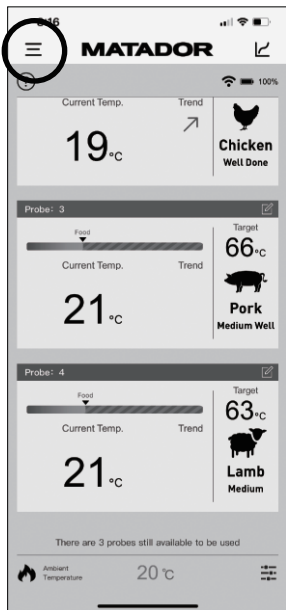

WARNING

The heat resistance varies in different components of the probe,

- **DO NOT** put the probes directly in fire flame.
- **DO NOT** put the wrap into oven, or it wil melt!
- Probes are **NOT** dishwasher safe.

Sensor
Measurement range
0~300°C/32~572°F

Silicone handle
Withstands heat up to
250°C/482°F

**Teflon cable
with stainless steel mesh**
Withstands heat up to
380°C/716°F

Sensor
Measurement range
0~400°C/32~752°F

Metal handle
Withstands heat up to
380°C/716°F

**Teflon cable
with stainless steel mesh**
Withstands heat up to
380°C/716°F

ABS Wrap
80°C/176°F



Food probe

Ambient probe



DEVICE CRASH CONDITION:

Press the reset button, the device will automatically restart.

Attention:

Temp. probes above for reference only, subject to the actual probes.



FCC Caution

This device complies with part 15 of the FCC Rules. Operation is subject to the following two conditions: (1) This device may not cause harmful interference, and (2) this device must accept any interference received, including interference that may cause undesired operation.

15.21 Information to user

Any Changes or modifications not expressly approved by the party responsible for compliance could void the user's authority to operate the equipment.

15.105 Information to the user

Note: This equipment has been tested and found to comply with the limits for a Class B digital device, pursuant to part 15 of the FCC Rules. These limits are designed to provide reasonable protection against harmful interference in a residential installation. This equipment generates uses and can radiate radio frequency energy and, if not installed and used in accordance with the instructions, may cause harmful interference to radio communications. However, there is no guarantee that interference will not occur in a particular installation. If this equipment does cause harmful interference to radio or television reception, which can be determined by turning the equipment off and on, the user is encouraged to try to correct the interference by one or more of the following measures:

- Reorient or relocate the receiving antenna.
- Increase the separation between the equipment and receiver.
- Connect the equipment into an outlet on a circuit different from that to which the receiver is connected.
- Consult the dealer or an experienced radio/TV technician for help.

This equipment complies with FCC radiation exposure limits set forth for an uncontrolled environment. This equipment should be installed and operated with minimum distance 20cm between the radiator & your body.

Features:

- Hassle-Free & Wireless Smart Thermometer
- Programmed with 9 Different Meat, 5 Doneness Settings
- Get Connected & See the Temperature on Your Smartphone
- Insert the Probes for Accurate & Reliable Temp Readouts
- Super Easy Setup with Bluetooth Pairing
- Digital LCD Display Screen
- Battery Operated Design
- Perfect for Backyard BBQ Grilling

The 'ToGrill' App:

- View Your Temperature History Timeline
- Displays Real-Time Temperature
- Unique 'Target Temperature' Setting
- Alarm & Alert Notifications
- Free to Download
- Custom Settings
- View and Export Historical Data
- Generate Poster for Social Media Sharing
- Available for iPhone & Android

What's in the Box:

- Smart BBQ Thermometer
- (2) Temperature SS Probes
- Ambient probe
- Clip
- 2000mAh Rechargeable Li-ion battery

Technical Specs:

- Construction Materials: ABS Body, SS Probes
- Selectable Temperature Units: Fahrenheit / Celsius
- Max Probe Temperature: 32-572 °F
- Max Stainless Steel Cable Temperature: 716 °F
- Battery-Operated: Requires 3.7V Li-ion battery
- Smartphone Support: iPhones 4s, iOS 11.0 & later, Android 5.0 and Later
- Outdoor Wireless Range: 328+ ft
- Indoor Wireless Range: 100+ ft
- Temperature Probe Construction: Stainless Steel
- *Avoid Placing Directly Over Open Flames
- Product Dimensions (L x W x H): 3.9" x 3.15" x 0.9" -inches



nutrichef

Questions? Comments?

We are here to help!

Phone: (1) 718-535-1800

Email: support@pyleusa.com

