

Answers for common problems in use of product

Question: which functions do start power supply have ?

Answer: five in one. It supports power charge/supply for mobile phone, laptop, PSP, MP3/MP4 and other electronic products; possessing lighting function of different modes. It can also guarantee emergency start for auto!



Question: how can LED emergency lighting be turned on?

Answer: turn master switch of start power to "On" and press ④ for 3 seconds to start flashlight function. Afterwards, press ④ LED function to turn normal on to flickering, SOS distress signal light; press ④ again to directly turn it off. See the figure below:

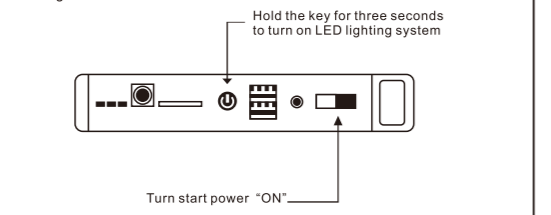

Product parameter

- ▶ Output: 12V
- ▶ Dimension: 165*79*40mm
- ▶ USB output: 5V2A
- ▶ Charge mode: CC/CV 12V1A
- ▶ Start current: 200A
- ▶ Peak current: 600A(3S)
- ▶ Cycle life: 3,000 times
- ▶ Applicable temperature range: -20-60°C

Notice

1. In case of dormancy for long time, it is suggested to maintain certain battery capacity and the product shall be charged at least at every three months.
2. During charging process, mild heat of equipment is normal phenomenon but not fault.
3. It is suggested to use the product under room temperature environment away from moisture, high temperature or ignition source.
4. Please store products in dry area away from moisture and erosive materials.
5. Do not use coarse chemicals for cleaning, such as soap or detergent.
6. In case of battery inflation, leakage or peculiar smell, please stop using battery immediately.
7. Do not drop products in use.
8. Children shall use the battery under instruction of parents strict accordance with specification contents to guarantee correct operation.
9. Please do not throw about or burn waste mobile power supply and cherish environment.

Question: the start power supply has 19V and 12V output functions and how can V number be switched?

Answer: just the start power supply can guarantee several V number selection. Before charging with start power supply, press ① for short time to switch among different V numbers and corresponding indicator light are normally on. Different products use different voltages, e.g., laptops generally have 19V and 15V. Before use, please confirm product V number, such as shown in the figure below:

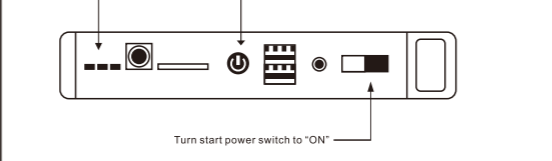

Question: how many times is taken to charge the start power supply?

How can mobile phone and tablet PC be charged?

Answer: it shall take 2-3 hours to charge start power supply.

After master switch of general start power supply is to be turned ON, press ④ button lightly and USB indicator light maintains normal on. By its time, you can charge mobile phone, tablet PC and laptop!

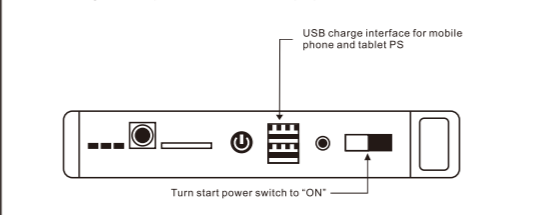

Correct operation flow for auto start



- Operation Instructions:**
1. Before start the car, please make sure the host minimum 2pcs LED indicated light on, then connect the blue plug fully seated into the host socket, and confirm the Cable Indicator is off.
 2. Connect the Red clip to the positive (+) battery terminal. Black clip to the negative (-) battery terminal.
 3. Start the vehicle.
 4. When the vehicles starts, please make sure pull up the clamp cable from power bank and then from the car battery terminals. please do not connect the red and black clip to the vehicle battery terminals within 30s.

Intelligent Jumper Cable Special Instructions:

Operate following the instruction of the Cable Indicator:

1. Light on: means that the connection is correct and the circuit is work, you can turn on the engine.
2. Light off: means wrongly connection of positive and negative to the car battery terminals, the host won't open and work, please check and make sure connect correctly.
3. Light quick blinking: means short circuit, the light will off soon, please check and correct again.
4. Light slow blinking: means battery is under protected from overcharge, the relay is cut off to protect the product. Especially after start successfully, if not pull up the clamp, the light will blink slowly, if want to start again, please pull up the clamp from the host and car, and then connect again correctly according to the first instruction.
5. After start the car and pull up the clamp cable, please wait for 30s if want to try again to connect the black and red clamp.

Question: how can an auto be started?

Answer: if an auto cannot be started by the storage battery because of various reasons, the start power supply can exert superpowerful effects. At first, inspect electrical quantity of start power. Generally, the auto can be started when there is one check display of indicator light. Connect positive and negative polarities of storage battery with positive and negative polarities of storage battery. After red polarise and black polarise are clamped, insert plug of battery terminal into start outlet of start power, turn auto key to start auto. After start the auto, remove clamps from battery.

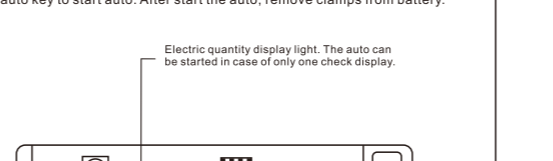

Question: in case of mis-operation, what shall happen in case of contact between positive and negative polarities of storage battery wire clip?

Considerate some careless users wrongly connect the positive and negative position to the car battery terminal, which will maybe make damage to the product and cars, we developed an intelligent clamp cable, which will prevent this damage, if wrongly connect the positive and negative position to the car battery terminal, the intelligent clamp cable won't work, no current input and output, so it is more safe.

Detailed fittings of product

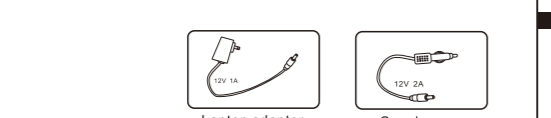
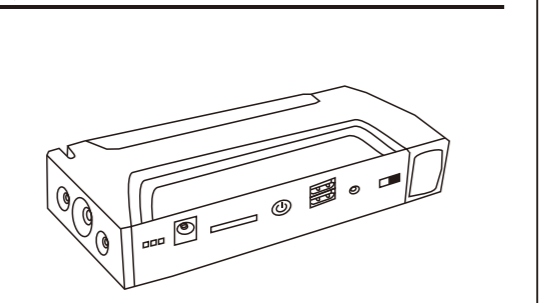

Question: how can start power supply be charged?

Answer: Use home adapter or Car adapter connected to 220V commercial power or 12V car power supply product will begin to charge; the indicator light will be flash all time. When four indicator lights are on, it indicates the power supply has been full-charged! Such as shown in the figure below:

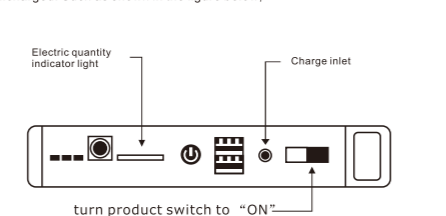

Question: how to use this product to charge laptop?

Answer: turn start power supply to "ON" and to choose power supply voltage to suitable for laptop (eg in case of 19V voltage at adapter, press ① key to switch to 19V). Afterwards, connect adapter to charge laptop (have 8 adapters to choose which suitable most of laptops.) To supply power to laptop, it is suggested to remove laptop power supply affixed to increase the service life!

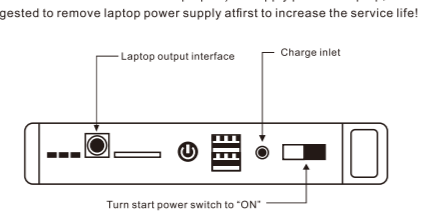

Detailed illustrative diagram of product function

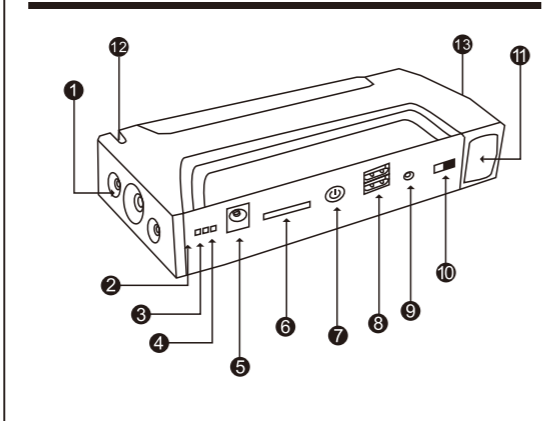

1. LED illumination light
2. 19V voltage output indicator light
3. 18V voltage output indicator light
4. 12V voltage output indicator light
5. 12V/19V/2A/3.5A/3.5A outlet
6. Electric quantity indicator light
7. Key switch
8. USB 5A-2A outlet
9. 12V=1A charge inlet
10. Master switch
11. 12V=200A auto start outlet
12. Blade
13. Emergency hammer

Special Precautions of The Auto EPS

1. Please put the blue plug enough in the Auto EPS.
2. Make sure that the number of indicator lights are not less than 3.
3. If the Auto EPS can not start car, please stop to start car. Please check the clip of car's battery clamped firmly or not. And check the battery clip whether clamped firmly or not, And check there any rust or dirt in the car? Start the car again after cleaned-up and checked.
4. During starting. If the blue indicator off or can't work. Please charger for the Auto EPS. Then it will work.

5. During starting. If the Auto EPS can't continue to start car after starting 3-5 times. Please stop to start car. Please check the other breakdowns. Otherwise it will make the fuse and Auto EPS broken.

6. When the car starts, remove Auto EPS cable from Auto EPS and disconnect red and black clamps to the car battery terminals within 30 seconds.

We do not take responsibility for loss caused by your operation against above usages. If you need the car to start technical support can call the dealer.