

FRONT  
SIZE: 411(W) X 279(H)mm  
COLOUR: BLACK

## INSTRUCTION MANUAL

### 2 IN 1 WATERPROOF BLUETOOTH SPEAKER + HANDSET

### 2 IN 1 WATERPROOF BLUETOOTH SPEAKER + HANDSET



Bluetooth Wireless Waterproof Shower Speaker & Hands Free

Speaker-phone

PBTWP24



This product is of waterproof construction with quality sound that will enrich your shower time, enjoy your favorite music, anywhere and anytime. This Bluetooth wireless system can be easily paired with most Bluetooth devices (such as tablets, notebooks, smartphones, PCs, etc.). Also, built-in microphone enables you to talk on the phone while you are showering.



Waterproof performance:

The waterproof level of this product complies with IP47 standards, it is designed to ensure normal operation in water at a specified conditions.

#### Product Description:

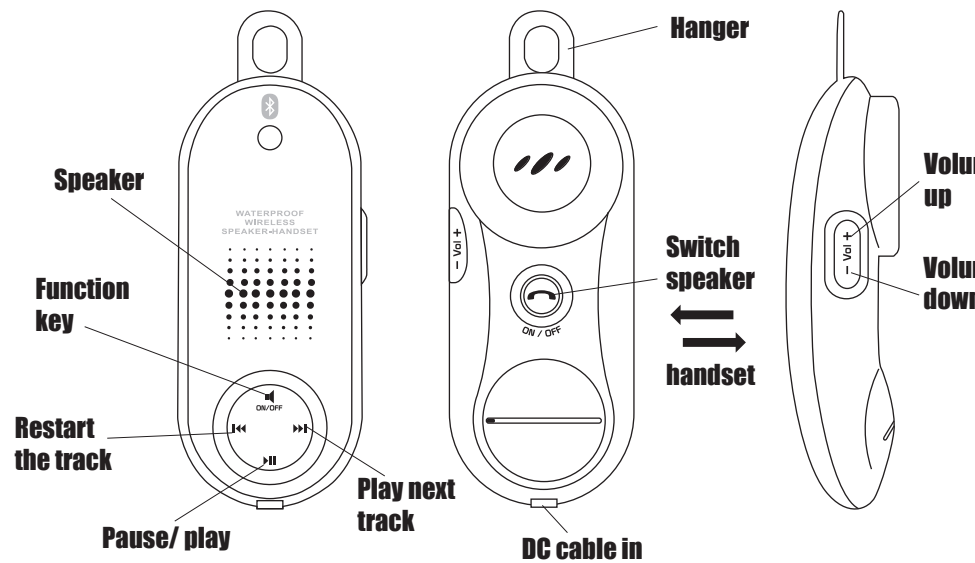

#### Before using this unit:

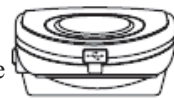

Please ensure that the watertight cap of the DC plug is securely closed before using this unit. Damage can happen to unit by water seeping into the unit from to loosely closed watertight cap. Water droplets that enter the speaker or microphone holes do not cause damage. However, the product performance may temporarily decrease until the water droplets are dried. Problems may include unclear sound and microphone insensitivity. If such circumstances exist, please remove water droplets and dry the product

#### Product Specifications:

Bluetooth version	Bluetooth V2.1 +EDR A2DP and AVRCP
Operating range (maximum)	32 feet (The transmission distance changed depending on the environment where the product is used.
SNR speaker	40 1.5 inch
SNR handset	80 1 inch
Speaker impedance	4ohm
Handset impedance	8ohm
Power supply	Built in Li-Polymer
Battery Capacity	3.7V / 800mAh
Current consumption:	200mA (Max)
Continuous standby time: #	180 Hours
Continuous transmission time: #	8 hours
#The actual continuous standby/transmission times may become shorter than those in the specifications depending on the environment or conditions for keeping/using the unit, etc.	
#Battery degrades in time. The battery service time gradually decreases after charging and discharging several cycles, even if the batteries are used properly.	
#The battery performance deteriorates quickly if the unit is kept under high temperature conditions. Please keep the unit in a cool, well-ventilated location, away from direct sunlight.	
Operating Temperature:	90 °F to -40 °F
Operating humidity range:	20-80% (no condensation)
Product size:	2.5"(W) x 5.9"(H) x 1.6"(D) inch
Weight:	4.86 oz.
Waterproof performance:	IP47
Number of devices that can be registered	8

#### Charging the battery:

- Charging the battery from your PC via the USB charging cable, included in the package.
- The LED lamp will be red while the battery is charging.
- The LED lamp will be off when the battery is fully charged.
- It takes around 1.5 hours to fully charge the battery

- Connect the USB charging cable to the unit
- Connect the USB charging cable to your PC

\* when he battery power is depleted, a beeping alarm will sound, and the LED lamp will blink red. After a while, product will turn off

#### Pairing the product with your device:

- To turn on the product, hold **ON/OFF** for around 7 seconds, a signal will sound 'BEEP~' keep pressing until the red & blue light is flashing, and you hear the sound 'BIBI', this notifies you that it is ready to be paired.
- The first time the unit is paired, use your device to search for the product model "PBTWP24".
- When your device finds the product model, press to connect, your device will show if it is successfully connected or not.
- If it is successfully connected, you can play music through the product.

Note: Terminate any connection between the product and any device before starting the pairing procedure. The pairing procedure cannot be started while a Bluetooth connection is established between the product and a registered device. Terminate the connection and turn off the product.

BACK  
SIZE: 411(W) X 279(H)mm  
COLOUR: BLACK

### 2 IN 1 WATERPROOF BLUETOOTH SPEAKER + HANDSET

### 2 IN 1 WATERPROOF BLUETOOTH SPEAKER + HANDSET

### 2 IN 1 WATERPROOF BLUETOOTH SPEAKER + HANDSET

#### Up to eight Bluetooth device scan be registered:

When nine or more devices are registered, the previously registered devices will be deleted starting from the oldest, to register new ones. A device that is registered twice or more is identified as one device.

#### Play music:

Press **vol+** to increase the volume. (when up to maximum, it will sound a 'Beep~' sound)

Press **vol-** to decrease the volume. (when up to minimum, it will sound a 'Beep~' sound)

Press **⏮** to restart the current track. Press twice to play previous track.

Press **⏭** to play next track.

Press **⏸** to pause/ play the track.



- when it is lit green LED, sound source play via handset
- when it is not lit, sound source plays via speaker

Hold **ON/OFF** for 7 seconds to turn off connection of Bluetooth

#### Part 1: pick up call:

- For incoming call, press **ON/OFF** to pick up the call, you will hear sound via speaker
- Press **ON/OFF** (with green LED on), you can hear the sound via handset. Press **ON/OFF** (with green LED light off) to switch the sound source to speaker
- Whenever you are hearing sound source via speaker or handset, you can **vol-** or **vol+** to adjust the sound source volume.
- Press **⏸** once to mute sound, press **⏸** once again to return to normal.
- After finish the conversation, please **ON/OFF** to hang up.

\*\*Note: To avoid / reduce echo, please do not turn the speaker to maximum volume.

\*\* The blue light will be blinking for all incoming call.

\*\* The blue light will be blinking when talking via speaker

\*\* The green light button will lit up when talking via handset

#### Part 2: Make a call:

- Hold **ON/OFF** for 2 seconds to redial the latest call you make.
- Some smartphones have voice command, press **ON/OFF** once to enter voice command function with your smartphone. For details, please refer your smartphone instructions. This feature may be different depending on your smartphone's settings.
- After you are finished with the conversation, press **ON/OFF** to hang up.

#### Part 3: Pick up another incoming call:

- While you are talking over the phone and have another incoming call, press **ON/OFF** twice to pick up incoming call.
- Press twice **ON/OFF** to switch to the other party.
- Press once **ON/OFF** to hang up the phone

#### Part 4 reject incoming call:

- While unit is ringing with incoming call, hold **ON/OFF** to reject the call.
- If you are playing the song, press **ON/OFF** once again to continue playing the song.

#### Speaker & handset sound source switching:

Press **ON/OFF** (with green LED on), you can hear the sound via handset.

Press **ON/OFF** (with green LED light off) to hear the sound via speaker

#### Initializing the registration history / resetting the hardware of product:

While unit is powered off, press **ON/OFF** & **vol+** together until sounds a signal with red light.

#### Caution:

- Please take full precautions when setting the ringtone volume.**  
When this product is paired with a mobile phone, a loud ringtone may startle you, which in turn may result in an accident or a heart attack. Gradually increase the volume from the minimum to set it appropriately.
- Do not damage cables that are connected to this product.**  
Fire may result from damaged cables.
- Never leave this product in a car.**  
Leaving this product in a hot car for many hours will result in rupture of the built-in battery, sparking, and other dangers, posing significant danger.
- Do not leave this product under high temperature conditions.**  
This product is a precision electronic device. Avoid using/keeping this product in a location that is subject to high temperature, high humidity or direct sunlight for many hours. When subject to significant temperature changes in the environment, this product may malfunction due to condensation inside the product.
- Do not touch the metal parts of this product such as the power supply connectors and the charging cable's connector terminals.**  
Static electricity or fouling may cause a malfunction or electric shock.
- Do not disassemble this product.**

Do not repair, modify or disassemble this product on your own, unless operational instructions to the contrary are given in this user's manual, Electric shock, fire, or burns may result.

- Make sure to close the watertight cap when using this product in a wet or damp environment.**  
Make sure to remove any dust, hair, etc., that is present between the watertight cap and the main unit.

- Follow the user's manual instructions of devices (ex. iPhones and mobile phones) to be connected to this product.**

This product can be wirelessly connected to iPhones, mobile phones, etc. The setting procedures and precautions are different depending on the devices to be connected to this product. Carefully read the user's manual for these devices and observe any precautions.

- Do not use/keep this product in a wet or damp environment for a long time if you do not use it.**  
Any liquid entering this product may result in danger, fire, or electric shock.

- Do not keep this product within reach of small children.**  
Unexpected accidents (ex. accidental ingestion) may result.

- This product is a precision electronic device. Avoid using/keeping this product in an environment that is subject to impact/vibration, strong magnetic forces, static electricity, etc.**

- Risk of explosion if battery is replaced by an incorrect type. Dispose of used batteries according to the instructions.**

#### FCC Requirement:

Warning: Changes or modifications to this unit not expressly approved by the party responsible for compliance could void the warranty.

**NOTE:** This equipment has been tested and found to comply with the limits for a Class B digital device, pursuant to Part 15 of the FCC Rules. These limits are designed to provide reasonable protection against harmful interference in a residential installation. This equipment generates, uses and can radiate radio frequency energy and, if not installed and used in accordance with the instructions, may cause harmful interference to radio communications.

However, there is no guarantee that interference will not occur in a particular installation. If this equipment does cause harmful interference to radio or television reception, which can be determined by turning the equipment off and on, the user is encouraged to try to correct the interference by one or more of the following measures:

- Reorient or relocate the receiving antenna.
- Increase the separation between the equipment and receiver.
- Connect the equipment into an outlet on a circuit different from that to which the receiver is connected.
- Consult the dealer or an experienced radio/TV technician for help.