

PYLE

PyleUSA.com



USER'S MANUAL

STEREO POWER AMPLIFIER

PCA2

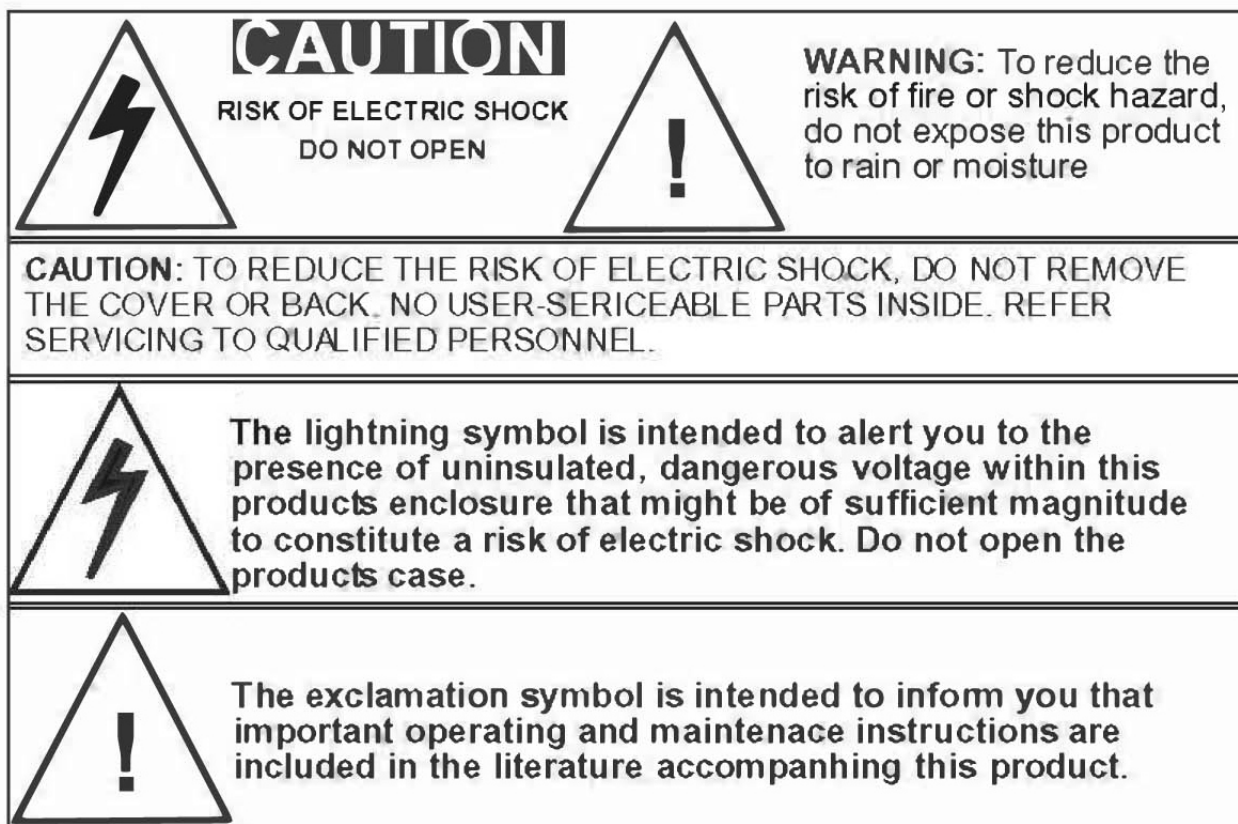

CONTROLS

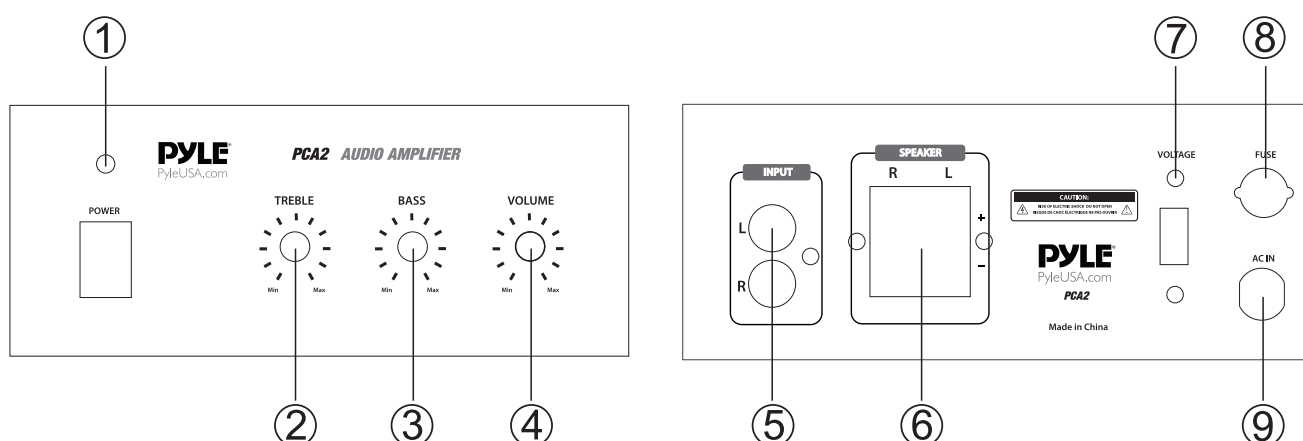

1. Power ON LED Indicator: Lights to indicate power is turned ON.
2. Treble Tone Control: Lets you boost or attenuate treble for the desired sounds.
3. Bass Tone Control: Lets you boost or attenuate bass for the desired sound.
4. Master Volume Control: Lets you adjust the overall sound level.
5. RCA L/R LINE Input: Lets you connect the desired LINE input source.
6. Push Type Speaker L/R Terminals: Lets you easily connect speaker wires directly to the Amplifier.
7. Voltage Selector: Lets you select the voltage of AC power input source. The amplifier has selectable input voltage from 110V/60Hz which is the standard in USA and CANADA. You can also switch the input voltage to 230V/50Hz for EUROPEAN operation. Please make sure the switch is in the proper position before operating otherwise severe damage will result not covered by the warranty. Please also replace the fuse with proper rating in this situation (see the next instruction for the fuse rating).

PYLE

8. Fuse: The amplifier uses a fuse for protection against surges and short circuit. If the amplifier suddenly turns OFF and will not turn ON, check the fuse. If necessary, replace it with a 1-amp, 250V, fast-acting, 5 x 20mm fuse (not supplied).

9.AC IN
-AC Input

IMPORTANT

Replacing a fuse

This amplifier requires a fuse with proper rating for protection from power surges and short circuits. If the amplifier suddenly turns off or will not turn on, the fuse is may be blown.

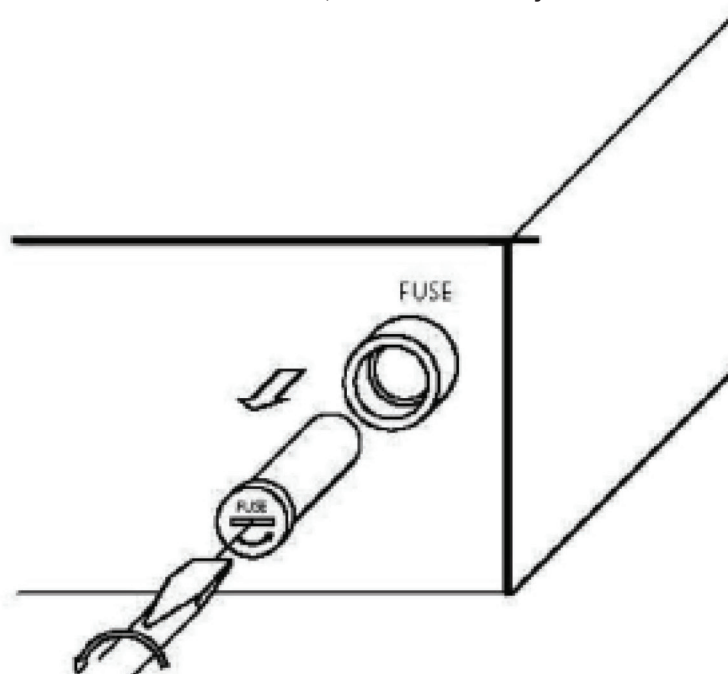

- Let the amplifier cool down and see if it start again before you assume the fuse to be replaced.
- Unplug the amplifier from the AC outlet.
- Turn the fuse holder cap and pull out the cap.
- Remove the old fuse and replace it with an identical one.

CAUTION: Never use a fuse with a higher rating.

Connecting two 4-8 ohm speakers in stereo mode

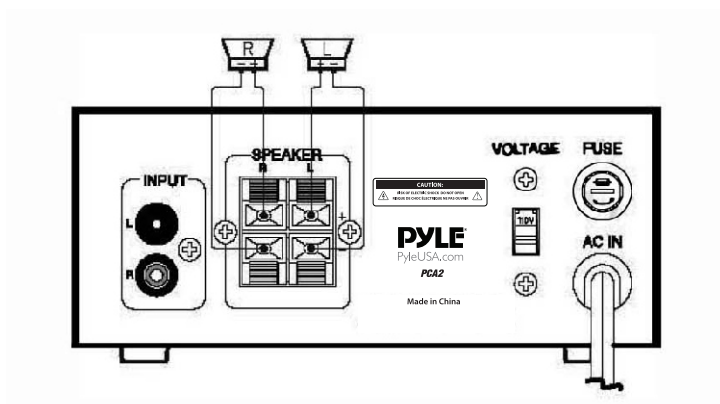

PYLE

TROUBLESHOOTING

No Power	The fuse might be blown	Check the amplifier's fuse and replace it if necessary.
No Sound	Sound source or speakers not connected properly.	Check all connections.
	MASTER volume control set to minimum.	Adjust the volume control to desired settings.
	The speaker's wire might be the wrong impedance.	Make sure all connected speakers have the same impedance rating,
	The amplifier might have shut down.	Turn the amplifier off and let it cool. Make sure the amplifier is properly ventilated, and then turn it back on.

STEREO POWER AMPLIFIER FEATURES AND SPECIFICATIONS

- Harmonic Distortion: 0.3%
- 2 x 40 Watt Peak at 4-Ohm
- Blue LED Output Level Display
- Frequency Response: 20Hz-40kHz
- Power Fuse: 1.5 A, 250V Fast-Acting (5 x 20mm)
- Power Requirement: 120V AC 50Hz/230V AC 50Hz
- Tone Controls: Bass & Treble: +/-10dB (100Hz/10kHz)
- Dimensions: 6.3"; W x 2.72"; D x 4.7"; H (190 x 70 x 137mm)
- Sold as: Unit
- Weight: 3.56 lbs.

