



Mini 2x15 Watt Stereo Power Amplifier USB/SD/MMC Card Reader w/AUX, CD & Microphone Inputs & Blue LED Display

PCAU15A



Mini 2x40 Watt Stereo Power Amplifier USB/SD/MMC Card Reader w/AUX, CD & Microphone Inputs & Blue LED Display

PCAU25A



IMPORTANT SAFETY INSTRUCTIONS

- 1. Read Instructions** — All the safety and operating instructions should be read before the appliance is operated.
- 2. Retain Instructions** — The safety and operating instructions should be retained for future reference.
- 3. Heed Warnings** — All warnings on the appliance and in the operating instructions should be adhered to.
- 4. Follow Instructions** — All operating and use instructions should be followed.
- 5. Water and Moisture** — The appliance should not be used near water -for example, near a bathtub, washbowl, kitchen sink, laundry tub, swimming pool, or a wet basement.
- 6. Ventilation** — The appliance should be situated so that its location or position does not interfere with its proper ventilation. For example, the appliance should not be situated on a bed, sofa, rug, or similar surface that may block the ventilation openings; or placed in a built-in installation, such as a bookcase or cabinet that may impede the flow of air through the ventilation openings.
- 7. Heat** — The appliance should be situated away from heat sources such as radiators, heat registers, stoves, or other appliances (including amplifiers) that produce heat.
- 8. Power Sources** — The appliance should be connected to a power supply only of the type described in the operating instructions or as marked on the appliance.
- 9. Grounding or Polarization** — Precaution should be taken to insure that the grounding or polarization means of an appliance is not defeated.
- 10. Power-Cord Protection** — Power supply cords should be routed so that they are not likely to be walked on or pinched by items placed upon or against them, paying particular attention to cords at plugs, convenience receptacles, and the point at which they exit from the appliance.
- 11. Cleaning** — The appliance should be cleaned only as recommended by the manufacturer.
- 12. Power Lines** — An outside antenna system should not be located in the vicinity of overhead power lines or other electric light or power circuits, or where it can fall into such power lines or circuits. When installing an outside antenna system, extreme care should be taken to keep from touching such power lines or circuits as contact with them might be fatal.
- 13. Nonuse Periods** — The power cord of the appliance should be unplugged from the outlet when the appliance is to be left unused for a long period of time.
- 14. Object and Liquid Entry** — Care should be taken so that objects do not fall and liquids are not spilled into the enclosure through openings.
- 15. Carts and Stands** — If the appliance is used with a cart or stand, the cart or stand should be a type recommended by the manufacturer.
An appliance and cart combination should be moved with care. Quick stops, excessive force, and uneven surfaces cause the appliance and cart combination to overturn.
- 16. Mounting** — The appliance should be mounted only as recommended by the manufacturer.
- 17. Damage Requiring Service** — The appliance should be serviced by qualified service personnel when:
 - A. The power-supply cord or plug has been damaged.
 - B. Objects have fallen into, or liquid has been spilled into the appliance enclosure.
 - C. The appliance has been exposed to rain.
 - D. The appliance has been dropped, or the enclosure damaged.
 - E. The appliance does not appear to operate normally or exhibits a marked change in performance.
- 18. Servicing** — The user should not attempt to service the appliance beyond that described in the user's operating instructions. All other servicing should be referred to qualified personnel.
- 19. Overloading** — Do not overload wall outlets and extension cords as this can result in a risk of fire or electric shock.
- 20. Replacement Parts** — When replacement parts are required, be sure the service technician has used replacement parts specified by the manufacturer or have the same characteristics as the original part. Unauthorized substitutions may result in fire, electric shock or other hazards.
- 21. Safety Check** — Upon completion of any service or repairs to this appliance, ask the service technician to perform safety checks to determine that the appliance is in proper operating condition.



Features and Controls

PCAU15A

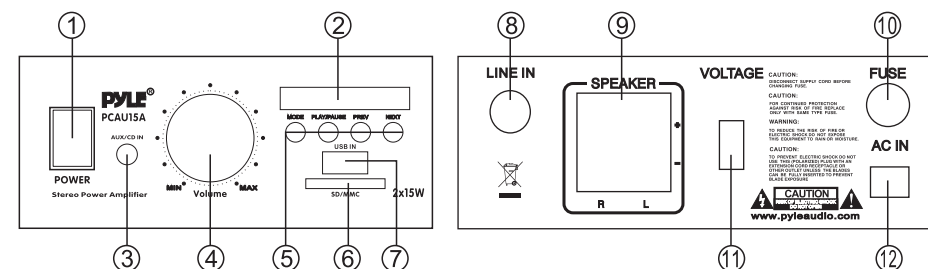

- 1. Power ON LED Indicator**
— Lights to indicate power is turned on.
- 2. Function Blue LED Display Window**
- 3. AUX/CD IN**
— Lets you easily connect the computerized MP3 Device (player) sources, such as PC (CD ROM), laptop, walkman, iPod, and cell phone.
- 4. Master Volume Control**
— Lets you adjust the overall sound level, turn the knob clockwise to increase the volume.
- 5. Buttons for MP3 (USB/SD/MMC) Function Control**
— Mode: For audio input selection.
— Play/Pause: Play and pause control.
— Prev./Next: Quick backward or next song.
- 6. SD/MMC Socket for playing SD/MMC cards**
- 7. USB Socket for playing the USB function.**
- 8. RCA Cable LINE Input**
— Let you connect to the desired LINE input sources.
- 9. Push Type Speaker L/R Terminals**
— Let you easily connect the speakers' wires directly to the amplifier
- 10. Fuse**
— The amplifier uses a fuse for protection against surges and short circuit. If the amplifier suddenly turn off and will not turn on, check the fuse. If necessary, replace it with a 1-amp, 250-volt, fast-acting, 5x20mm fuse (not supplied)
- 11. 110V/220V Switch**
— According to power voltage, push this button to the correct station of the 110V or 220V.
- 12. AC IN Power Cord**
— Connect to AC 110V/60Hz or 220V/50Hz

Features and Controls

PCAU25A

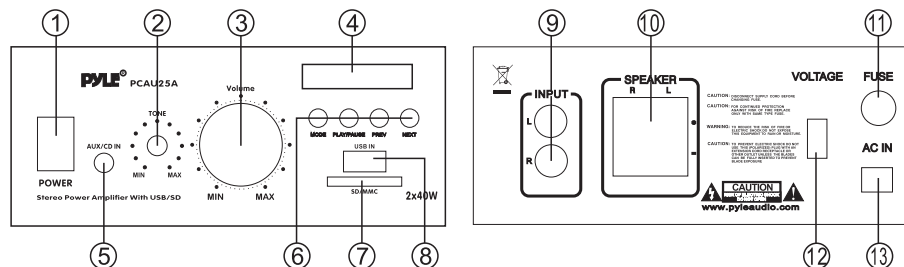

1. Power ON LED Indicator
-Lights to indicate power is turned on.
2. Tone
-Let you adjust the volume of the treble and bass.
3. Master Volume Control
-Lets you adjust the overall sound level, turn the knob clockwise to increase the volume.
4. Function Blue LED Display Window
5. AUX/CD IN
-Lets you easily connect the computerized MP3 Device (player) sources, such as PC (CD ROM), laptop, walkman, iPod, and cell phone.
6. Buttons for MP3 (USB/SD/MMC) Function Control
-Mode: For audio input selection.
-Play/Pause: Play and pause control.
-Prev./Next: Quick backward or next song.
7. SD/MMC Socket for playing SD/MMC cards
8. USB Socket for playing the USB function.
9. RCA L/R LINE Input
-Let you connect to the desired LINE input sources.
10. Push Type Speaker L/R Terminals
-Let you easily connect the speakers' wires directly to the amplifier
11. Fuse
-The amplifier uses a fuse for protection against surges and short circuit. If the amplifier suddenly turns off and will not turn on, check the fuse. If necessary, replace it with a 1-amp, 250-volt, fast-acting, 5x20mm fuse (not supplied)
12. 110V/220V Switch
-According to power voltage, push this button to the correct station of the 110V or 220V.
13. AC IN Power Cord
-Connect to AC 110V/60Hz or 220V/50Hz

Remote Control Function

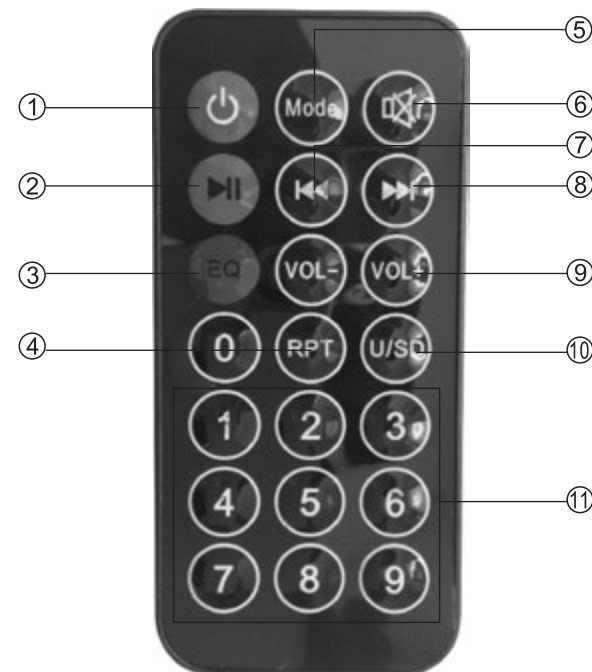

1. Power Standby Button
2. Play/Pause Button
3. Equalizer Button
4. Repeat Song Button
5. Mode: Menu Control Button
6. Mute Button
7. Previous Song Button
8. Next Song Button
9. Volume - & Volume + Buttons
10. USB/SD Switch Button
11. Number Buttons for Song Selection

Specifications

Output Power, 2 channels driven	
4-Ohm, 1 kHz, 1% THD	5Wx2(PCAU15A)
4-Ohm, 1 kHz, 1% THD	10Wx2(PCAU25A)
Max Power	40Wx2

Total Harmonic Distortion, 1 kHz Rated Power	0.3%
--	------

Input Sensitivity, 1 kHz, 4-Ohm Rated Power	
AUX 1	150mV
AUX 2	150mV
CD	150mV
USB	150mV
MIC	2.5mV

Frequency Response	20Hz-20kHz
--------------------------	------------

Signal to Noise Ratio, 1 kHz, 4-Ohm Rated Power	
AUX 1	80dB
AUX 2	80dB
CD	80dB
USB	80dB
MIC	70dB

Tone Controls	
BASS	+/-12dB, 100Hz
TREBLE	+/-12dB, 10kHz

Power Requirement	120V AC 60Hz/230V AC 50Hz
-------------------------	---------------------------

*Specifications are typical; individual units might vary.
Specifications are subject to change and improvement without notice.*

Limited warranty

All PYLE products are carefully constructed and tested before shipment. Units purchased in the USA are warranted to be free of defects in material and workmanship for one (1) year from the date of purchase. This warranty is limited to the original retail purchaser of the amplifier.

Should the unit fail due to factory defects in material or workmanship, your unit will be repaired or replaced at the sole discretion of PYLE.

To obtain warranty service, you must first call our Consumer Return Hotline at (718) 236-6948 to obtain a Return Authorization Number.

This R.A. # must appear on the outside of your package and on all paperwork relating to your return.

When returning the unit to us for warranty service, it must be carefully packed and shipped, prepaid, to:



R.A.#: _____

PYLE PRO Service Center

1600 63rd Street

Brooklyn, NY 11204

You must also include the following items with your return:

- A copy of your sales receipt or other proof of purchase
- A brief letter, indicating the problem you are experiencing with the product
- Include in your return address, daytime phone number and R.A. number
- Also include a check or money order for \$20.00 for return shipping, handling and insurance, or provide your Visa/ MC number with expiration date.

Our obligation under this warranty is limited to the repair or replacement of the defective unit when it is returned to us prepaid. This warranty will be considered void if the unit was tampered with, improperly serviced or subject to misuse, neglect or accidental damage.

SPECIFICATIONS

Output power, 2 channels driven	
4-OHM, 1 KHz, 1% THD.	5Wx2(PCAU15A)
4-OHM, 1 KHz, 1% THD.	10Wx2(PCAU25A)
Peak Power	40Wx2

Total Harmonic Distortion, 1 KHz Rated Power	0.3 %
--	-------

Input Sensitivity, 1 KHz, 4-ohm Rated Power	150mV
---	-------

Frequency Response	20Hz - 40KHz
Signal to Noise Ratio	75dB
Power Requirement	120V AC 60Hz or 230V AC 50Hz

Limited Warranty

All PYLE PRO products are carefully constructed and tested before shipment. Units purchased in the USA are warranted to be free of defects in material and workmanship for one (1) year from the date of purchase. This warranty is limited to the original retail purchaser of the amplifier.

Should the unit fail due to factory defects in material or workmanship, your unit will be repaired or replaced at the sole discretion of PYLE.

To obtain warranty service, you must first call our Consumer Return Hotline at (718) 236-6948 to obtain a Return Authorization Number. This R.A. # must appear on the outside of your package and on all paperwork relating to your return.

When returning the unit to us for warranty service, it must be carefully packed and shipped, prepaid, to:

R.A.#: _____
PYLE PRO Service Center
1600 63rd Street
Brooklyn, NY 11204

You must also include the following items with your return:

- A copy of your sales receipt or other proof of purchase
- A brief letter, indicating the problem you are experiencing with the product
- Include in your letter your return address, daytime phone number and R.A. number
- Also include a check or money order for \$20.00 for return shipping, handling and insurance, or provide your Visa/MC number with expiration date.

Our obligation under this warranty is limited to the repair or replacement of the defective unit when it is returned to us prepaid. This warranty will be considered void if the unit was tampered with, improperly serviced or subject to misuse, neglect or accidental damage.

▼ Please complete warranty card, detach and return ▼

Thank you for purchasing this PYLE product. To activate your warranty, please mail this card within 10 days.



warranty registration card

PYLE AMPLIFIER

Name _____

Address _____

City, State ZIP _____

Model No. _____ Serial # (if available) _____

Date of Purchase _____

Purchased at:

- ☐ Music Products Store ☐ Sound Contractor/Installer ☐ Mail Order
☐ Catalog Merchandiser ☐ Other _____

Care and Maintenance

Your Pyle Pro Amplifier is an example of superior design and craftsmanship. The following suggestions will help you care for your amplifier so you can enjoy years of use:

- Keep the amplifier dry. If it gets wet, wipe immediately.
- Use the amplifier only in well-ventilated installations.
- Handle the amplifier gently and carefully - do not drop!
- Keep the amplifier away from dust and dirt.
- Wipe occasionally with a damp cloth to keep it looking new.

Do not use harsh chemicals, solvents or detergents!

▼ Please complete warranty card, detach and return ▼

Place
Stamp
Here



PYLE PRO Audio, Inc.
1600 63rd Street
Brooklyn, NY 11204