

nutrichef
by **PYLE**



PKHNDMX32

Cordless Kitchen Mixer
3-Speed Hand Mixer
with Built-in Rechargeable Battery

USER MANUAL

SAVE THESE INSTRUCTIONS FOR HOUSEHOLD USE ONLY

In a safe and convenient as the main characteristics, there will be no space restriction in cordless, no longer worry about the safety of the electric shock accident and hand clamp.

• Parts Identification

1. Speed Button
2. Ejection Button
3. Charging Indicator lights
4. Cool System
5. Egg Whisk
6. USB Charging port

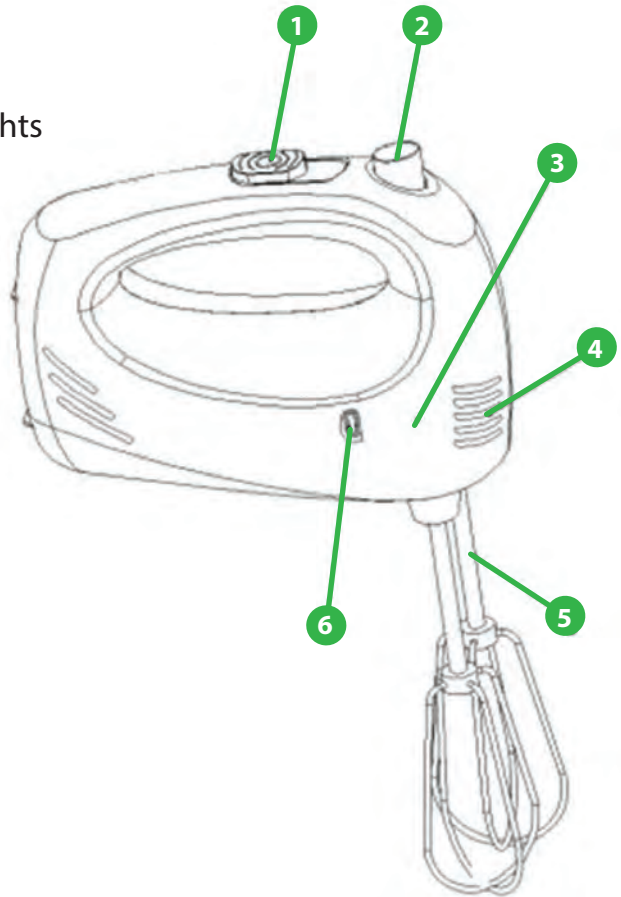

- **Features**

1. High capacity lithium battery, strong power, cordless and can be used anytime and anywhere.
2. Light and convenient and is quiet and easy to clean.
3. No longer worry about electrical shock. Use 5V power supply.
4. Clamp hand protection, dual protection design that always keep you safe.
5. Convenient to charge, can be charged by charge pal, mobile phone charger (samsung mobile phone charging port).
6. **400 ~ 650 RPM** speed regulating breakthrough the traditional egg beater speed regulating disadvantages .
7. Comfortable and humanized design **ON & OFF** Switch.
8. 3 Operation Speeds
9. Can be stored upright or lay on the side.
10. Can be stored conveniently in a rack with the accessories (optional)

- **Product Configuration**

Item	Accessory					
	Egg whisk	USB Cable	Charger	Storage bag	Egg beater	Dough hook
PKHNDMX32	YES	YES	Optional	Optional	Optional	Optional

- **Use, Storage, and Maintenance method**

1. Please check the electric power before use. The indicator light will flash in red when power is low.
2. Before use, clean the egg beater and install on the host.
3. When using, please adjust the speed from low to high, more than 1 second intervals every time, total of 3 speed.
4. Continuous work no more than 4 minutes. After 4 minutes let it cool down for more than 5 minutes.

5. Press <**Ejection button**> after use and clean the hand mixer. Prohibit use organic solvent to clean the plastic body such as alcohol.
6. When **Charging**, the indicator shows red. When fully charged, the indicator shows green. This hand mixer supports charging while using.
7. Ensure the switch in **OFF** state when storage.
Storage/use ambient temperature: **32 ~ 131°F**.
8. It can be stored and reach 6 months with a fully charged state
9. Keep the Storage space dry, avoid the electronic board going rust.
Avoid direct sunlight.
10. Do not operate the appliance after appliance malfunctions or has been dropped or damaged in any manner. Return the appliance to the nearest authorized service center for examination, repair, or electrical or mechanical adjustment.
11. Dispose of the appliance at the end of its life span according to environmental consideration.

Note: *This product is only limited to 500g flour, it will automatically shut's off the power to protect the product once the flour is too much.*

- **Warning**

1. If the product falls into the water at room temperature, please pick it up at once and adjust the switch to **OFF**. Wipe the surface and place in a sunny /dry place for 24 hours or more, then turn **ON** the product to check if normal or not.
2. Recommended storage temperature environment is not more than 131°F
3. Have servicing performed by a qualified repair person using only identical replacement parts. This will ensure that the safety of the product is maintained.
4. Avoid contacting moving parts. Keep hands, hair, clothing, and other utensils away from whisks during operation to reduce the risk of injury to persons, and/or damage to the mixer.
5. Children should be supervised to ensure that they do not play with the appliance.
6. Household use only.
7. Egg beater can be used single/double
8. When fully charged, the using time will be different because of different ingredients and dosage .

• **Stirrer Function Description**

Item	Function	Example	Remark
Egg beaters	Suitable for large liquid ingredients	Egg, Cake, Steamed sponge cake	
Dough hooks	Mixing dough	Dough, Glue pudding, Baked bread, Cookies	

• **Common Problem Analysis**

Malfunction	Estimate the cause of the problem	Handling Method
Switch no reaction	1. Low battery 2. Starting protection (Hand clamp protection)	1. Charging 2. Adjust to "OFF" state, charging 1 second
Slow down	1. Low battery	1. Charging
	2. The load is too large	2. Lighten the load

Remark: After the above phenomenon analysis is still unable to troubleshoot, please contact the company maintenance station or dealer. Non-professional personnel are strictly prohibited dismantling the product.

• **Product Specification**

Voltage	Speed	Power	Noise	Charging time (2A Charger)
5V≤2A	3 Speed	≤100W	<65db	<5.5 hours

nutrichef

by **PYLE**



VISIT US ONLINE:

Have a question?

Need service or repair?

Want to leave a comment?

PyleUSA.com/ContactUs

PYLE