

***PKMFR14***



**2-in-1 Electric Milk Frother & Milk Warmer**  
**USER MANUAL**

## READ AND SAVE THESE INSTRUCTIONS

### IMPORTANT

Read and follow the instructions in this user manual even if you feel you are familiar with the product, and find a place to keep it handy for future reference.

For your convenience record the complete model number (located on the product identification plate) and the date you received the product, together with your purchase receipt and attach to the warranty and service information. Retain in the event that warranty service is required.

**NOTE:** The rating of this product (as marked on the product identification plate) is based on specific loading tests. Normal use or the use of other recommended attachments may draw significantly less power.

### IMPORTANT SAFEGUARDS

When using any electrically powered product, basic safety precautions should always be followed, including the following:

### PLEASE READ ALL INSTRUCTIONS CAREFULLY BEFORE USING THIS PRODUCT

#### WARNING:

#### To reduce the risk of fire ,electrical shock or injury to persons or property:

- Carefully read all instructions before operating your new product for the first time and save for future reference.
- Remove and safely discard any packaging material and promotional labels before using the Milk Frother for the first time.
- To eliminate a choking hazard for young children, remove and safely discard the protective cover fitted to the plug of this appliance.
- Ensure the Milk Frother is properly assembled before use.  
Follow the instructions provided in this manual.
- Do not place the Milk Frother near the edge of a bench or table during operation. Ensure the power cord does not hang over the edge of the bench or table, touch hot surfaces or become knotted.
- Do not place the Milk Frother on or near a hot gas or electric burner, or where it could touch a heated Oven.
- This Milk Frother is not intended to be operated by means of an external timer or separate remote control system.
- Do not operate on a sink or drain board or polished wood surfaces.
- Ensure the appliance is operated on a clean, dry and level surface.
- This Milk Frother has been designed to heat and froth dairy milk and other milk alternatives. It is not intended to thicken or heat other food substances like cream, custard, gravies, water etc.
- This appliance is not designed for commercial or industrial use.

- Use cautiously when pouring warmed milk from the Milk Frother as hot milk can scald.
- Do not operate the appliance without liquid. Always fill to at least the “Min” mark and never fill past the “Max” mark.
- This appliance is not intended for use by persons (including children) with reduced physical, sensory or mental capabilities, or lack of experience and knowledge, unless they have been given supervision or instruction concerning use of the appliance by a person responsible for their safety.
- Children should be supervised to ensure they do not play with the appliance.
- This appliance is for household use only. Do not use this appliance for anything other than its intended use. Do not use in moving vehicles or boats. Do not use outdoors. Misuse may cause injury.
- The installation of a residual current device (safety switch) is recommended to provide additional safety protection when using electrical appliances. It is advisable that a safety switch with a rated residual operating current not exceeding 30mA be installed in the electrical circuit supplying the appliance. See your electrician for professional advice.
- This appliance contains no user serviceable parts. Any maintenance other than cleaning should be performed by a qualified person.
- Do not immerse unit, power plug or power cord in water, or any other liquid.
- Never operate any appliance with a damaged power cord or plug, should the appliance malfunction, or if it has been damaged in any manner.
- Do not leave the appliance unattended whilst it is on.

### FEATURE:

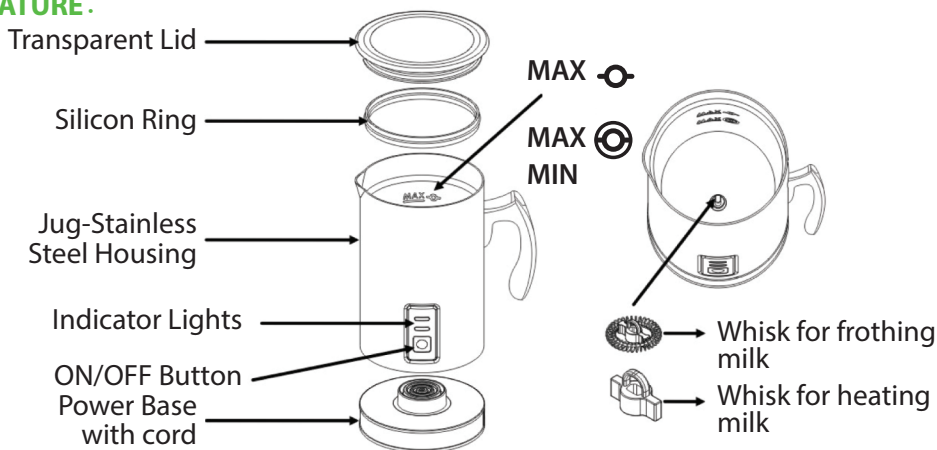

### BEFORE FIRST USE

- Carefully remove your Milk Frother from the box and remove any packaging materials.
- Clean the jug and accessories, as described in this manual, before first use.
- Fully unwind the power cord.

## INSTRUCTIONS

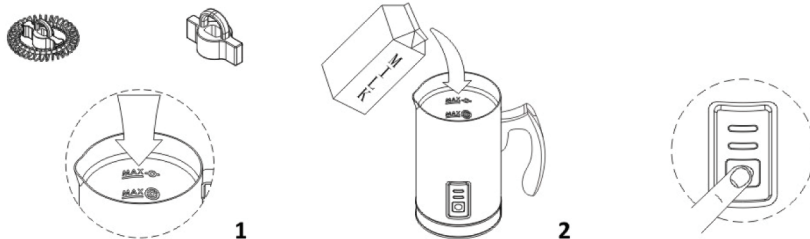

1. Place the Milk Frother on a flat, level surface. Choose the appropriate whisk, and insert it firmly onto the shaft at the base of the jug.
2. Pour the milk into the jug according to the max & min mark inside the jug. Max capacity chart is below for your reference.
3. Place the lid firmly onto the jug, then press the button to turn on.

Whisk	Function	Max capacity	Time(approx)
	Frothing Cold Milk	115ml	100 seconds
	Frothing & Heating	115ml	100 seconds
	Heating(a small amount of froth)	240ml	100 seconds

1. **Frothing & Heating Milk/ Heating Milk:** Press the On/Off button to start .The blue and red indicator lights will illuminate to show that the unit is in operation. The blue light will turn off after the cycle has finished. The red light will start to flash for 30 seconds.
2. **Frothing the cold milk:** Press and hold the On/Off button for a further 1-2 seconds to switch cycles, only the blue light will remain on. The blue light will illuminate and start to flash for 30 seconds.

## HANDY HINTS:

- To protect the electric cuicuit, it has been set up that users need to wait for 3 seconds to turn on the appliance after the current is switched on.
- Always use the Milk Frother first to froth/heat your milk. While it is operating, prepare your coffee or hot chocolate.
- Use whole milk for best results-fat content>3.0%
- Milk heats to approximately 65°C+/-5°C (149°F+/-41°F). This is the ideal temperature, as it ensures the flavour of the coffee is not impaired and it also means you do not have to wait as long to drink your coffee.
- Keep the whisks in a safe place, because they are small they can be easily misplaced.

- After each froth/heat wait 2 minutes to allow the thermostat to rest. After 2 minutes the Milk Frother can be used again. To shorten this time, rinse with cold water and wipe dry after each use.
- This Milk Frother is designed to heat plain milk only.

## RECIPES

### Frothed Milk

#### Cappuccino

1/3 espresso  
Add 2/3 frothed milk  
Top with cocoa powder

#### Latte Macchiato

Pour frothed milk in a tall glass  
Add espresso carefully  
along the rim of the glass

#### Instant Frothy Coffee

Make an instant coffee  
Add frothed milk

### Hot Milk

#### Cafe Latte

1/3 espresso shot  
Add 2/3 heated milk and stir

#### Hot Chocolate

Pour heated milk into a large  
mug. Add chocolate powder  
and stir to mix

#### Instant Milky Coffee

Place instant coffee in a Cup/mug  
Add hot milk and stir to mix

## CLEANING

1. Do not remove the connector of whisk when cleaning the appliance, otherwise the milk foam will be not good enough.
2. Remove the jug from the power base.
3. Separate the lid and the silicon ring from the jug.
4. Flush and clean the jug with warm soapy water.  
This should be done immediately after each use.
5. Rinse the lid and silicon ring in warm water. Wash in soapy water if necessary.
6. Clean the jug body with a soft damp cloth. NEVER use harsh cleaning agents or abrasive materials
7. Wash the whisks in warm soapy water and dry thoroughly. Store in a safe place.

**NOTE:** The Milk Frother or any of its accessories are NOT dishwasher safe.

## TROUBLESHOOTING

Item	Issue	Reason	Solution
1	Indicator light doesn't work/jug doesn't work	Plug is not inserted properly	Re-insert plug
		Jug isn't connected to power base properly	Remove jug and replace correctly
		No power in the jack	Check the electric circuit
		Problem with components	Repair or replace
2	Jug doesn't work after operation	Jug temperature is too high	Rinse cold water inside the jug to reduce temperature
		Jug is damaged with immersion in water	Repair or replace
3	Motor doesn't work	Jug not cleaned in good time after use, milk locks the mechanism.	Clean and move the shaft sleeve of motor by hand to loosen it.
		Motor damaged	Repair or replace
4	No heating	Machine is damaged	Repair or replace
5	Charring	Dosage of milk either too little or too much	Ensure the milk is over the min mark, and not pass max mark
		Jug was reused without cleaning/rinsing	Always clean after each use
		Actual voltage is much lower than specified voltage	Ensure you use the appropriate voltage

## DISPOSAL



Please dispose of the packaging according to your local waste regulations. Cardboard and paper go to "recovered paper", foil goes to resource collection (Potential recyclable). This product should never be disposed of in normal household waste at the end of its service life. It must be delivered to a collection point for the recycling of electrical and electronic goods. This is indicated by the symbol (dustbin with cross) on the product, in the instruction manual or on the packaging. Ask your local disposal point about disposal. The materials are reusable according to their labeling. In the reuse, material recycling or other forms of using old appliances, you are making an important contribution in protecting our environment. Please ask your local government for a suitable disposal point (old appliance collection point of municipal disposal point). This way you are disposing of your appliance ecologically.

## PKMFR14

### 2-in-1 Electric Milk Frother & Milk Warmer

#### Features:

- Dual Electric Milk Frother & Warmer
- Froths Cold Milk for Iced Drinks
- Simple One-Button Operation
- Easy Pour Spout and Handle
- Detachable Kettle Lifts from Base
- Built-in Safety: Automatic Power Off Function
- Sleek & Compact Design
- LED Indicator Light
- Safe for Placement on Any Kitchen Table & Countertop

#### What's in the Box:

- Kettle Container with Lid
- Froth Attachment
- Whisk Attachment
- Heating Plate Base

#### Technical Specs:

- Heating Element: 500 Watt
- Construction Material: Stainless Steel
- Milk Froth Capacity: 115mL Max.
- Hot Milk Capacity: 240mL Max.
- Power Cord Length: 2.5' ft.
- Power: 120V
- Dimensions (L x W x H): 6.3" x 4.3" x 7.3" -inches



nutrichef

