

# PKPRCFMAK2

## Mini Portable Electric Espresso Machine

User Manual



**Mini Espresso Machine is a portable espresso machine to enjoy anytime, anywhere.**

**⚠️ WARNING:**

**Please read these instructions carefully before using this product.**

**Proper precautions must be taken to prevent the risk of burns, fires, or other injury to persons or damage to property.**

- For personal use only.
- Make sure the product is complete and undamaged before using the machine
- Do not let children touch or play the appliance or such as the plastic bag.
- Do not let children play and operate this machine.
- Do not drink directly from the machine to avoid scalding.

- Please do not place on gas, electrical oven, microwave oven or dish-washing machine.
- Only add pure water, do not add other liquid such as milk.
- Do not heat the water tank. Boil the water at first, then pour the hot water to the tank.
- Clean the machine carefully and regularly.
- This warranty does not cover damages caused by alteration of parts, removal of parts, or any installation of parts not manufactured or sold by Nutrichef
- Please do not continue to use if there's malfunction.
- Do not attempt to self-service the appliance. If damaged, it must be repaired by the manufacturer, its service agent or similarly qualified persons in order to avoid a hazard.

## DESCRIPTION

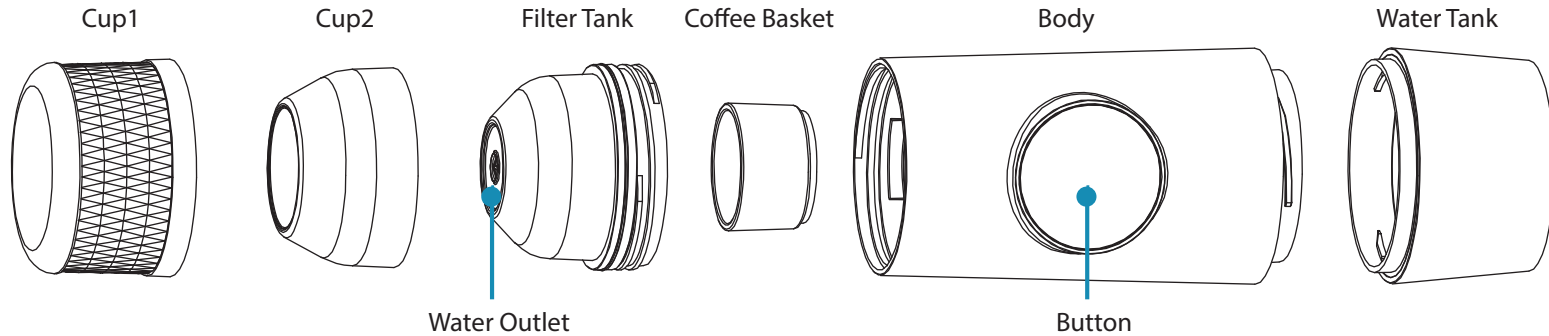

## INSTRUCTIONS



1. Open the cup



2. Open the water outlet

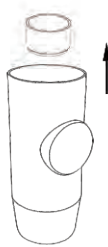

3. Take out the coffee basket

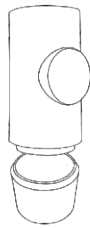

4. Open the water tank

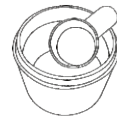

5. Take out the measuring spoon.



6. Serve a full cup of coffee

## INSTRUCTIONS



7. Pour the coffee basket on the spoon



8. Flip the coffee ground to the coffee basket and press it tightly with a spoon



9. Make sure the coffee ground is on the edge of the coffee basket

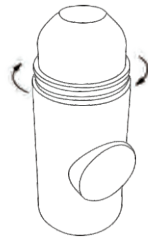

10. Put the coffee basket back to the machine and the clean residue.



11. Close the water outlet



12. Carefully tighten the water tank to the main body.

## INSTRUCTIONS

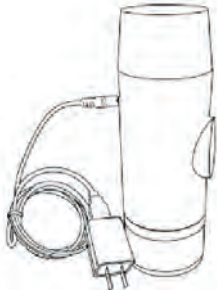

13. Plug in

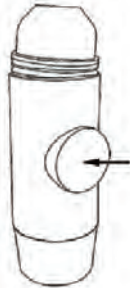

14. Press the button



15. Release the button  
when there is no  
coffee runoff

## NOTE:

To get best coffee results we suggest:

- Use fresh filtered water
- Re-heat the spareparts before using the machine

**Three ways of power supply:**

5V / 1.2A adapter, powerbank or USB car plug

**⚠ WARNING:**

**TO AVOID SCALDING BE EXTRA CAREFUL WHILE OPERATING THE MACHINE**

## CLEANING

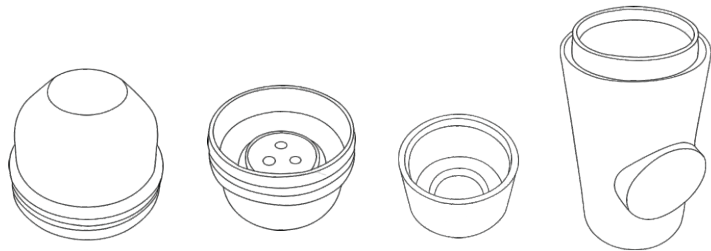

Clean the parts of the machine and remove the coffee residue.  
Use damp soft cloth to wipe the parts of the machine.

## ⚠ WARNING:

- DO NOT LET WATER INTO COLORED AREA, TO AVOID WATER SEEPAGE.
- DO NOT USE DISH-WASHING MACHINE FOR CLEANING ANY SPARE PARTS.

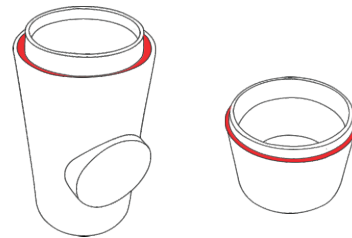

## SAFETY APPROVAL

All Mini Espresso machine have been tested by the food safety approval



## ENVIRONMENTAL PROTECTION

The package and parts are all recyclable



## DISPOSAL

Mini Espresso machines are made by high quality materials. Please dispose properly in recycle garbage.



**VISIT US ONLINE:**

*Have a question?*

*Need service or repair?*

*Want to leave a comment?*

**[PyleUSA.com/ContactUs](http://PyleUSA.com/ContactUs)**

**PYLE**