

# PYLE

PyleUSA.com



**VISIT US ONLINE:**

*Have a question?*

*Need service or repair?*

*Want to leave a comment?*

[PyleUSA.com/ContactUs](http://PyleUSA.com/ContactUs)

PYLE

### ***Questions? Issues?***

We are here to help!

Phone: (1) 718-535-1800

Email: [support@pyleusa.com](mailto:support@pyleusa.com)

# PYLE

PyleUSA.com



### ***PLMRBT33WT - PLMRBT33BK - PLMRBT33CR*** **3.5" 2 Pcs. Waterproof Rated Off-Road Speakers**

Compact PowerSport Vehicle Speaker System  
for Motorcycle or Car with RGB Lights and Remote Control

**USER GUIDE**

## Features:

- Motorcycle Box Waterproof Stereo System
- 3.5" Long Excursion Woofer
- Completely Waterproof
- Wireless BT Music Streaming
- Compact & High-Powered Output
- Marine Grade Waterproof Rated Construction
- Weatherproof & Water-Resistant Housing
- Full Range Stereo Sound Reproduction
- Impressive Bass Response
- Sleek Design, Machine Molded Speaker Cabinet Housing
- Rugged, Universal Mount Bracket Design for Roll-Bar / Roll-Cage
- Used for Off-Road Outdoor Vehicles: ATV, UTV, 4x4, Jeeps, Marine Watercraft
- Quick Butt Connector for Speaker Wiring

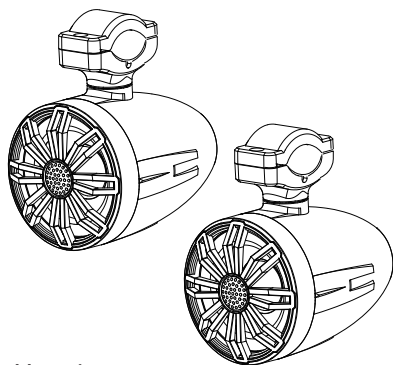

## Mounting Bracket

### Mounting screws

Two types of mounting screws are provided to accommodate most mounting pole diameters.

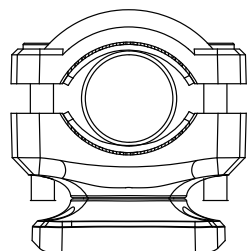
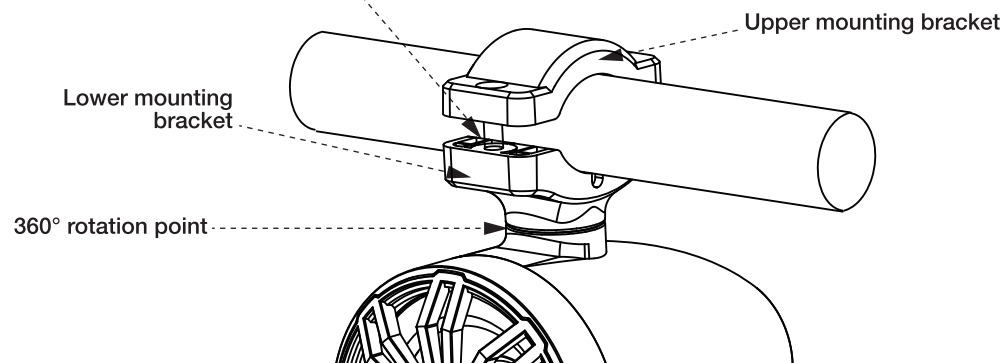

Min: 0.83in/21mm

For diameters ranging  
from 0.83 to 1.57 inches,  
use the 35mm screws.

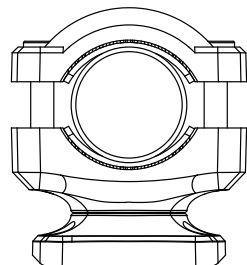

Max: 1.57in/40mm

## 360° Rotation Function

1. Loosen the rotation adjustment screw.
2. Rotate the lower mounting bracket to the desired position.
3. Lock the rotation adjustment screw.

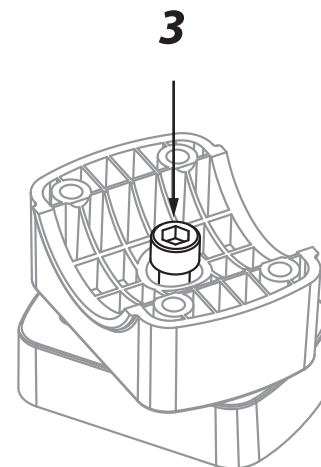
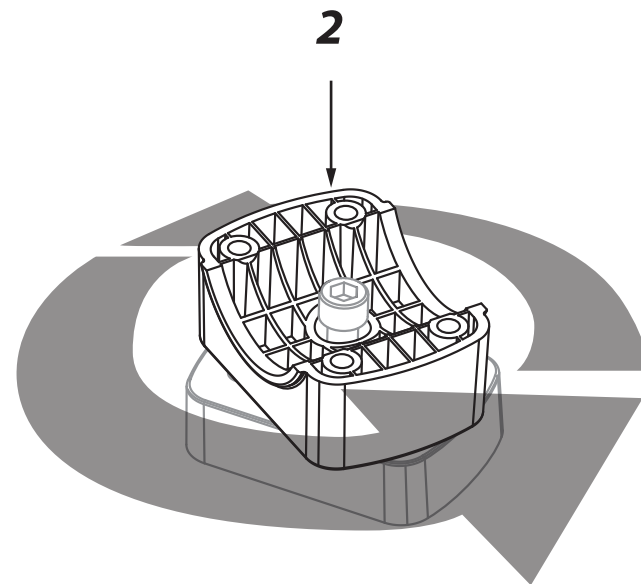
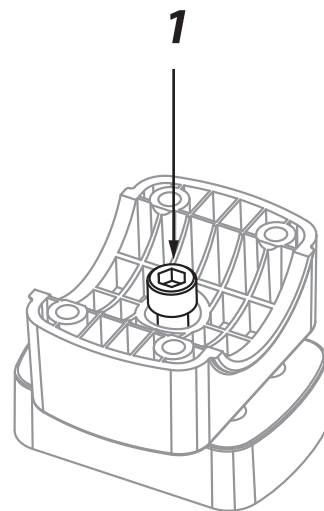

## Remote Control

### 1. Turn ON/Standby:

Press this key to turn ON unit or switch to stand by mode. At power ON, unit will automatically turn ON and restore to previous status.

### 2/9. Dynamic Mode Adjust:

Switch to dynamic mode from static color, or switch between dynamic modes.

### 3/10. Dynamic Speed Adjust:

Adjust dynamic playing speed Press **SPEED +** to increase speed and press **SPEED -** to decrease Unit will switch to dynamic mode if press this key at static color mode.

### 4/5. Static Color Adjust:

Switch to static color mode from dynamic mode, or switch between static colors.

### 6. Direct Color Select:

Shortcut key to static colors. When press the specific color key, LED will play the same static color. The direct colors are included in '**COLOR +**' and '**COLOR -**' operation.

### 7/8. Brightness Adjust:

Adjust static color brightness. Press **BRIGHT +** to increase brightness and press **BRIGHT -** to decrease Unit will switch to static color mode If press this key at dynamic mode.

### 11. Demo Mode:

Press this key will switch to Demo mode. At demo mode, it plays 17 dynamic modes in loop, each mode repeat 3 times.

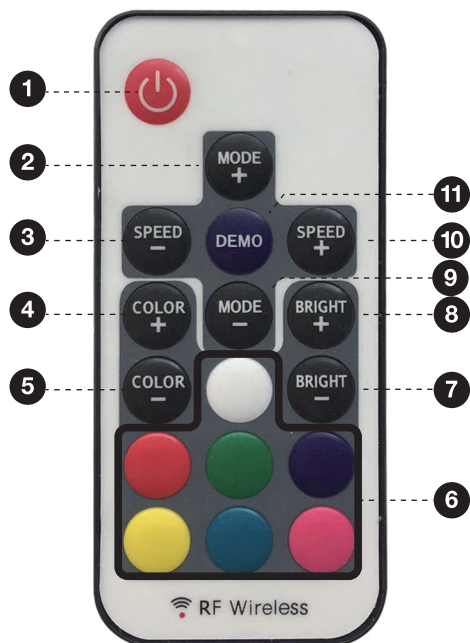

- 22 Dynamic Modes
- Card Type RF Remote
- 20 Static Colors
- Ultra Slim Design
- Very Smooth Effects
- Dynamic Demo Mode
- Speed Adjustable
- Easy Remote Pairing
- Brightness Adjustable
- Direct Color Select

## Installation Guide

1. Speaker and RGB power + (red), (DC12V)
2. Speaker and RGB power - (black), (DC12V)
3. Connect to each other (Speaker and RGB wires)

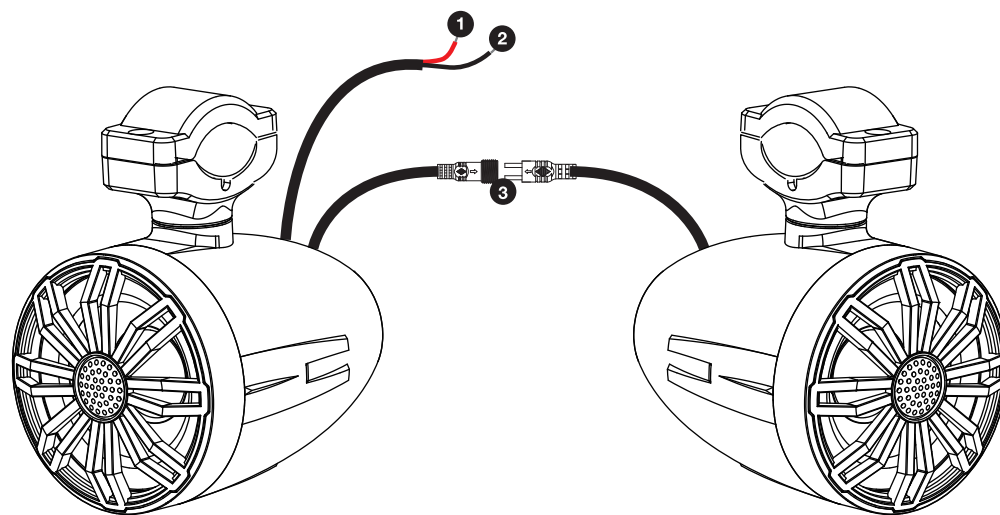

### California Prop 65 Warning

#### ⚠ WARNING:

This product contains Nickel carbonate which is known to the state of California to cause cancer birth defects and other reproductive harm. Do not ingest.

For more info go to: [www.P65warnings.ca.gov](http://www.P65warnings.ca.gov)