

# PLMRCB3 Universal Marine Stereo Housing with Full Chassis Wired Casing (Black)

**PYLE**  
PyleUSA.com

## User Manual

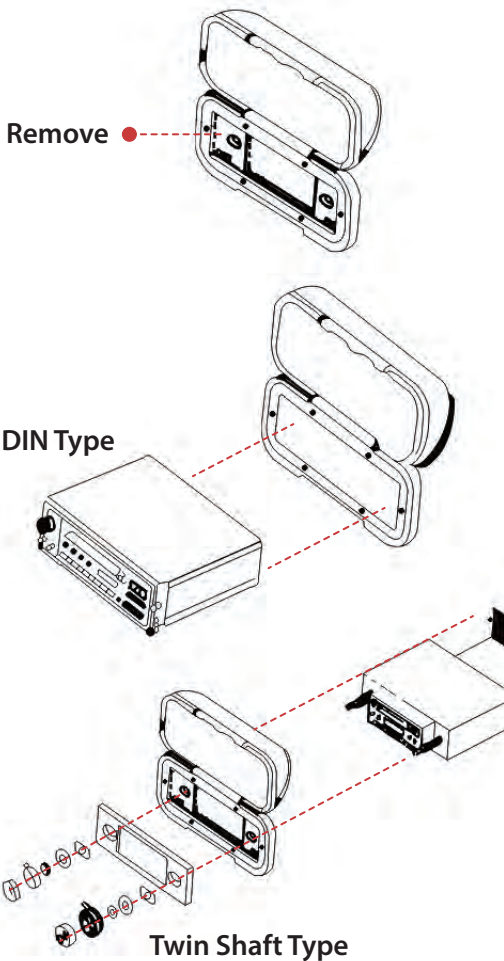

Remove

DIN Type

Twin Shaft Type



**VISIT US ONLINE:**

Have a question?

Need service or repair?

Want to leave a comment?

[PyleUSA.com/ContactUs](http://PyleUSA.com/ContactUs)

**PYLE**

**EASY TO ACCESS:** It boasts a flip-up door and a simple spring release mechanism for easier use. Switching channels or adjusting the volume is easy; you can either use the head unit's remote or remove the cover to make any changes

**SMOKE COLORED HOUSING:** This durable marine stereo cover has a tinted front panel, so you can still see the controls. It also comes with a UV-resistant housing to keep it from getting overheated

**SUPPORT SHELF FOR RADIO:** The marine stereo/CD player comes with a strong stainless steel mounting for sufficient rigidity. This housing is compatible with dual shaft and DIN size receivers

**DURABLE RADIO COVER:** This universal marine radio cover comes with wires for easy deck or overhead installation. It is also made of heavy duty material to make sure it can be used for a long period of time.

**Universal Marine Stereo Housing:** Fits Din Style or Removable Stereos - Pre-Wired Power (3 Wire), Speaker (8 Wire), RCA (2 Wire), Antenna

### ***Features:***

- Universal Marine Stereo Housing
- Protect your Stereo from Harsh Marine Environment
- Includes a 2 Position Hinged Front Door
- Sealed with a Neoprene Gasket
- Accommodate Dual Post/ Removable & DIN Style Stereos
- Fits Din Style or Removable Stereos
- U shaped Mounting Bracket for Deck or Overhead Installation
- Stainless Steel Mounting Hardware
- Polycarbonate Bracket
- Support Shelf for Radio in Rear of Housing
- Pre-Wired Power(3 Wire), Speaker (8 Wire), RCA (2 Wire), Antenna
- UV Resistant Plastic
- Dimensions: 4.3"(H) x 9.4"(W)x 10.6"(D)

### ***Questions? Issues?***

We are here to help!

Phone: (1) 718-535-1800

Email: [support@pyleusa.com](mailto:support@pyleusa.com)