

**PYLE**  
PyleUSA.com



VISIT US ONLINE:  
Have a question?  
Need service or repair?  
Want to leave a comment?  
[PyleUSA.com/ContactUs](http://PyleUSA.com/ContactUs)

**PYLE**

**Questions? Issues?**

We are here to help!

Phone: (1) 718-535-1800

Email: [support@pyleusa.com](mailto:support@pyleusa.com)



**PMX3500PH**

**Wireless BT Home/PA Mixing Amplifier**

Built-in USB Playback, Micro SD Card Reader,  
with BT/FM/Optical/Coaxial/Mic Inputs  
& Digital LED Display, 500 Watts

## Front and Back Panel

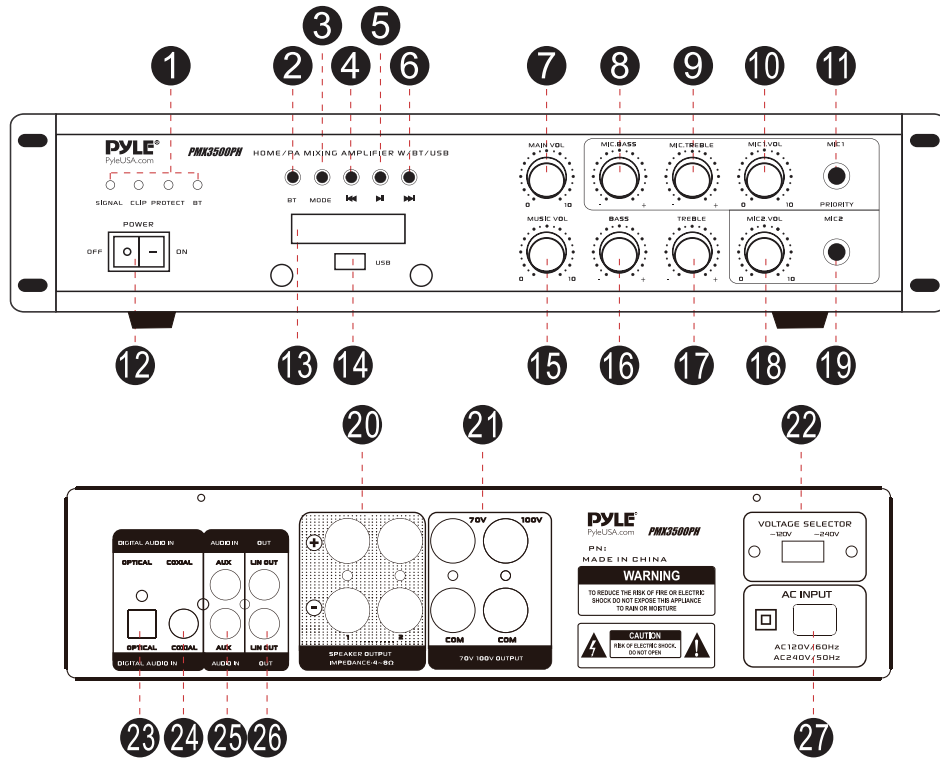

- |                                       |                                |
|---------------------------------------|--------------------------------|
| 1. Signal/Clip/Protect/BT indicator   | 15. Master Volume Control      |
| 2. BT-Press this key to enter BT Mode | 16. Bass Volume Control        |
| 3. Input Selector                     | 17. Treble Volume Control      |
| 4. Previous Song/Previous Station     | 18. Mic1 Volume Control        |
| 5. Play/Pause                         | 19. Mic 2 Input                |
| 6. Next Song/Next Station             | 20. Speaker Output             |
| 7. Main Volume Control                | 21. 70V/100V Output            |
| 8. Mic Bass Volume Control            | 22. 120V/240V Voltage Selector |
| 9. Mic Treble Volume Control          | 23. Optical Input              |
| 10. Mic1 Volume Control               | 24. Coaxial Input              |
| 11. Mic 1 Input                       | 25. Aux Input                  |
| 12. Power ON/OFF Switch               | 26. Lin Output                 |
| 13. LED Digital Display               | 27. AC 120V/240V Input         |
| 14. USB Reader                        |                                |

## Remote Control Functions

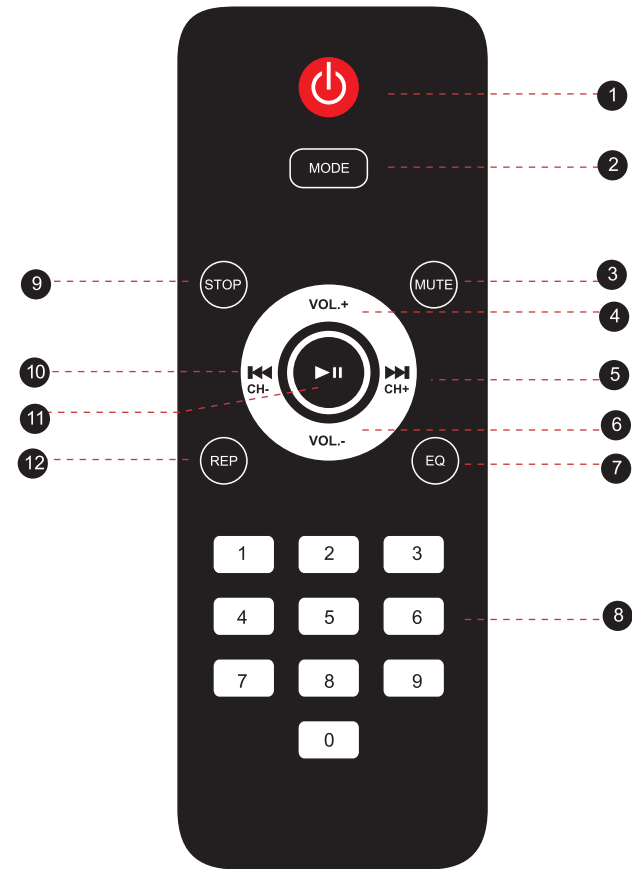

1. USB/SD Standby/ON key
2. USB/SD/DVD mode
3. Mute button
4. **Master Volume + button:** Increases volume level
5. **Next button:** Move forward through tracks from USB input
6. **Master Volume - button:** Decreases volume level.
7. Equalizer button
8. **Numeric key pad:** In USB mode, use to manually select tracks.
9. **Stop button:** Stops music playing from USB input
10. **Previous button:** Move back through tracks from USB input.
11. **Play/Pause button:** Play and pause music from USB input.
12. **Repeat button:** Repeats current track from USB Input

### **WIRELESS BT STREAMING OPERATION INSTRUCTION:**

External devices which have a built-in Wireless BT feature can be connected to this amplifier wirelessly to play through the amplifier's speakers. If your amp is connected to speakers, you will hear audible tones which will help for connecting.

1. Press the "BT" button located on the front panel and select "BT" mode.
2. Turn **ON** the Wireless BT of your external device.
3. Search for available BT devices and make sure to be within range of your amp, and wait for your device to select "Pyle Speaker" on the pairing devices lists of Wireless BT networks.
4. The unit is automatically ready to pair with your devices when you hear audible tones.
5. Now you can play music on your external device through the amplifier.

### **Features:**

- Wireless BT Streaming Ability
- Built-in USB Playback
- LED Display
- USB Flash Drive & SD Memory Card Readers
- Aux Input
- MP3/MIC/AC-3 Inputs
- Digital LED Display
- Microphone 1 and 2 Level Gain and Talk-over Control
- Microphone 1 Priority function
- Mic Talk-over Ability to Speak Over Audio, Karaoke Style
- Desktop Home/PA Mixing Power Amplifier
- Compact Home Theater-Stereo Receiver Style
- Built-in BT for Wireless Music Streaming
- Optical/Coaxial Digital Signal Inputs
- Aux Audio Input Selection
- MP3/WAV Audio Files Support
- Connect & Stream Audio from External Devices
- Front Panel Audio Control Center
- Treble, Bass, Master & Microphone Volume Adjustable

### **Wireless BT Connectivity:**

- Receives Wireless Signal for Audio Streaming
- Simple & Hassle-Free Pairing Setup
- Integrated Antenna for Extended Wireless Range
- Works with All of Today's Latest Devices (Smartphones, Tablets, Laptops, Computers, etc.)
- Wireless BT Version: 5.0
- Wireless BT Network Name: 'Pyle Speaker'
- Wireless Range: 40'+ Ft.

### **What's in the Box:**

- Desktop Stereo Amplifier
- Remote Control
- FM Antenna

### **Technical Specs:**

- Power Output: 500 Watts Peak Power
- Remote Control Battery: Need 2x 'AAA' Battery (not included)
- MAX Power Output: 50 Watt x2(@ 4 Ohm)
- RMS Power Output: 35 Watt x 2 (@ 4 Ohm)
- Tone Control: Bass, f=100Hz +/-12dB, Treble, f=10 KHz +/-12dB
- Tone Control for Mic: Bass, f=100Hz +/-8dB, Treble, f=10 KHz +/-8dB
- Frequency Response:50Hz-18 kHz
- Frequency Adjustment: +/-2dB
- Signal to Noise Ratio: >71dB
- T.H.D.: <1%
- Separation Degree: >45dB
- Radio Station Presets: Up to 40 Stations
- Power Supply: 120V/240V, Switchable
- Dimensions (L x W x H): 11.81" x 9.45" x 2.76" -inches



**WARNING:**

This product can expose you to a chemical or group of chemicals, which may include "Lead (PB)" which is known in the state of California to cause cancer, birth defects, or other reproductive harm. For more info, go to <https://www.p65warnings.ca.gov/>.