

Intelligent Vacuum Cleaner

C9

USER MANUAL

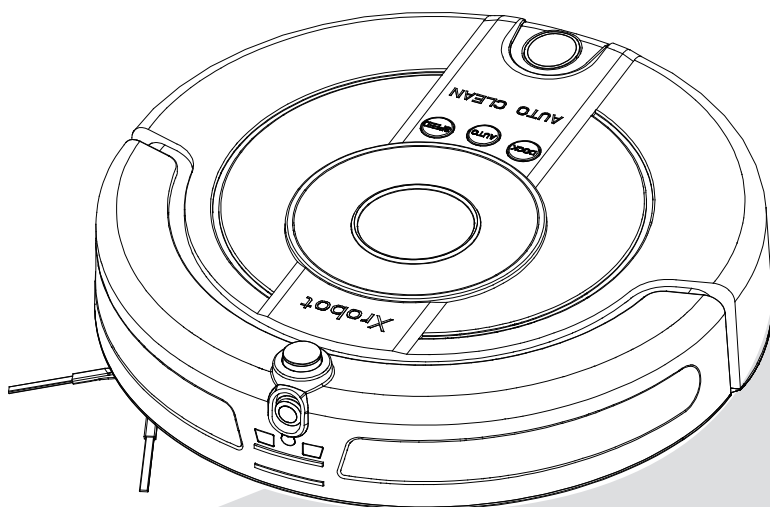

Thank you for purchasing the product.

Please read the manual carefully before using.

Warnings

- Instructions for use shall be provided with the appliance so that appliance can be used safely.
- The plug must be removed from the socket-outlet before cleaning or maintaining the appliance.
- This appliance can be used by children aged from 8 years and above and persons with reduced physical, sensory or mental capabilities or lack of experience and knowledge if they have been given supervision or instruction concerning use of the appliance in a safe way and understand the hazards involved. Children shall not play with the appliance. Cleaning and user maintenance shall not be made by children without supervision.
- Children should be supervised to ensure that they do not play with the appliance.
- Only to be used with the power supply unit provided with the appliance.
- This appliance is intended to be used in household only.

Contents

1. Safety Instruction.....	2-4	5. Product Maintenance.....	11-14
1.1 Use Notes		5.1 Daily Storage	
1.2 Safety Precautions		5.2 Clean the Main Body	
1.3 Child Safety		5.3 Clean the Dust Box	
1.4 About Battery		5.4 Clean the Filter	
1.5 Usable Range		5.5 Clean the Main Brush	
2. Product Formation.....	5-6	5.6 Clean the Side Brush	
2.1 Main Body and Accessories		5.7 Clean the Front Wheel	
2.2 Accessories Introduction		5.8 Clean the Right Wheel and Left Wheel	
3. Product Installation.....	7-8	5.9 Clean the Sensors	
3.1 Main Body		6. Common Faults.....	15
3.2 Charging Station		6.1 Alarm and Prompt Facility	
3.3 Installation of KV8 APP		6.2 Processing Methods	
4. Product Usage.....	9-11	7. Technical Parameters.....	16
4.1 Introduction of Work Mode		8. Operation guide (Android).....	17-29
4.2 Charging Station		9. Operation guide (IOS).....	30-42
4.3 Charging Methods			

Thanks for purchasing intelligent vacuum cleaner C9,
wish you have a happy experience.

1. Safety Instruction

1.1 Use Notes

Before using the product, please observe the following safety precautions:

- * Read the instruction carefully; use the product according to the operation procedures.
- * Keep the instruction carefully, and look it up in the future.
- * If you want to give the product to others, please enclose the instruction.
- * Wrong operation will lead to serious personal injury and damage the product.

1.2 Safety Precautions

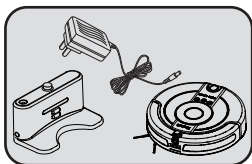

Caution

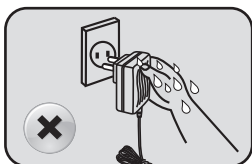

-  Only use the original adaptor, battery and charging station, or else it will damage the machine and cause fire because of electric shock and high voltage.

-  If you find that the main body and accessories are damaged, Please do not use the cleaner and keep contact with the after-service department. Anyone is not allowed to disassemble, maintenance or remould the machine.



-  Do not touch the battery socket and the machine when your hands are wet, or else it will cause electric shock.
-  Do not use the machine in the place without guard railing, or else it will damage the machine and cause personal injury.

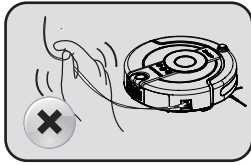

⚠ Do not remove the machine with power line, and do not twist, bend the wire or put heavy thing on the power line.

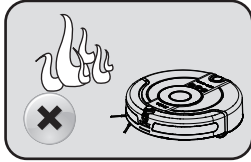

⚠ Do not put the machine behind the fire, inflammable, explosive and corrosive materials.

⚠ Do not put your clothes or any place of your body(hair, finger and so on) into the main brush and wheels, or it will cause personal injury.

⚠ Attention

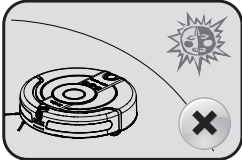

The machine is only used indoor.

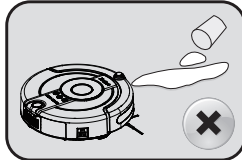

Prevent water, oil and other liquid into the machine.

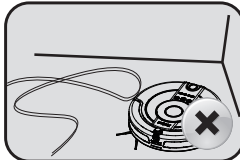

Please clean up the wire in the floor, or else it will hinder the working of the machine.

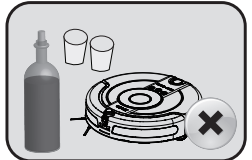

Please remove all fragile objects.

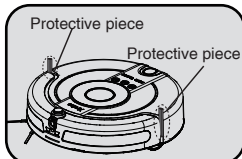

Please take down the two protective pieces before using, thus the cleaner can work well.

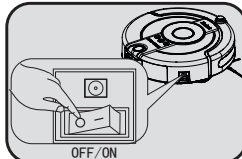

If you do not use the machine, please turn off the power switch, or else it will damage the battery.

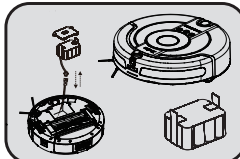

If the machine is not used for a long time, please charge the battery fully, then take it out and put it in shade place, keep the bottom of cleaner dry.

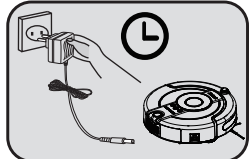

The battery should be charged about 12H, if the machine were not used for a long time or the first time. The battery should be used up for 3-4 times, which will make the battery best efficiency.

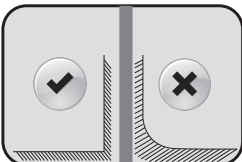

Charging station and space isolator should be behind the wall and flat place, or else the function will be influenced.

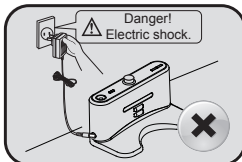

Please pull out the battery socket, if the charging station will be not used for a long time.

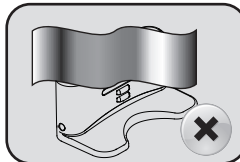

Do not cover the signal window of the charging station, or else the function of auto-charging will be invalid.

1.3 Child Safety



- * The machine should not be used alone by children.
- * Forbid the children playing the packing bag, or else it will cause smother.

1.4 About Battery

1. The machine will only be used with the original battery.
2. Please turn off the power switch before taking out the battery .
3. The battery must be taken out before abandoning it.
4. If you want to replace the battery, please keep contact with our after-sale department. it will lead to accident if wrong battery is put in the machine.
5. If the battery is leaked, please do not touch the liquid, you should wipe the liquid with dry cloth, and put the battery to recycle bin or maintenance point, do not throw it at random.
6. Please handle the old battery of the parts(remote control and space isolator). The battery includes hazardous substance, please put it to recycle site according to original environmental protection regulations.



1.5 Usable Range

Applicable Range

The cleaner is suitable to the following environment:



Wooden Floor

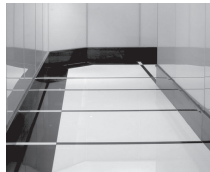

Tile

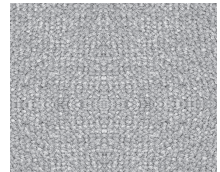

Carpet

Not Applicable Range

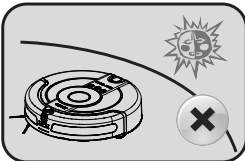

*Not suitable to be used in the extreme hot or cold environment.

*The machine is only used indoor.

*Do not use the machine in the place without guard railing, or else it will damage the machine and cause personal injury.

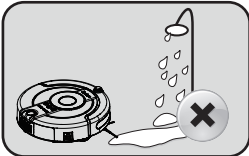

*Do not use the machine in the following environment: wet, inflammable, explosive and easily corrosive.

*Do not let the machine clean the flaming cigarette butts, matches and so on.

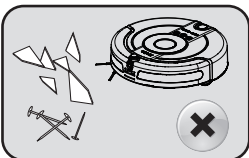

*Do not let the machine suck the toner from laser printer and copier, or else it will cause fire.

*Do not let the machine suck sharp objects, such as glass sheet, piton and so on, or else it will damage the machine.

2. Product Formation

2.1 Main Body and Accessories

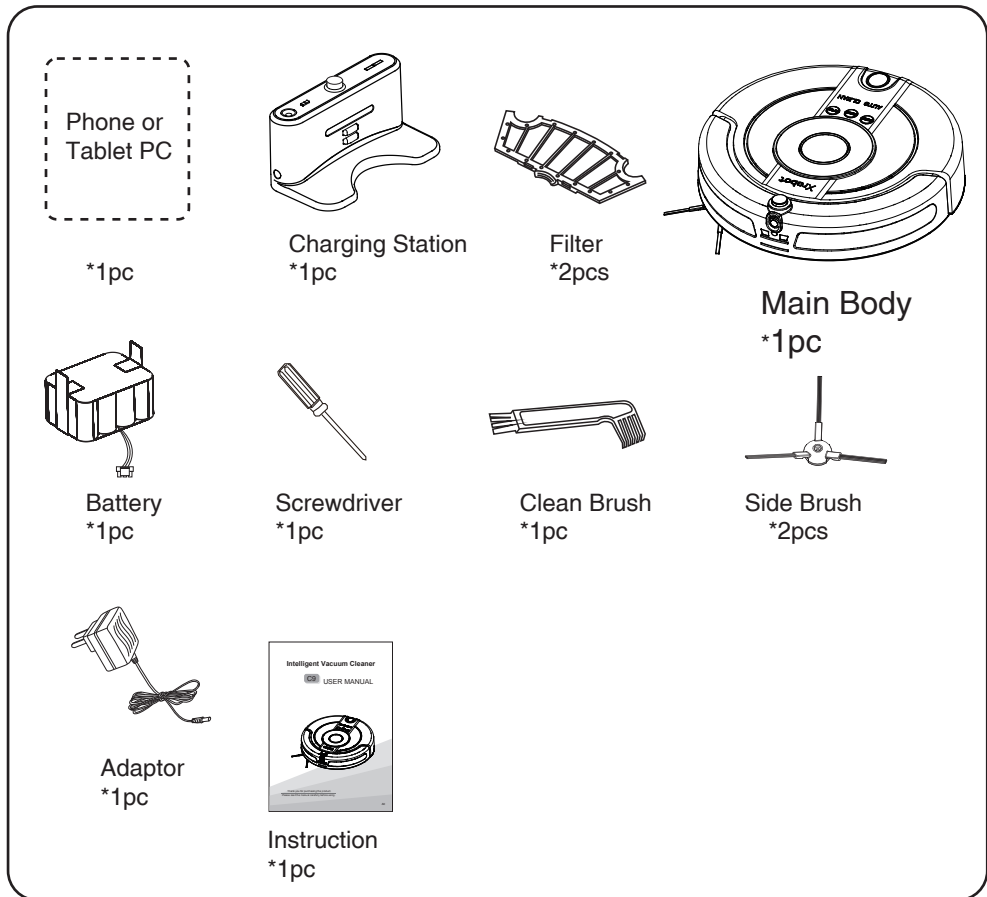

🗨 Tips:

* The main body is equipped with a side brush and a filter, and another side brush and filter are put in the gift box.

2.2 Accessories Introduction

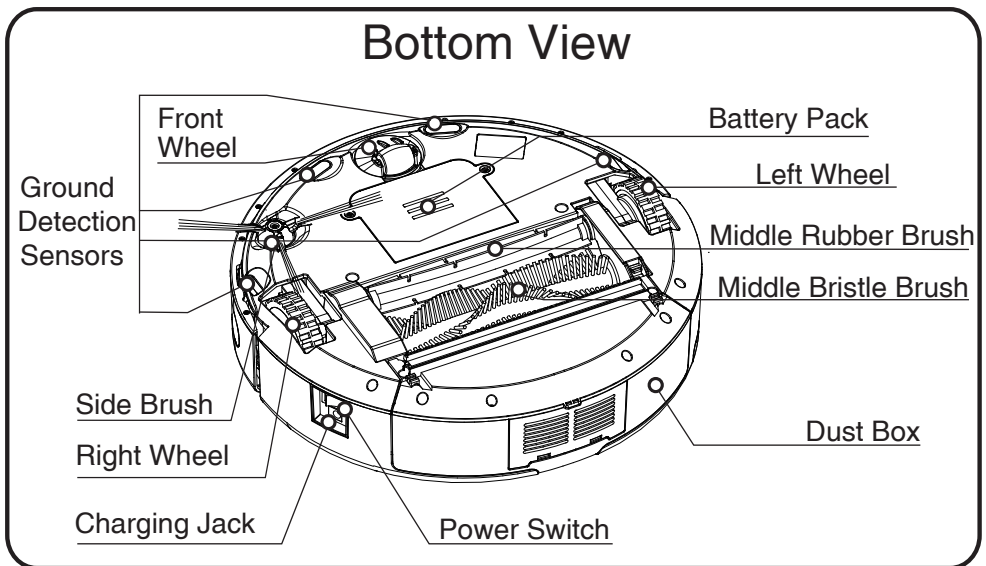
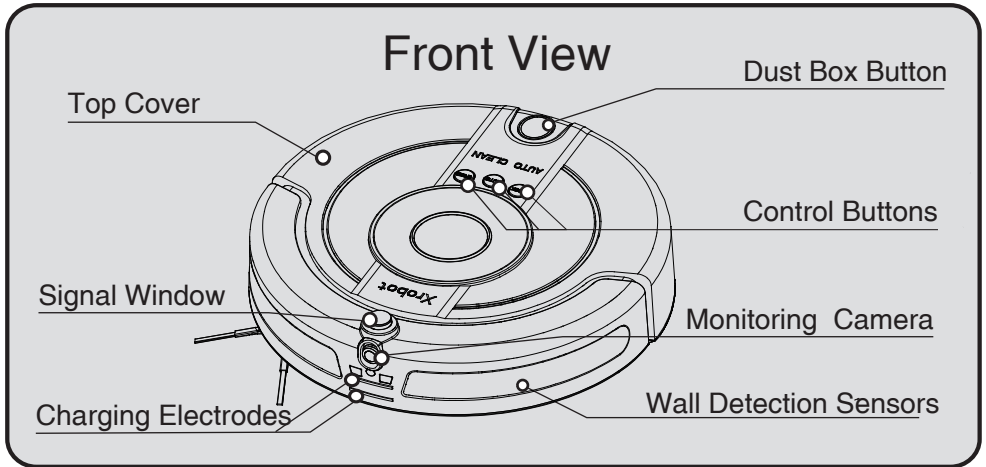

3. Product Installation

3.1 Main Body

Please install the battery before using the cleaner!

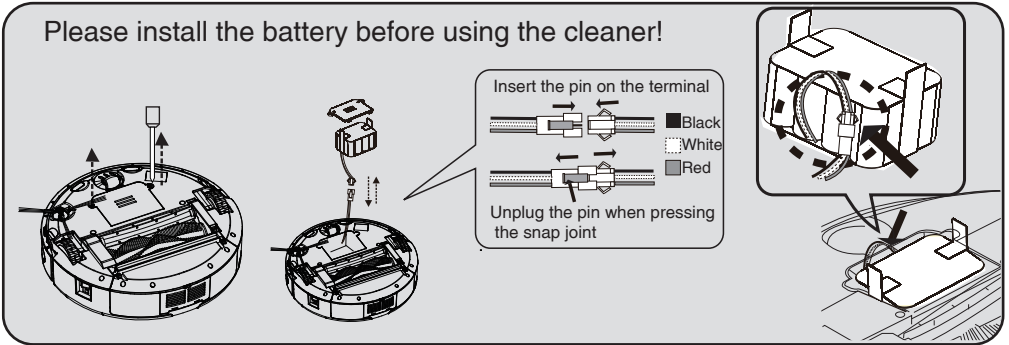

1. Loosen the screw with screwdriver to unfold the battery cover
2. Connection method: take out the connector between the battery and cleaner, join the two terminal, take care of the relevant color.
Method to disassemble snap joint: Unplug the pin when pressing the snap joint.
3. Firstly, put the wire terminal buckle and wire into the battery pack gap according to the top right image. Then put the battery into battery compartment. Finally, close the battery cover and lock screw.

Caution:

⚠ Danger! Electric shock.

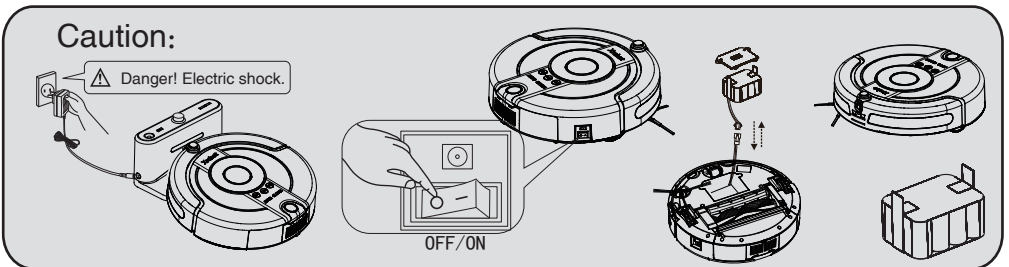

1. If you do not use the machine, please turn off the power switch, or else it will damage the battery.
2. If the machine is not used for a long time, please charge the battery fully, then take it out and put it in shade place, keep the bottom of cleaner dry.
3. The battery should be charged about 12H, if the machine is not used for a long time or the first time. When the battery is used up for 3-4 times, which will make the battery best efficient.
4. You should use the original battery, or else it will cause damage and accident.

3.2 Charging Station

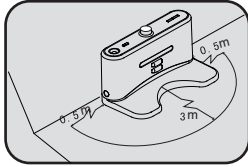

1. Put the charging station on the flat floor and behind the wall, no obstacle or hollow areas 3m away from the charging station in the front and 0.5m on the right and left.

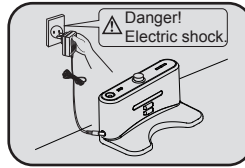

2. Insert the adaptor into the power socket side, and another side in the charging station.

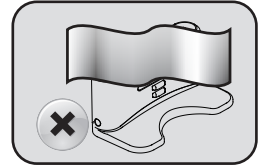

3. Do not cover the signal window of the charging station, or else the function of auto-charging will be invalid.

3.3 Installation of KV8 APP

This smart home application is operated in your smart phone or tablet computer.

1. This product only use in smart phone or tablet computer with android system above 2.2 version or IOS system above IOS5 version.
2. Please make sure your smart phone or tablet computer work normally.
3. Please download and install the APK or IPA by reference to the operation guide of KV8 APP.
4. Once you have installed this package, you can find the KV8 icon in your application list.
5. Make sure the WIFI work normally, and the cleaner can realize the function of remote control and monitoring by referring to the operation guide of KV8 APP.



Tips:

For details, please see the chapter 8 and 9 in the operation guide of KV8 APP.

4. Product Usage

4.1 Introduction of Work Mode

4.1.1 Operation Buttons

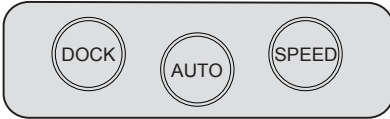

Buttons' instruction	
DOCK	Auto charging button: the cleaner will automatically search the charging station in standby or working mode, press the button again, cleaner will stop searching.
AUTO	Auto cleaning button: the cleaner will automatically clean in standby or working mode, and the speed is the preselected one. Press it again, cleaner will stop, and the function will not be remembered.
SPEED	Speed button: the cleaner will automatically enter quick cleaning in standby or working mode, press the button, cleaner will clean at a slow speed. Press it again, return to quick cleaning.

Instruction of button lamp
<ol style="list-style-type: none"> 1. The three buttons will extinguish after twinkling twice in standby mode. 2. The three buttons will from dark to brighter in charging mode, flashing regularly. 3. The three buttons will on when being fully charged.

4.1.2 Work Mode:

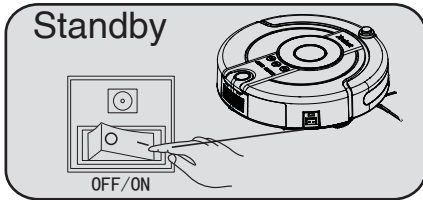

1. Make sure the battery power is enough, turn on the power switch and press the button "AUTO", the power indicator will be out after flashing twice and the cleaner is in standby mode.

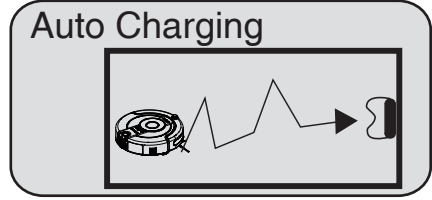

2. In standby mode, press the button "DOCK", the cleaner will automatically return to its charging base for self-recharging. Then press the button again, it will stop seeking the charging base.

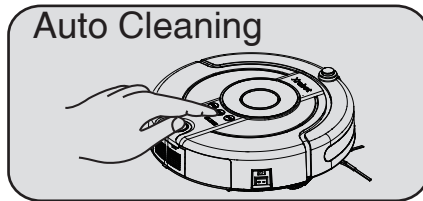

3. In standby mode, press the button "AUTO", the cleaner will start cleaning automatically. Then press the button again, it will stop cleaning.

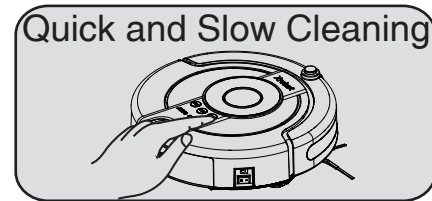

4. In standby mode, the cleaner defaults to quick cleaning. Press the button "SPEED", it will switch to slow cleaning. And it will return to the fast cleaning by pressing the button again.

- Tips:**
1. when the battery power is low, the machine will emit the sound "di di", the main brush also stops and will seek the charging station automatically.
 2. when you use the cleaner, please make sure the cleaner is in standby mode.

4.3 Charging Station

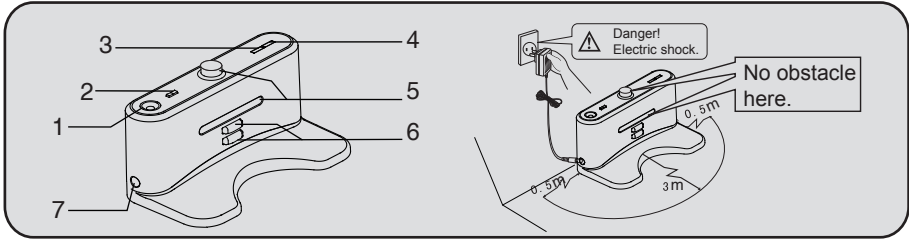

Usage:

1. Install the charging station according to the method from page 8, as shown on the above photos.
2. Turn on the power switch, press the button “ Charge ”, the cleaner will get back to the charging station.
3. In the mode “ Auto Cleaning ”, when the battery power is low, the machine will get back to the charging station.

NO.	Name	Function
1	LED decorative lamp	When need increase environment atmosphere, you can open the decorative lamp, and put a little flavor on the lamp cup, it will emit charming fragrance after an appropriate temperature.
2	Switch of LED decorative lamp	Press the button, the LED decorative lamp will open or close
3	Power indicator	When charging station power on, the indicator is on.
4	Charging indicator	When charging station connects to the cleaner, the indicator will twinkle.
5	Signal window	Emitting signal is the unique way to conduct the cleaner to recharge with charging station, so the signal window should be clean regularly to ensure the sensitivity and accuracy.
6	Charging electrodes	The charging electrodes should well contact with cleaner electrodes, or else the charging will fail.
7	DC socket	Output end jack of adaptor.

4.4 Charging Methods

4.4.1 Manual Charging:

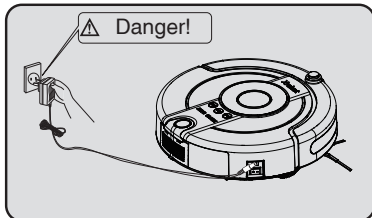

1. Charge the machine with an adaptor: Connect the plug between the machine and the adaptor, then insert the socket.

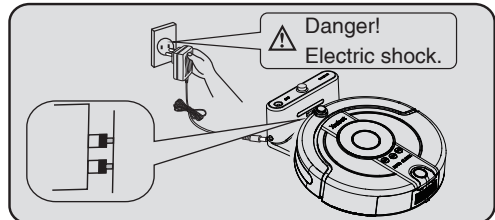

2. Connect the plug between the adaptor and charging station, then put the machine behind the charging station, put the charging electrode on the charging station directly, finally connect the power socket .

4.4.2 Auto Charging:

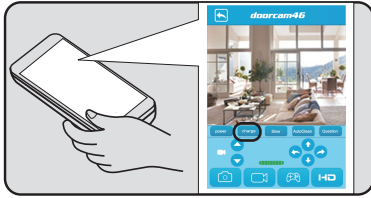

1. Charging by smart phone control: Firstly install the app, then open the controlling interface, click the “charge” button and the cleaner will find the charging base in the effective scope.

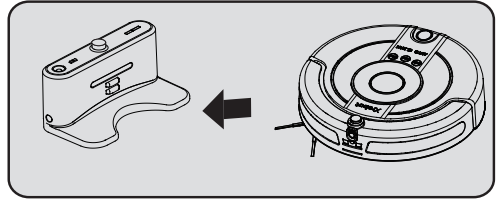

2. Auto charging: When the battery power is low during the cleaning, the cleaner will emit the sound “di di”, the main brush will also stop working, and the machine will get back to the charging station automatically.

5. Product Maintenance

Tips:
Please clean the cleaner regularly according to the usage.

5.1 Daily Storage

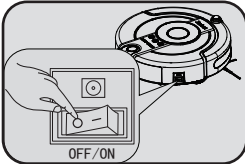

when you do not use the cleaner, please make sure you turn off the power switch, lest damage the battery.

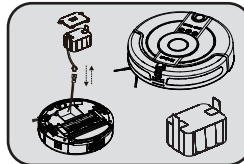

If the machine is not used for a long time, please charge the battery fully, then take it out and put it in shade place, keep the bottom of cleaner dry.

5.2 Clean the Main Body

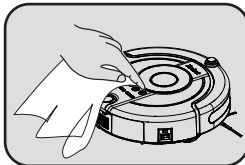

1. Before cleaning the main body, please turn off the power switch and take out the power plug.
2. Please wash the main body with water and neutral detergent, and make sure the mop is dry, do not put the water into the machine.
3. Do not wash the machine with oil.

5.3 Clean the Dust Box

5.3.1 Install the Dust Box

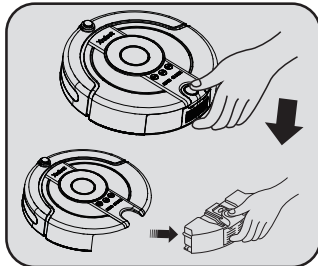

1. Push the buckle on the double side, then open the baffle.

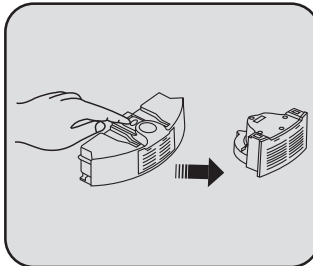

2. Press the red button on dust box, the fan assembly will automatic popup.

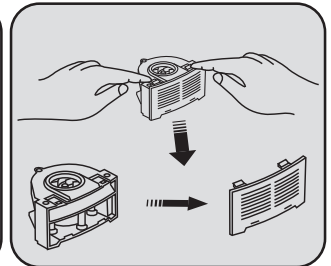

3. Turn out the fan assembly, and pull the two buckles, then the fan will be opened.

5.3.2 Clean the Dust Box

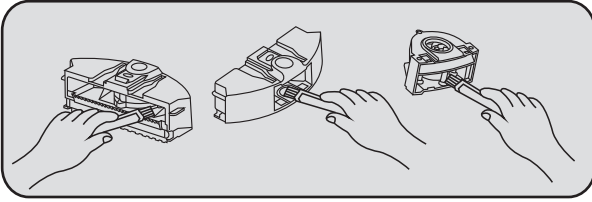

Firstly, pour out the dust, then use the clean brush to clean the dust box and fan assembly. Take out the fan assembly, and then clean the dust box with water.

(Remark: the fan assembly cannot be cleaned directly with water.)

5.4 Clean the Filter

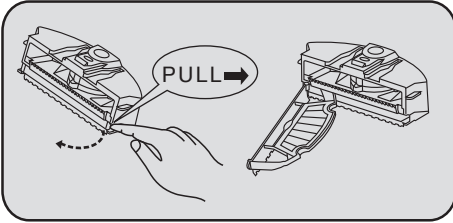

1. First, pull out the dust box, then push the buckle on the double side and open the baffle.

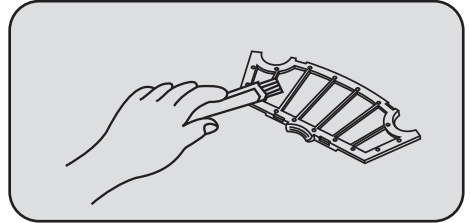

2. Take out the filter, and then clean the dust with the clean brush.

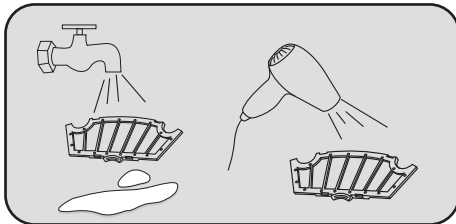

3. If you find there are much dust on the dust box and filter, you can wash the filter and dust box inside. (Remark: it can reuse after sufficient airing)

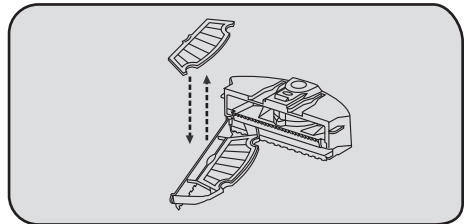

4. Push out the filter out of the buckle from the bottom to top, and then replace the filter into new and clean one.

5.5 Clean the Main Brush

5.5.1 Assemble and Disassemble the Main Brush

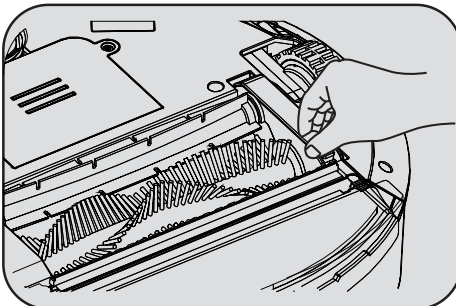

1. As shown on the above photo, push the buckle strongly, and lift it up.

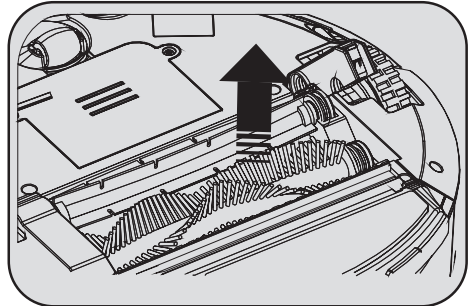

2. Grasp the middle bristle brush or middle rubber brush, and lift it up.

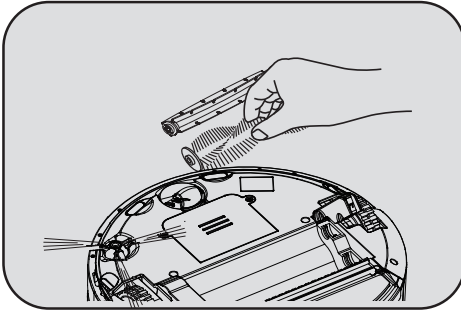

3. Take out the middle bristle brush or middle rubber brush.

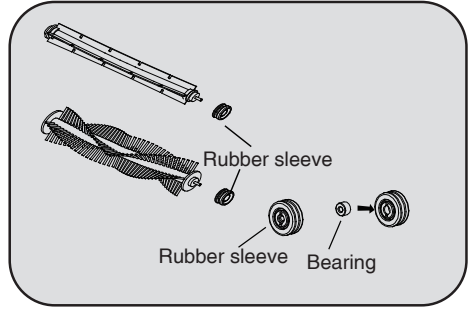

4. Take out the rubber sleeve from the middle bristle brush or middle rubber brush.

Tips: there is a bearing in the rubber sleeve, when you clean the main brush, take care whether the bearing falls off, if it is, please put it in the rubber sleeve .

5.5.2 Clean the Middle Bristle Brush or Middle Rubber Brush

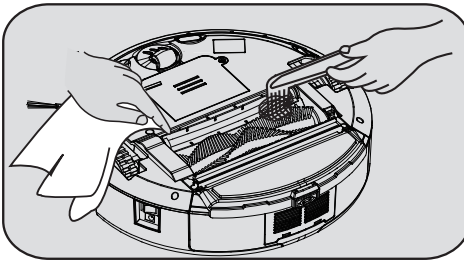

1. As shown on the above photo, please clean the middle bristle brush or middle rubber brush regularly with a clean brush.

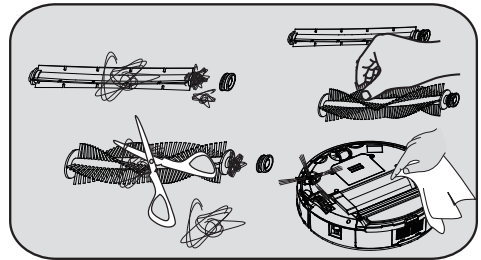

2. As shown on the above photo, clean the hair and other things regularly on the middle bristle brush or middle rubber brush.

5.6 Clean the Side Brush

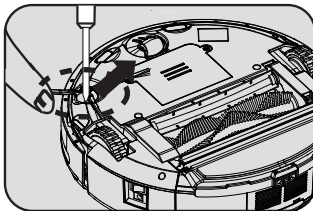

1. Take out the screw with a screwdriver on the side brush.

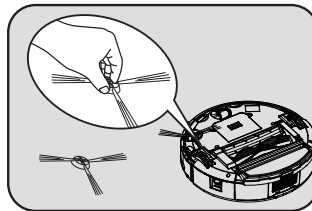

2. Take out the side brush, clean the hair on the side brush, then clean the entanglement in the slot.

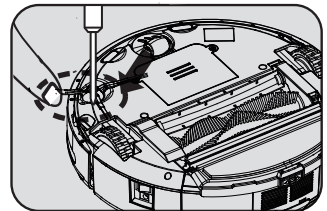

3. Put the side brush in the hole, lock the screw on the side brush.

5.7 Clean the Front Wheel

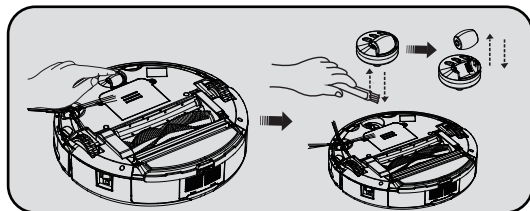

1. Pull out the front wheel with fingers or a tool. (as picture)
2. Clean the front wheel with the clean brush.
3. Put the front wheel on corresponding place and press it down when installation.

(Tips: Hair and a strip of cloth may twine in the axle of the wheels, please clean it regularly.)

5.8 Clean the Left Wheel and Right Wheel

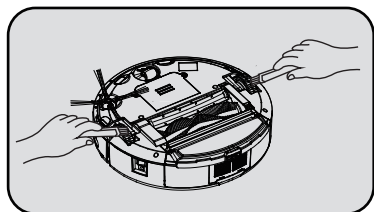

1. Clean with the clean brush, do not clean with water.
(Tips: Hair and a strip of cloth may twine in the axle of the wheels, please clean it regularly.)

5.9 Clean the Sensors

It is suggested that you should mop the sensor window with dry cloth after cleaning the sensors, lest the dust is accumulated on the window and influence the function.

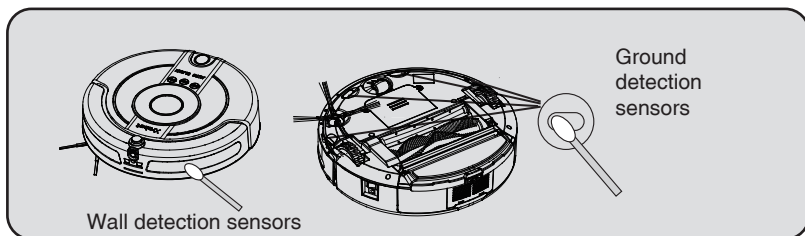

6.Common Faults

6.1 Alarm and Prompt Facility

- 💡 Tips: 1.If the cleaner stop working, it will emit the alarm sound “ di di ” .
2.You can eliminate the faults according to the fault code on the screen of the remote control.

Fault Code	Reason	Faults performance	Solution	Remarks
E001	The ground detection sensors are bad.	1. Obstacles on the sensors window. 2. Blocked on the step.	1.Clean the ground detection sensors. 2.Take out the cleaner.	Clean the ground detection sensors regularly.
E002	The line contact of main brush is bad, thus cause the bad of motor.	1.The main brush is blocked. 2.Hair and a strip of cloth twine in the main brush.	Check the main brush and clean the main brush.	Clean the main brush regularly.
E003	Battery power is low.	1.The cleaner can not work 2.It can not charge automatically.	1. The cleaner change the charging mode automatically. 2.Please charge the machine artificially.	The battery power is exhausted, it can not get back to the charging station.
E004	Left and right wheels are bad.	1.The wheels are blocked 2. Hair and a strip of cloth twine in the wheels.	Check the left and right wheels, clean the entanglement on the left and right wheels.	Clean the wheels regularly.
E005	Dust box	1.No dust box in the machine 2.Poor installation of dust box.	1.Install the dust box 2.Check whether the dust box is installed properly.	

6.2 Processing Methods

No.	Faults	Solution
1	Walk back all the time	1. It is better to avoid the cleaner working in the strong bright environment. 2. It is better to avoid the cleaner working in the black carpet. 3. Check whether the ground detection sensors are covered by dust and other things, please clean them with a piece of dry cloth.
2	The cleaner does not work	1. Check whether the power switch is on and the power indicator is on. 2. Check whether the cleaner is enough power, if not, please charge the machine.
3	The cleaner does not charge automatically	1. Check whether the LED indicator of charging station is on. 2. Check whether there are obstacles between cleaner and charging station. 3. When the battery power is low, please charge the machine artificially.
4	The cleaner can not charge artificially	1. Check whether you use the original adaptor and insert the plug. 2.If the appearance of the battery is deformed, damaged and so on: please stop using the cleaner and call our customer servicers.

- 💡 Warm prompt: if there are still faults after doing those steps like the solutions mentioned above, please keep contact with our customer servicers.

7. Technical Parameters

Main Body Parameters		Accessories Parameters	
Working Voltage	DC14.4 V	Adaptor	
Rated Power	24 W	Output Voltage	DC24V
Battery	Ni-MH	Output Current	1000mA
Battery Capacity	2200mAh	Charging Station	
Charging Time	About 3-4H	Input Voltage	DC 24V
Working Time	≥ 60 min		
Work Temp Range	-10°C~45°C		
Work Humidity Range	≤ 90%RH		
Dust box Capacity	350mL		
Specification	320*320*87mm		
Voice	≤ 65dB		

Remarks: Our company reserve the right due to the need for any technology, product design changes on products improvement. The power of interpretation is owned by our company.

8. KV8 APP Operation Guide(Android)



Create Easy Life...

Remark

Because of the software version upgrade or other reasons, the contents of this document will not be regularly updated. Unless otherwise agreed, this document only as a guide, all statements, information, and recommendations in this document do not constitute any express or implied warranty.

Summarize

KV8 is a smart application APP based on the Android platform. This document is about instructions, precautions of using the software which guides the first-time users.

Test and operating environment

A device (phone or tablet PC) with android system on above 2.2 version, one or more intelligent applications.

Software Installation

Install the latest KV8 APP in the android devices;

1.0 Document name of APP : KV8.apk

After installing APP according to the normal procedures, you can find the icon KV8 in the list of applications (as shown on the right)



Preparation

1. Open the cleaner, and confirm the SSID on the cleaner (such as: APWifi*****).
2. Open the “ settings ” on the phone to set WLAN.
3. Confirm the new WLAN hotspots on the list, select above SSID to connect, the default password: 88888888.

1. Open the application program of KV8:

The figure below is the menu for application, and the screen will flash for 3 seconds or more; the right column is the initial state of the device list after being opened. Make sure the WIFI on Android devices has been turned on before you open the application.



Click the top-right button to add device.

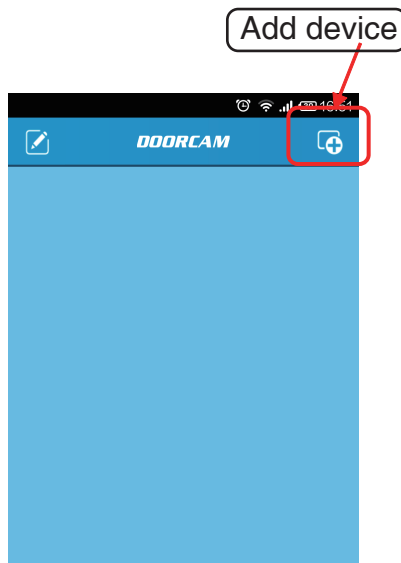

2. Add device

Normal-add device :

Click on the button “ Add device ” on top right cover of the equipment list to enter device adding window as shown on the left below picture, and then input the name, ID and password of the device (the default password is “ 88888888 ”, click on the button “ save ” to save, and click on the button “ return ” to the device list page, the device will automatically connect.

Quick-add device :

For the device on the same LAN, you can quickly search and add the device through the LAN (provided that the device and Android device have been connected to the same router). Click “ search in LAN ” and the system will automatically search the devices, then all devices will be listed (as shown on the right). For the devices have been added, there will be a word of "has been added". Click and manually add "has been added", the system will prompt and ignore this operation; Click the un-added Device to add to fill out the Device ID and Password (The default password is “ 88888888 ”) then save it. (Click the “ add all devices ” button and system will automatically connect all un-added devices in LAN.) Click the back button to return to page of device list and the system will automatically connect all online devices.

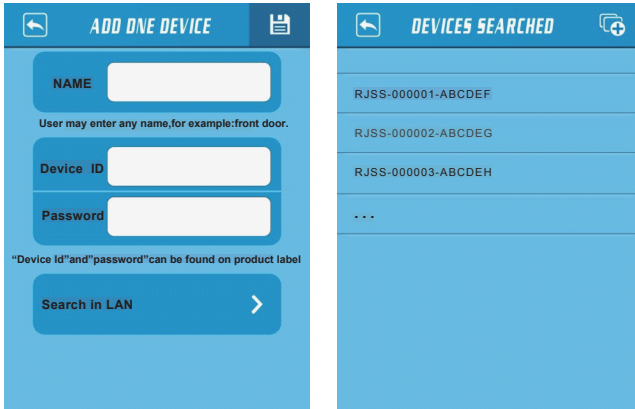

The stars symbol marked by a pane can help the users to add the only shortcut device, when there is marked device, the software will directly into video mode interface after opening the APP (the connected state is on the right picture).

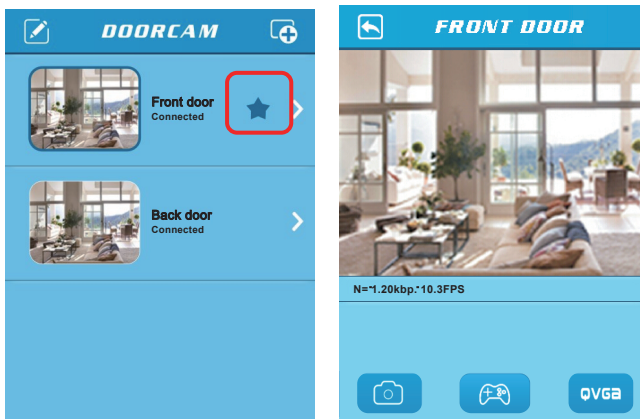

3. Real-time video preview

In the “ Doorcam ” (see picture below) , the device will show the connection status with “ connected ” or “ not connected ” . Click the image shown “ connected ” , and enter the real-time preview interface.

On the real-time preview interface, you can see the real-time image and hear the live sound (optional). Below the image shows the bit rate and frame rate.

The button below the image is for screen capturing, display control and resolution switching. The “ displayed controller ” button is for switching the controlling mode and preview mode. In controlling mode, you can control the working mode by controlling the button in the interface (see the later chapter). “ Resolution switching ” can switch the “ QVGA ” and “ HD ” resolution. Press the button below the interface, the button will turn into blue and start working according to the instruction. Press the button again, the cleaner will exit the working status. Click the real-time image region can adjust the video performance in brightness and contrast.

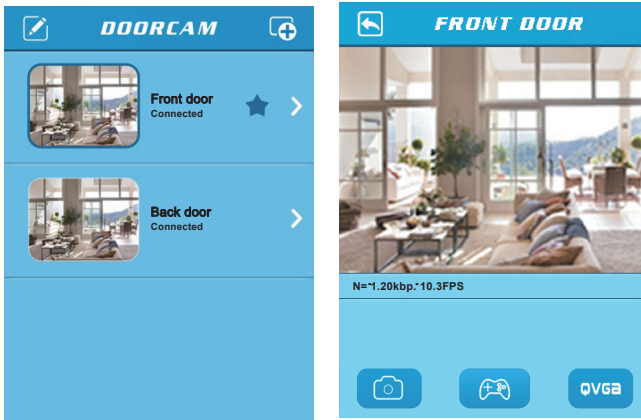

4. Control interface

Click the “ display control ” button; enter into the operation interface (As shown on the right). You can operate the cleaner by any instruction in this interface.

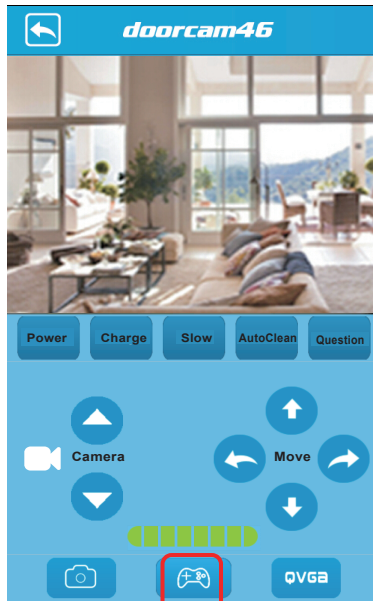

4-1. Power

Click the “power” to enter hibernating mode.

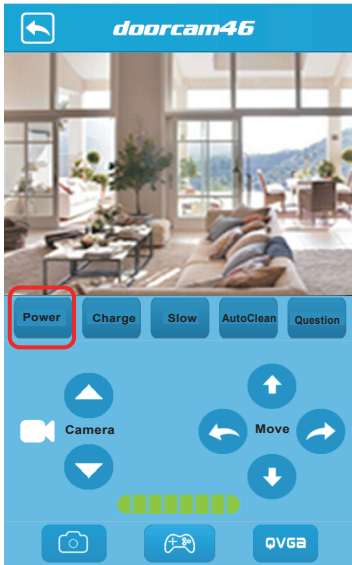

Click “power” again to return back to standby mode.

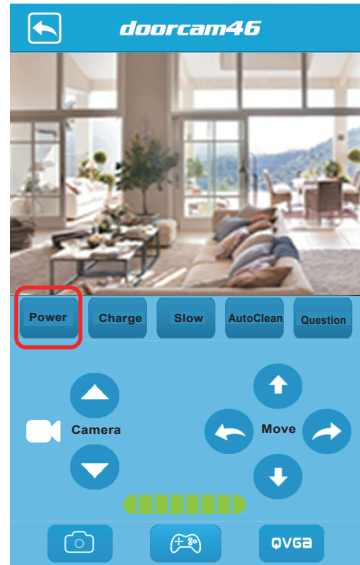

4-2. Charge

In standby mode, click “charge” to enter into recharging mode with the flashing of the progress bar.

Click “charge” again to return back to standby mode.

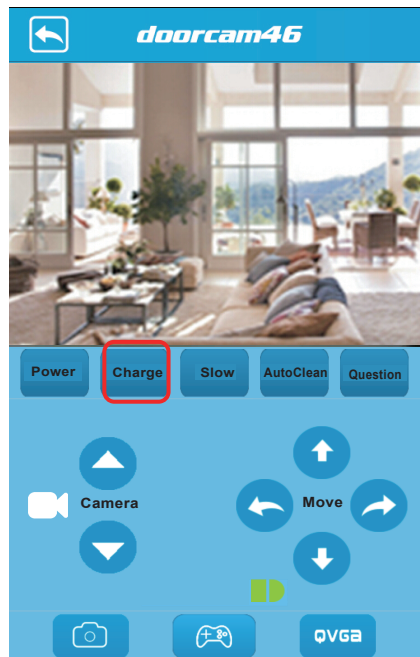

4-3. Speed setting

In standby mode, set the auto-cleaning speed. (default is fast speed)

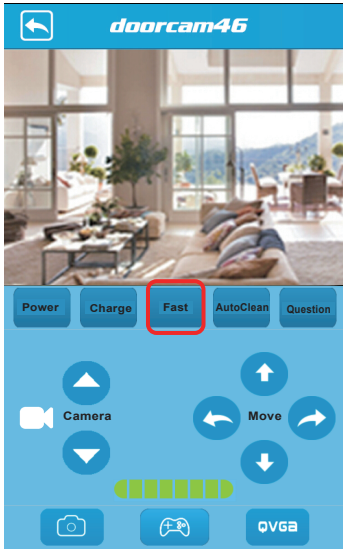

Click “ fast ” to enter slow speed mode, and click “ slow ” to back to fast mode namely standby mode.

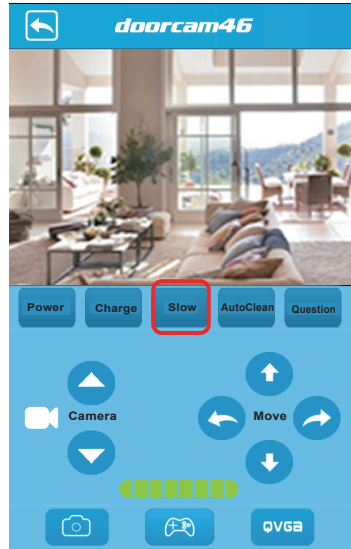

4-4. Autoclean

In standby mode, click “ Autoclean ” to enter into the auto-cleaning mode with the flashing of the progress bar.

Click “ charge ” again to return back to standby mode.

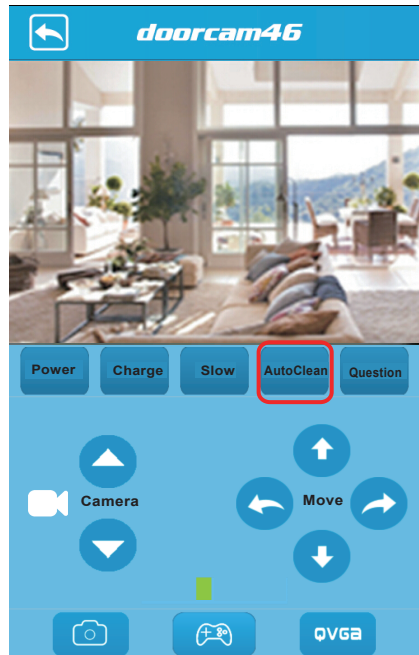

4-5. Question

“ Question is for hint function of error code. Under normal operating condition, clicking “ Question ” will show the normal code “ 00 ” ”.

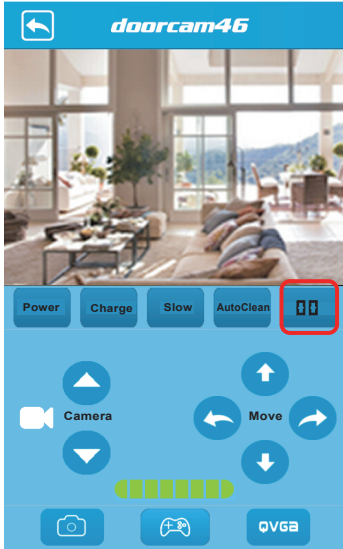

If there is a machine fail, the progress bar will flash with red. And there will be an error code showing in the image. After repairing, the cleaner will enter self-inspection to be standby mode.

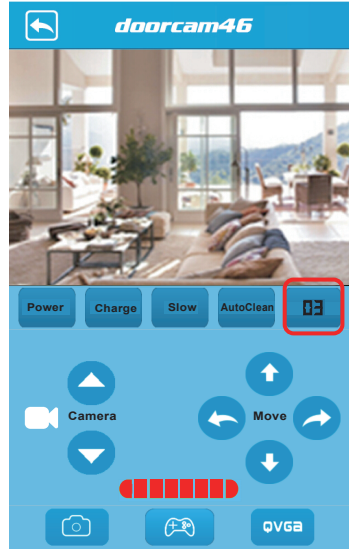

4-6. Manual operation

You can manually operate the cleaner in the standby status.

Click the direction button (on the right of the camera icon) to adjust the angle of camera. (Do not exceed 4 clicks in up arrow or down arrow.)

Click the four direction button to operate the forward, back, left turn and right turn of the cleaner.

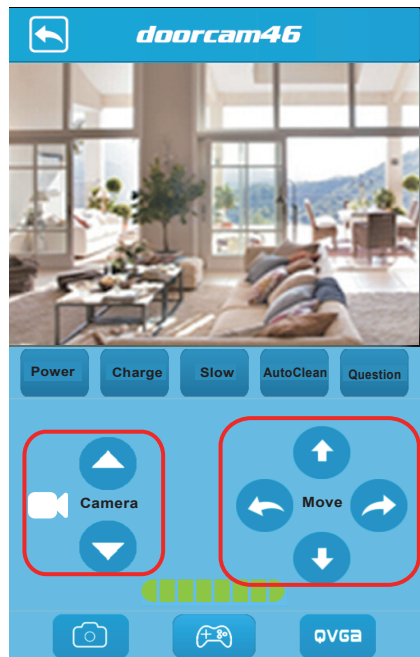

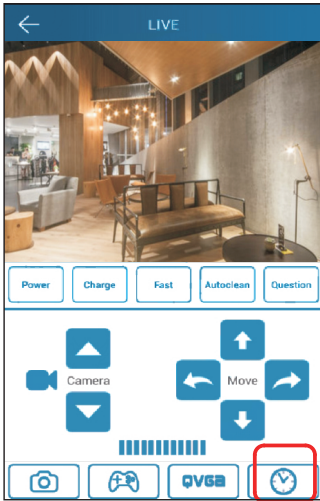

4-7 Cleaning Appointment

Click the clock on the lower-right corner to enter into cleaning schedule mode.

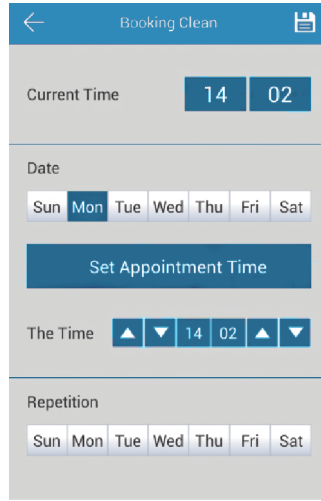

After entering into cleaning appointment interface, click ▲▼ to set hour and minute; click 日 一 二 三 四 五 六 to set day. (same time in a whole week can be scheduled)



After successful appointment, click  in the upper-right corner to save the setting. After preserving the setting, “Successful Appointment” will be displayed.

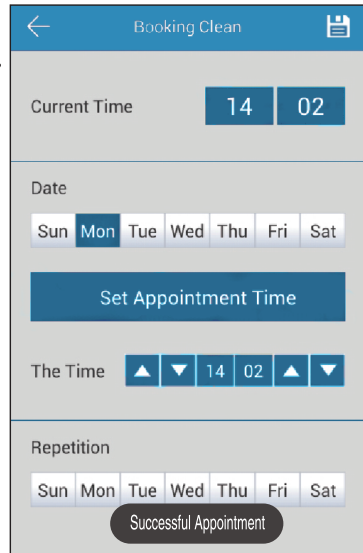

5. Device Editing Interface

Click the arrow region with “ connected ” to enter into the interface of editing parameters (as shown on the right).

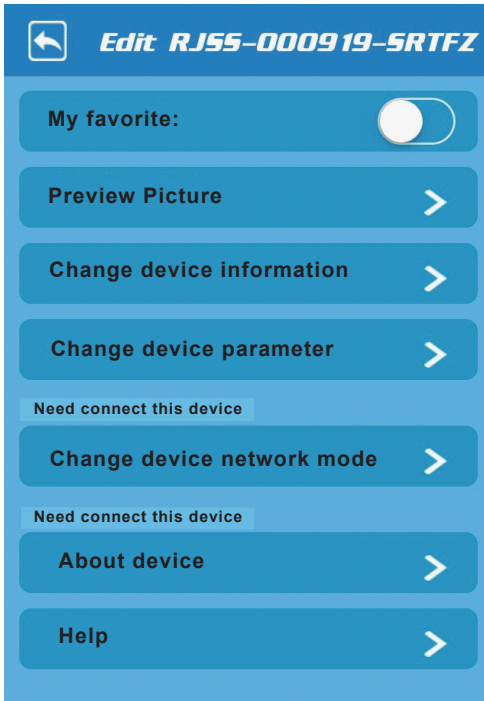
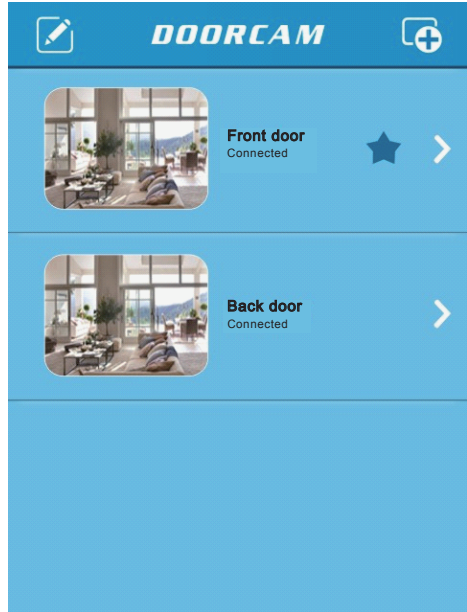

- ◆ My favorite: the open switch in blue shows following this device. And each time starting this App will enter the real-time video image. The close switch shows no following this device. App can only follow one device.
- ◆ Preview Picture: screenshots will be stored in this directory for viewing.
- ◆ Change device information: can change the device information.
- ◆ Change device parameter: can change the brightness and contrast.
- ◆ Change device network mode: can switch the network mode in WIFI or AP.
- ◆ About device: show the device information of firmware version, network mode and SSID.
- ◆ Help: guide for some possible doubts.

A) Change device information:

In the condition of device connected, modify the “ Name ” according to the below picture. For the password modification, click the button “synchronize to the remote device” to enter the old password and new password of 8 digits (the default password is 88888888). And then click the top right button to save it.

B) Change device parameter:

According to the actual requirement to adjust the brightness and contrast of the video interface .

C) Change device network mode:

Click “ change device network mode ” (as shown on the right). The interface shows the “ WI-FI mode ” . Slide the button to switch the network mode. Click the “ AP mode ” to switch to AP mode interface(the AP mode interface cannot be edited.) Then click the top right button to synchronize to device ends.

Connect different router by switching Android device in WI-FI mode. Click “ choose SSID ” to choose WI-FI interface. Choose new router and connect, back to left interface to input password.

Click top right button to synchronize to device ends.

D) Check device information interface:
Click “ About device ” button to check the device information.



E) Preview picture:
Click “ preview picture ” button to enter the image file lists, select the file to view.

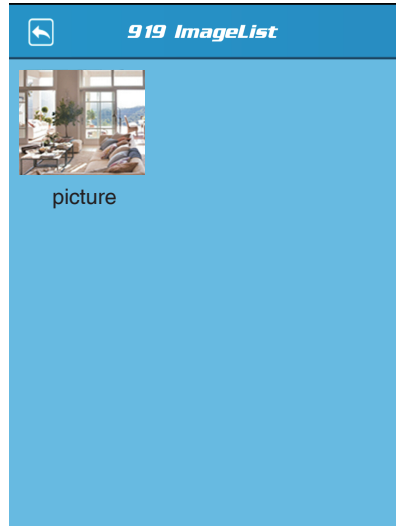



F) Help:

Click the button to enter help document. (see the APP for details)

6. Remove device

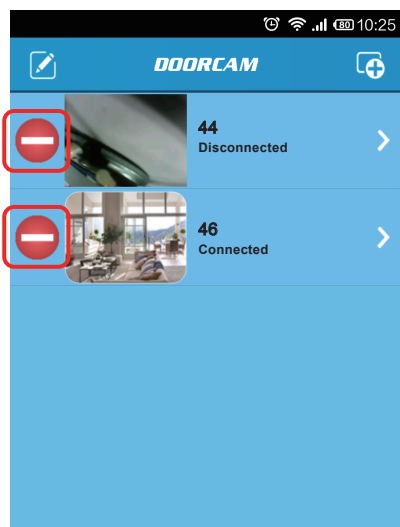
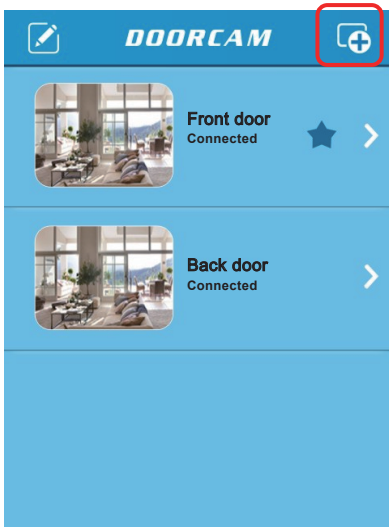
In the device list interface, Click the top left “ editing ” button to enter into the interface of device-deleting. Click the left “ deleting button ” of the list, device is on the deleting condition. Click the top left “ editing ” button to exit the editing condition.



When the device is on the deleting condition, click the  button to exit the deleting condition. Click “ Delete ” to delete the device.

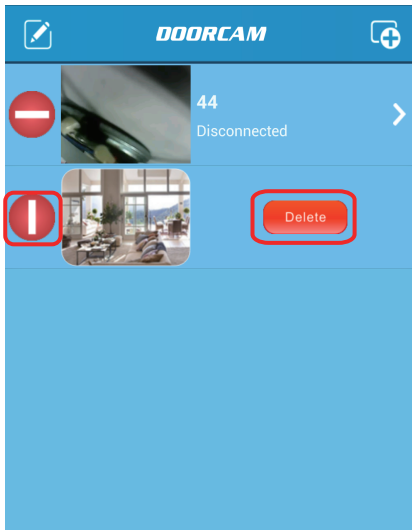

7. Reconnect all devices

In the device list, the popup menu will appear at the bottom of the interface with the clicking of “ Menu ” button. Click “ reconnect all devices ” button, the system will connect all devices according to the instruction.

Click “ WI-FI setting ” to enter into the interface of a switching from Andriod to Router. Choose the new router SSID and connect it. Click “ About App ” button to enter into the interface of App information.

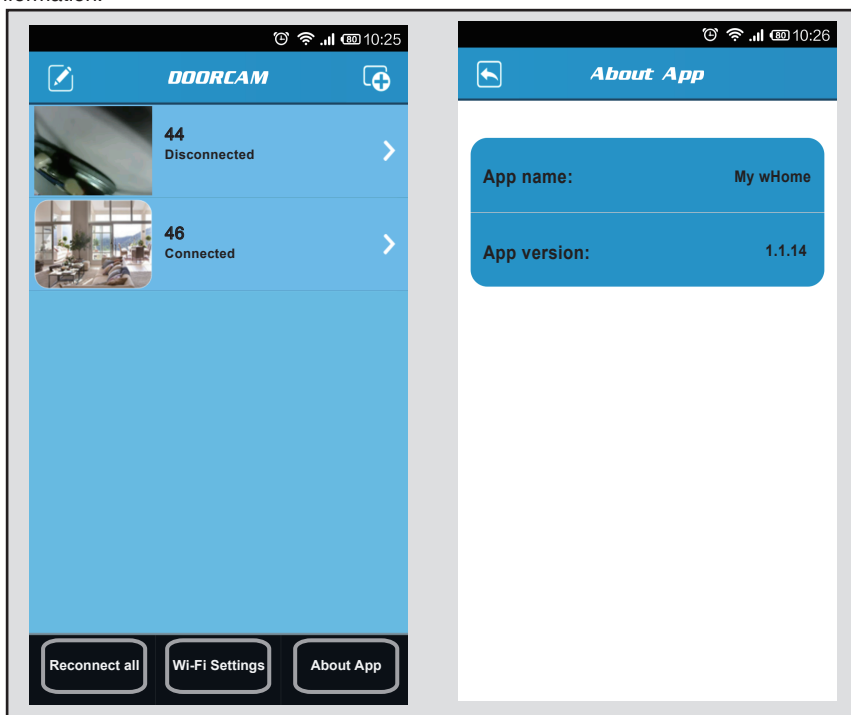

8. Dual mode switch

To adapt different request of users the device can support AP mode and Station mode.

AP Mode

AP is short for (Wireless) Access Point, for direct connection. User can implement connection by point-to-point. In this state, user can exclude the external network interference

Change 26 network ✓

This device is connected

AP mode:

AP SSID: APWiFi000026

AP password:

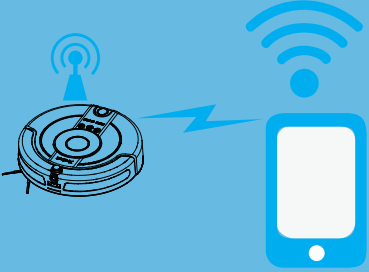

Station Mode

This mode is mainly used for user going online and wireless coverage. By the routing function, it can realize the connection sharing of home wireless network, ADSL and wireless shared

Change 26 network ✓

This device is connected

Wi-Fi mode:

Wi-Fi SSID: RJcompany

Wi-Fi password:

Select a SSID: WPA2_PSK_AES >

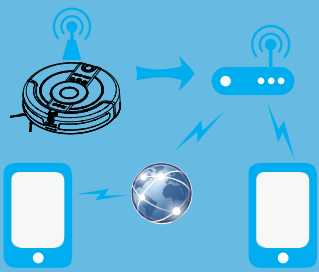

9. KV8 APP Operation Guide(IOS)



Create Easy Life...

Remark

Because of the software version upgrade or other reasons, the contents of this document will not be regularly updated. Unless otherwise agreed, this document only as a guide, all statements, information, and recommendations in this document do not constitute any express or implied warranty.

Summarize

KV8 is a smart application APP based on the IOS platform. This document is about instructions, precautions of using the software which guides the first-time users.

Test and operating environment

A device (phone or tablet PC) with IOS system on above 2.2 version, one or more intelligent applications.

Software Installation

Install the latest KV8 APP in the IOS devices;

1.0 Document name of APP : KV8.apk

After installing APP according to the normal procedures, you can find the icon KV8 in the list of applications (as shown on the right)



Preparation

- 1 Open the cleaner, and confirm the SSID on the cleaner (such as: APWifi*****).
- 2 Open the “ settings ” on the phone to set WLAN.
- 3 Confirm the new WLAN hotspots on the list, select above SSID to connect, the default password: 88888888.

1. Open the application program of KV8:

The figure below is the menu for application, and the screen will flash for 3 seconds or more; the right column is the initial state of the device list after being opened. Make sure the WIFI on Android devices has been turned on before you open the application.



Click the top-right button to add device.

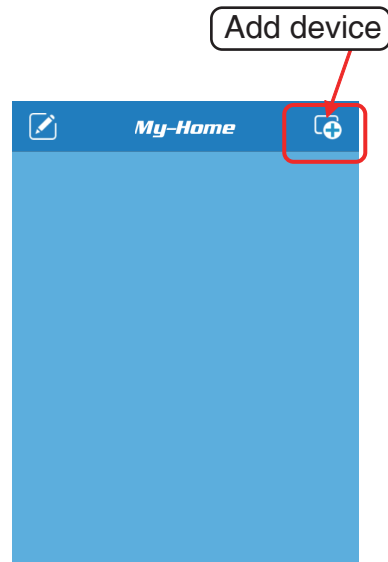

2. Add device

Normal-add device :

Click on the button “ Add device ” on top right cover of the equipment list to enter device adding window as shown on the left below picture, and then input the name, ID and password of the device (the default password is “ 88888888 ”, click on the button “ save ” to save, and click on the button “ return ” to the device list page, the device will automatically connect.

Quick-add device :

For the device on the same LAN, you can quickly search and add the device through the LAN (provided that the device and Android device have been connected to the same router).

Click “ search in LAN ” and the system will automatically search the devices, then all devices will be listed (as shown on the right). For the devices have been added, there will be a word of "has been added". Click and manually add "has been added", the system will prompt and ignore this operation; Click the un-added Device to add to fill out the Device ID and Password (The default password is “ 88888888 ”) then save it. (Click the “ add all devices ” button and system will automatically connect all un-added devices in LAN.) Click the back button to return to page of device list and the system will automatically connect all online devices.

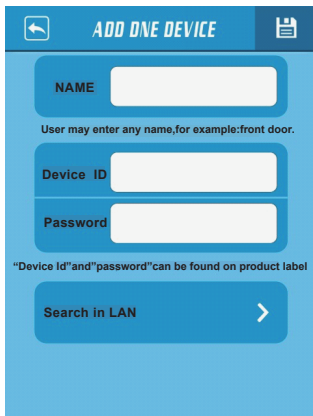

The stars symbol marked by a pane can help the users to add the only shortcut device, when there is marked device, the software will directly into video mode interface after opening the APP (the connected state is on the right picture).

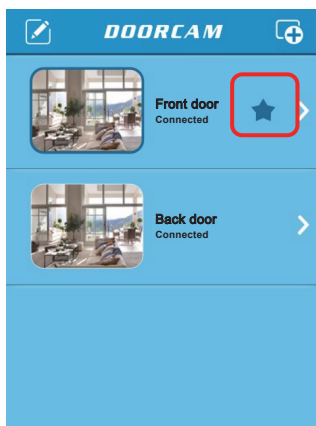

3. Real-time video preview

In the “ Doorcam ” (see picture below) , the device will show the connection status with “ connected ” or “ not connected ” . Click the image shown “ connected ’ , and enter the real-time preview interface.

On the real-time preview interface, you can see the real-time image and hear the live sound (optional). Below the image shows the bit rate and frame rate.

The button below the image is for screen capturing, display control and resolution switching. The “ displayed controller ” button is for switching the controlling mode and preview mode. In controlling mode, you can control the working mode by controlling the button in the interface (see the later chapter). “ Resolution switching ” can switch the “ QVGA ” and “ HD ” resolution. Press the button below the interface, the button will turn into blue and start working according to the instruction. Press the button again, the cleaner will exit the working status. Click the real-time image region can adjust the video performance in brightness and contrast.

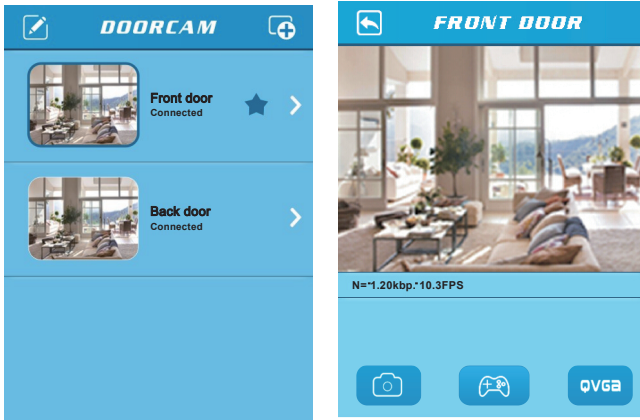

4. Control interface

Click the “ display control ” button; enter into the operation interface (As shown on the right). You can operate the cleaner by any instruction in this interface.

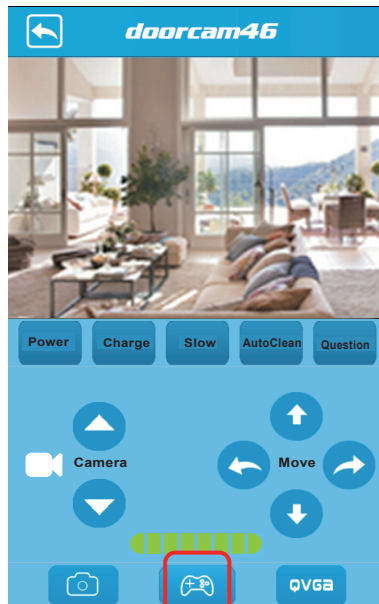

4-1. Power

Click the “ power ” to enter hibernating mode.

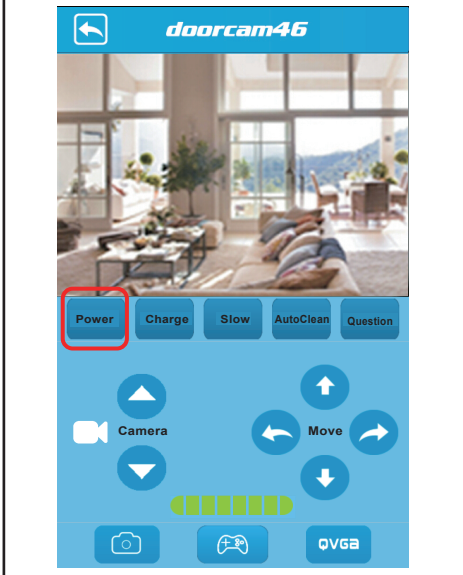

Click “ power ” again to return back to standby mode.



4-2. Charge

In standby mode, click “ charge ” to enter into recharging mode with the flashing of the progress bar.

Click “ charge ” again to return back to standby mode.

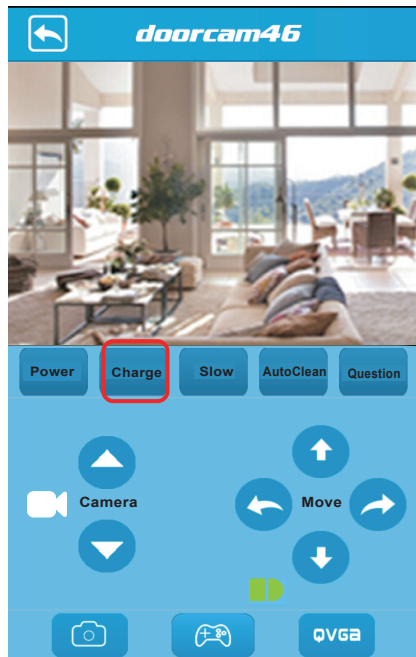

4-3. Speed setting

In standby mode, set the auto-cleaning speed. (default is fast speed)

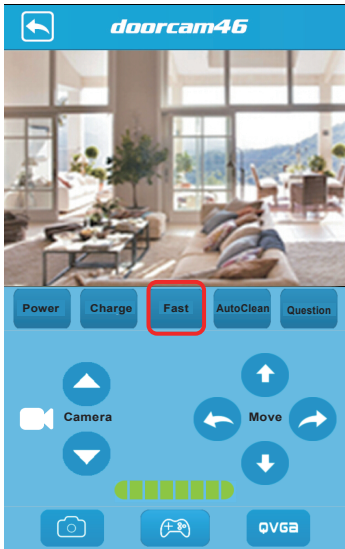

Click “ fast ” to enter slow speed mode, and click “ slow ” to back to fast mode namely standby mode.

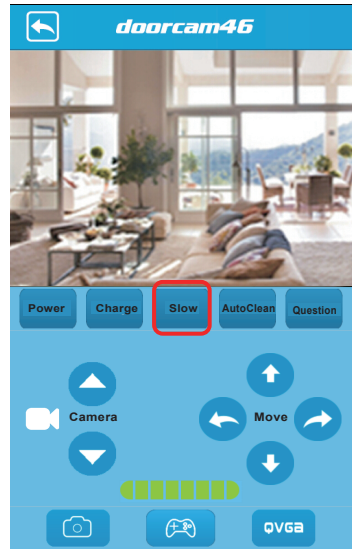

4-4. Autoclean

In standby mode, click “ Autoclean ” to enter into the auto-cleaning mode with the flashing of the progress bar.

Click “ charge ” again to return back to standby mode.

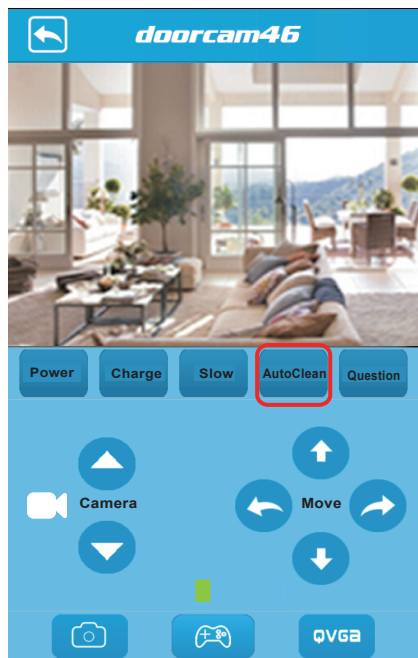

4-5. Question

“ Question is for hint function of error code. Under normal operating condition, clicking “ Question ” will show the normal code “ 00 ” ”

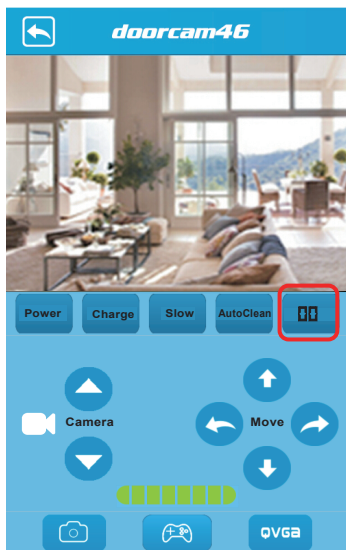

If there is a machine fail, the progress bar will flash with red. And there will be an error code showing in the image. After repairing, the cleaner will enter self-inspection to be standby mode.

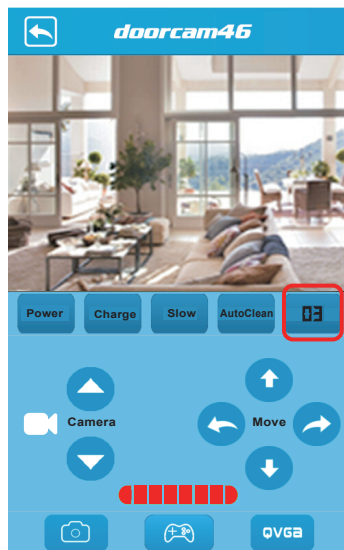

4-6. Manual operation

You can manually operate the cleaner in the standby status.

Click the direction button (on the right of the camera icon) to adjust the angle of camera. (Do not exceed 4 clicks in up arrow or down arrow.)



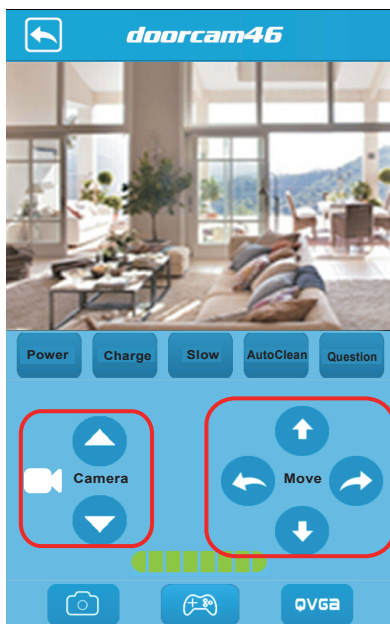





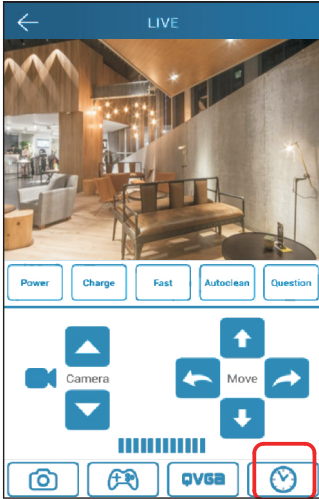

Click the four direction button to operate the forward, back, left turn and right turn of the cleaner.

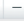
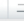

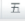

4-7 Cleaning Appointment

Click the clock in the lower-right corner to enter into cleaning schedule mode.

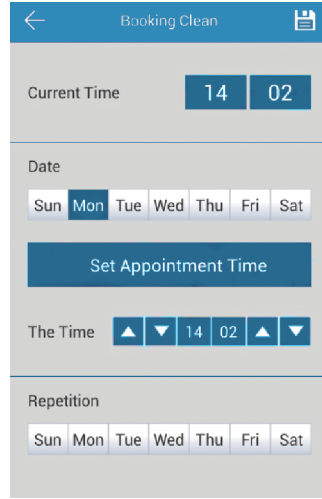

After entering into cleaning appointment interface, click   to set hour and minute; click           to set day. (same time in a whole week can be scheduled)



After successful appointment, click  in the upper-right corner to preserve the setting. After preserving the setting, "Successful Appointment" will be displayed.

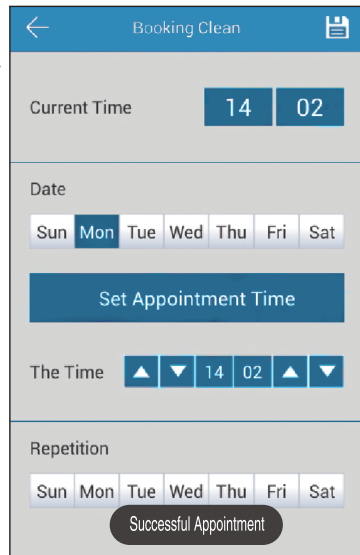

5. Device Editing Interface

Click the arrow region with “connected” to enter into the interface of editing parameters (as shown on the right).

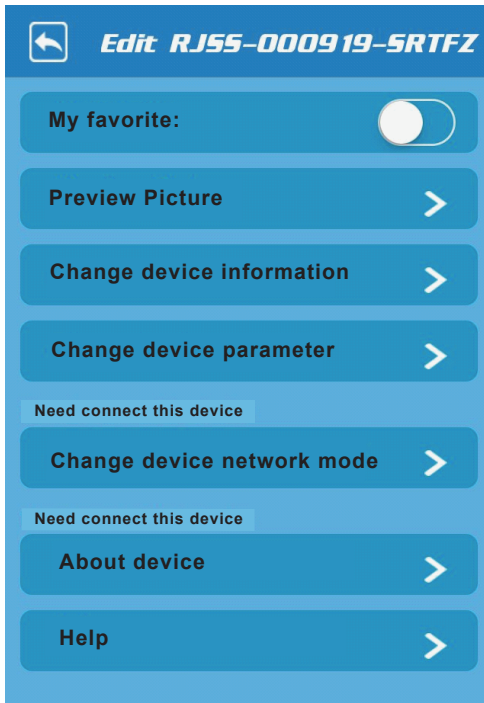
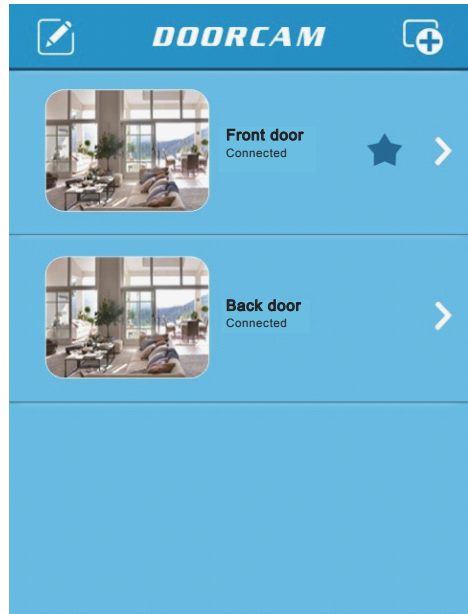

- ◆ My favorite: the open switch in blue shows following this device. And each time starting this App will enter the real-time video image. The close switch shows no following this device. App can only follow one device.
- ◆ Preview Picture: screenshots will be stored in this directory for viewing.
- ◆ Change device information: can change the device information.
- ◆ Change device parameter: can change the brightness and contrast.
- ◆ Change device network mode: can switch the network mode in WIFI or AP.
- ◆ About device: show the device information of firmware version, network mode and SSID.
- ◆ Help: guide for some possible doubts.

A) Change device information:
 In the condition of device connected, modify the “ Name ” according to the below picture. For the password modification, click the button “ synchronize to the remote device ” to enter the old password and new password of 8 digits (the default password is 88888888). And then click the top right button to save it.

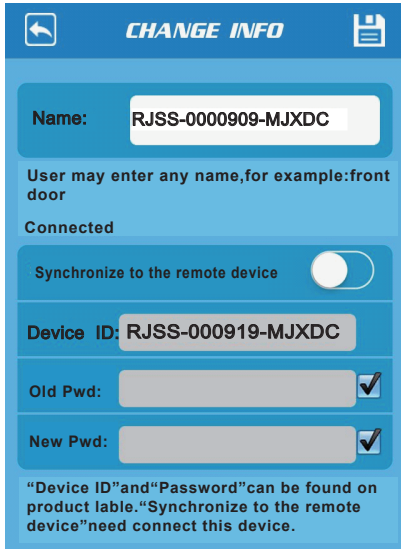

B) Change device parameter:
 According to the actual requirement to adjust the brightness and contrast of the video interface .

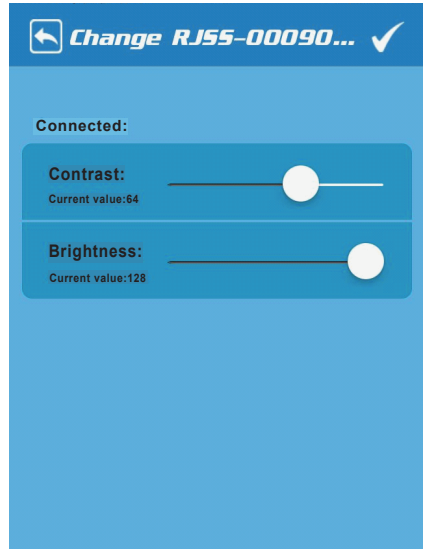

C) Change device network mode:

Click “ change device network mode ” (as shown on the right). The interface shows the “ WI-FI mode ” . Slide the button to switch the network mode. Click the “ AP mode ” to switch to AP mode interface(the AP mode interface cannot be edited.) Then click the top right button to synchronize to device ends.

Connect different router by switching Android device in WI-FI mode. Click “ choose SSID ” to choose WI-FI interface. Choose new router and connect, back to left interface to input password. Click top right button to synchronize to device ends.

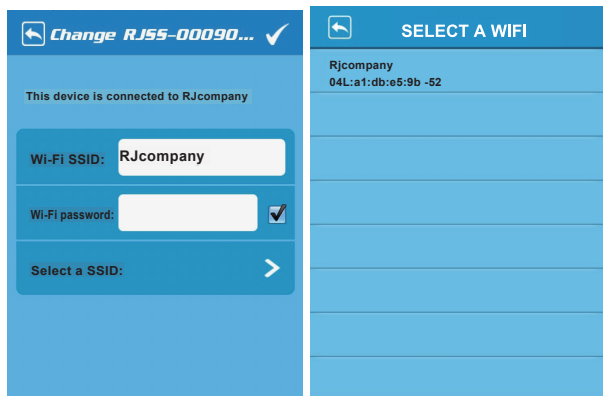

D) Check device information interface:
Click “ About device ” button to check the device information.



E) Preview picture:
Click “ preview picture ” button to enter the image file lists, select the file to view.

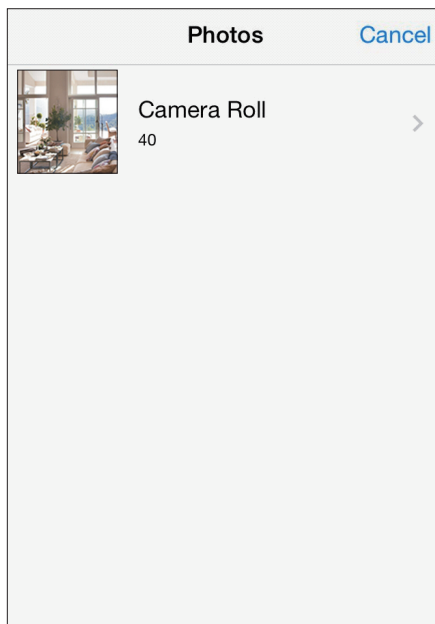



F) Help:

Click the button to enter help document. (see the APP for details)

6. Remove device

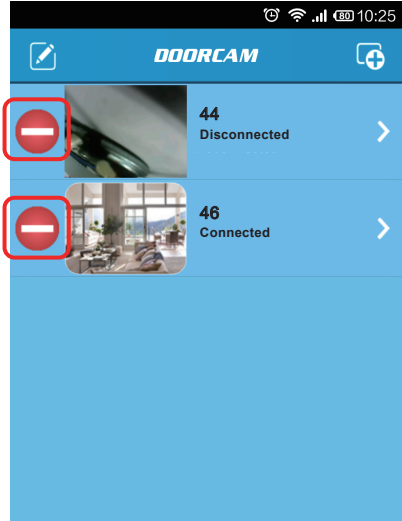
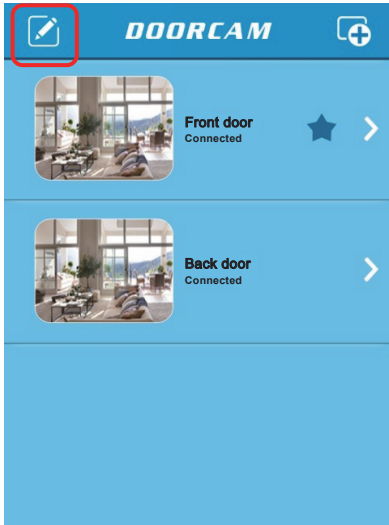
In the device list interface, Click the top left “ editing ” button to enter into the interface of device-deleting. Click the left “ deleting button ” of the list, device is on the deleting condition. Click the top left “ editing ” button to exit the editing condition.



When the device is on the deleting condition, click the  button to exit the deleting condition. Click “ Delete ” to delete the device.

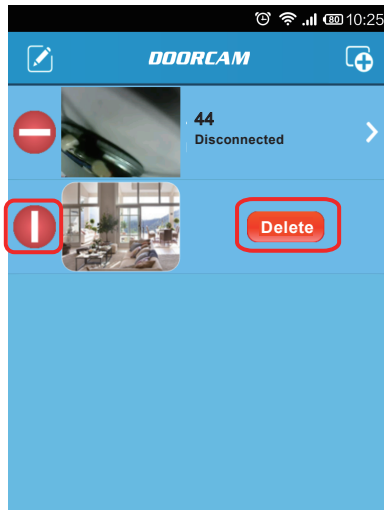

7. Dual mode switch

To adapt different request of users the device can support AP mode and Station mode.

AP Mode

AP is short for (Wireless) Access Point, for direct connection. User can implement connection by point-to-point. In this state, user can exclude the external network interference and traffic problem.

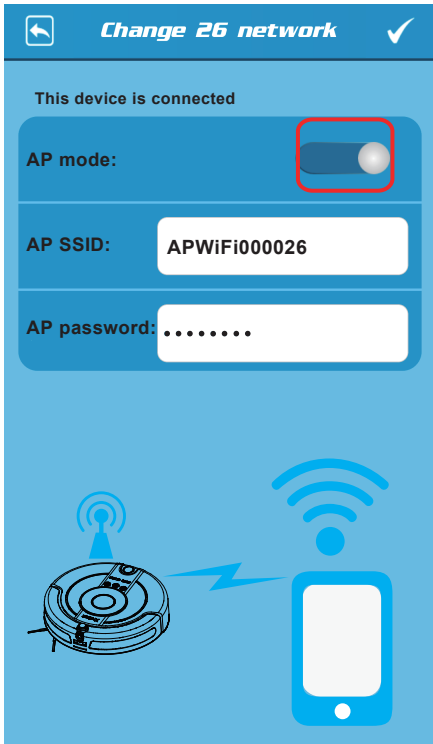

Station Mode

This mode is mainly used for user going online and wireless coverage. By the routing function, it can realize the connection sharing of home wireless network, ADSL and wireless shared access of the residential areas.

