

# serenelife<sup>∞</sup>



## SLHELMBYBK

### Sports Safety Helmet

Multi-Sport for Kids and Youth (Black)

## USER GUIDE

**Questions? Issues?**

We are here to help!

Phone: (1) 718-535-1800

Email: [support@pyleusa.com](mailto:support@pyleusa.com)

## User Guide

- Selecting the right helmet size, from several available sizes, chose the one which fits you at ease, without being uncomfortably tight. For maximum protection, the helmet must also protect user's forehead, so do not push it far too back on your head. To put the helmet ON properly, please see the pictures **A** — correct, **B** — incorrect wearing. Please use the adjustment system for the proper size adjusting.

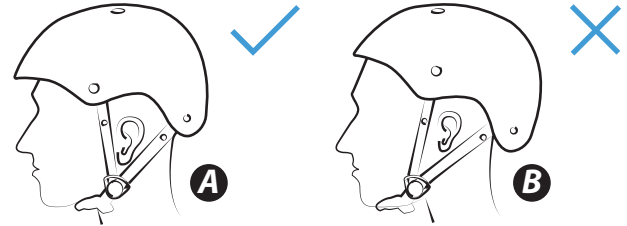

- Adjust the length of the straps before using the helmet so that the helmet fits your head at ease but without moving forward or back on your head. The straps may never cover ears and must lead around them way down, so that the buckle is positioned under the chin. Adjust the buckle not to lie on the bone of the chin. If the helmet is put on properly, it does not cover the driver's sight.
- **NOTICE: Check the right helmet adjustment everytime and before using the helmet!**
- All safety equipment has limitations. Helmets reduce or prevent many injuries, but no helmet can protect the user from all foreseeable accidents. Depending on the type of impact, even a very low speed accident can cause serious injury or death.
- Replace your helmet immediately after each impact as the helmet construction can be damaged, even if no damage is visible.
- This helmet is intended only for bicycling. It is not intended for motorcycle, motor sport, moped or other uses.
- Clean the helmet using a soft cloth or sponge, warm water and mild soap.
- Use only original parts from the distributor. Putting away parts from the helmet can decrease the helmet's protection level.
- Store your helmet in a cool dry place, away from heat or direct sunlight. The helmet should be packed in a cardboard box during transport. This helmet is designed to protect impact cause by collision of head with an obstacle while cycling or roller skating.

The helmet can be used up to max. 3 years from the date of manufacture (except in case of damage/accident or a hard fall which can cause invisible cracks). Please dispose your helmet at the end of service life. Contact your local waste disposal company for correct disposal.