



serenelife™



*SLSTBX60*

120 Gal. Outdoor Deck Box Storage  
for Garden Tools, Furniture and Sports Equipment,  
Water-resistant, Lock Included

**USER GUIDE**



## ASSEMBLY INSTRUCTIONS

Our clear, easy-to-follow, step-by-step instructions will guide you through the project from start to finish. **DO NOT** assemble this item alone for your safety. Two people are necessary for smooth & safe installation.

**Item identification:** For ease of identification, all parts are labeled to correspond to the step number in which the part is used.

### IMPORTANT

#### CAUTION:

**Read following instructions carefully before using chair.**

- Outdoor Deck Box Storage holds maximum of 600 lbs.
  - Keep fingers away from hinged area of Outdoor Deck Box Storage.
  - Do not stand on Outdoor Deck Box Storage.
  - Place Outdoor Deck Box Storage on a flat, not-slippery surface only.
1. Keep all children and pets away from assembly area.  
Children and pets should be supervised while product is being assembled.
  2. The assembled product should be located at least 6 feet (2 m) from any obstruction such as fence, garage, house, overhanging branches, laundry lines or electrical wires.
  3. This unit is heavy. Do not assemble this item alone.  
2 people are recommended for safe assembly.
  4. Some parts may contain sharp edges.  
Wear protective gloves if necessary during assembly.
  5. When assembling and using this product, basic safety precautions should always be followed to reduce the risk of personal injury and damage to equipment. Please read all instructions before assembly and use.
  6. For Indoors and Outdoors use.
  7. Check all bolts for tightness before usage.
  8. Please check your state and local regulations prior to purchasing.  
Some jurisdictions may require permits for installation and use of this product.  
Some special procedures may be valid in your area.

**PARTS LIST**



**A (X2)**

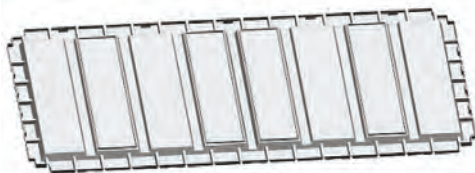

**B (X1)**



**C (X2)**



**D (X3)**



**E (X3)**



**G (X1)**



**I (X1)**



**H (X2)**

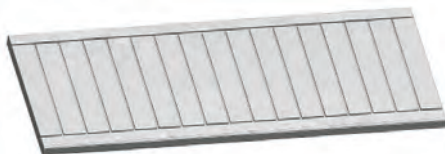

**J (X1)**



**L (X39)**



**T (X7)**

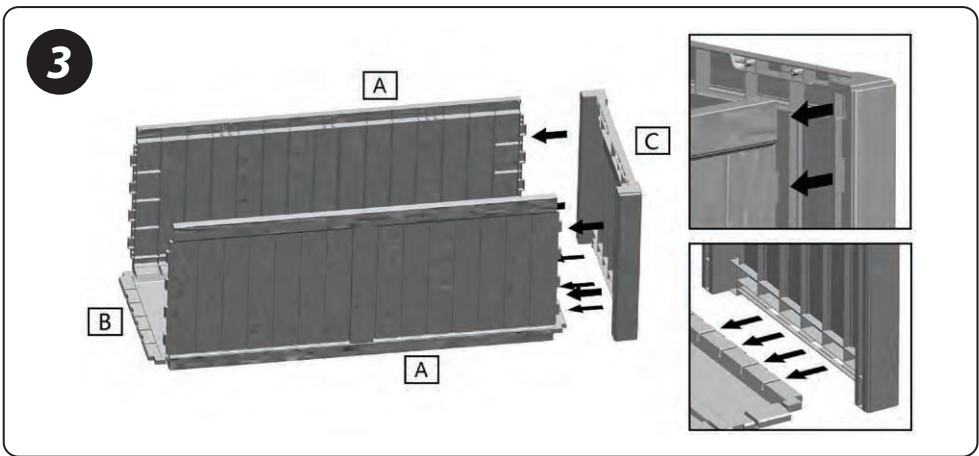
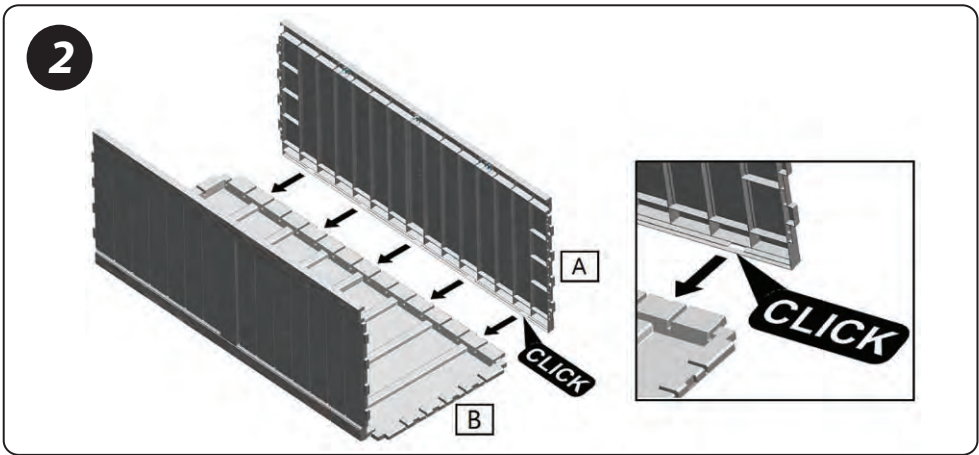
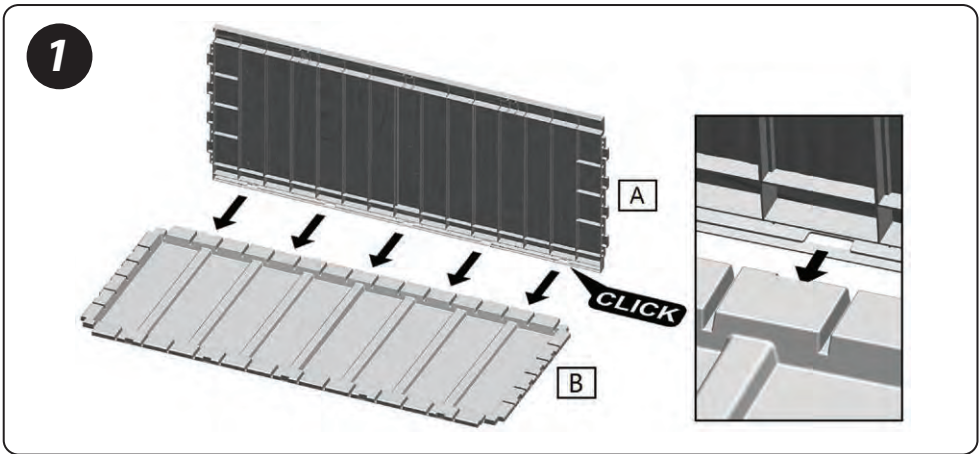

4

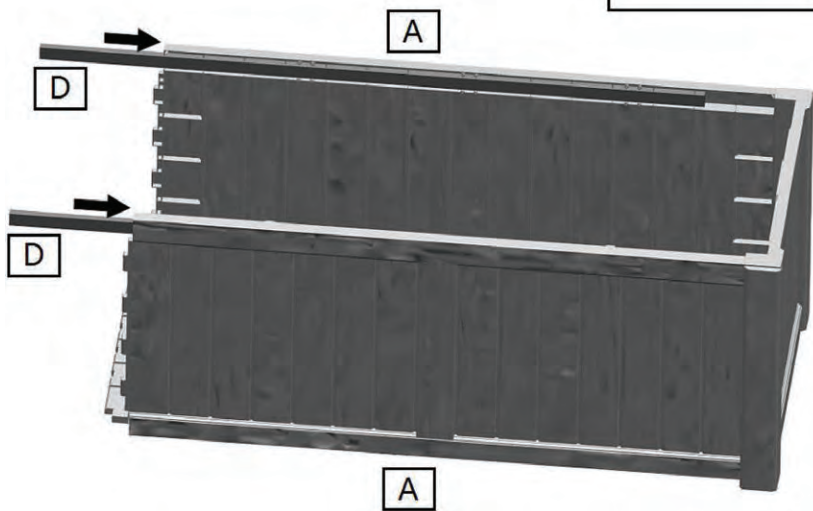
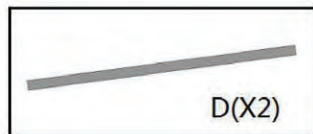

5

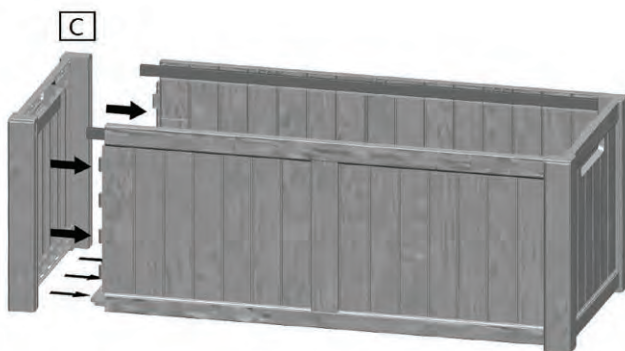
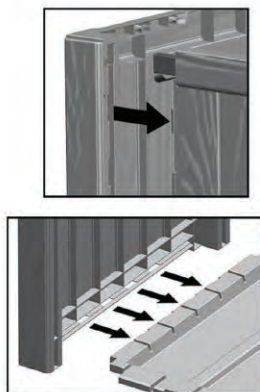

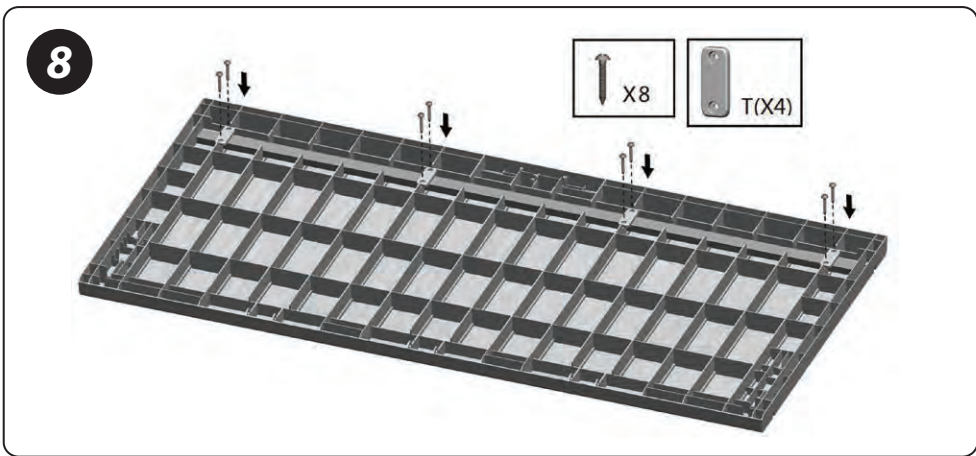
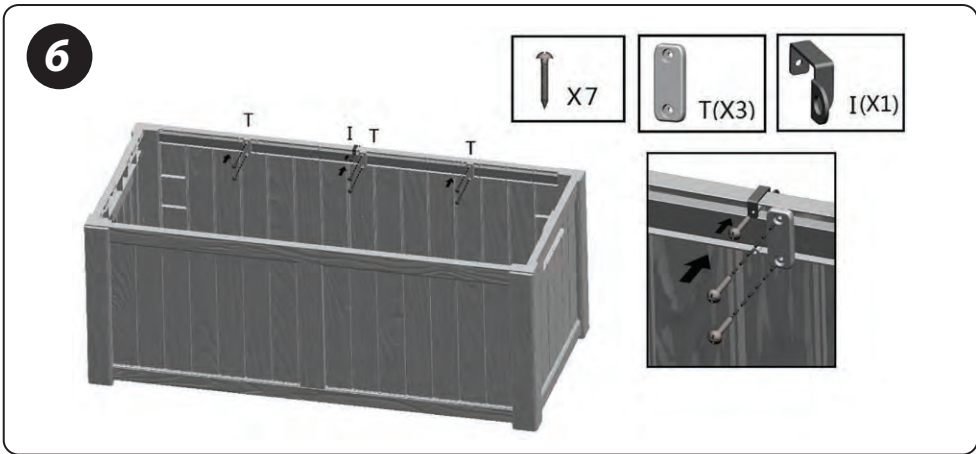

9

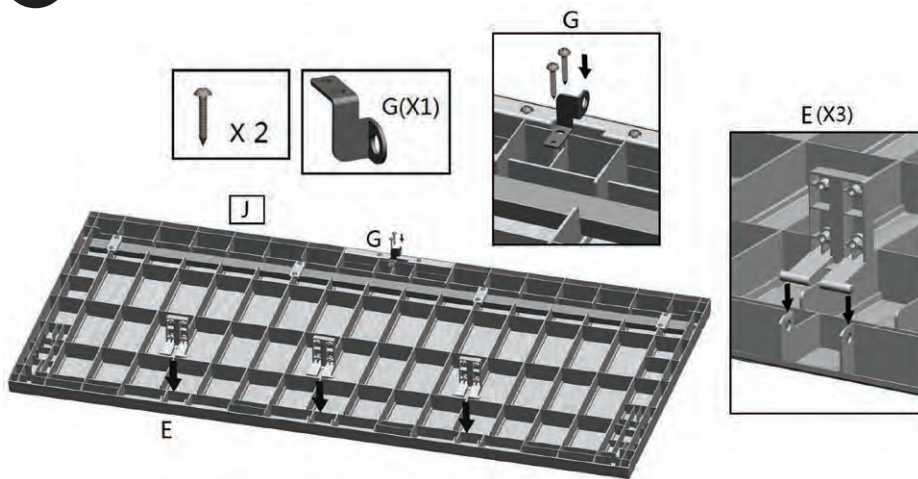

10

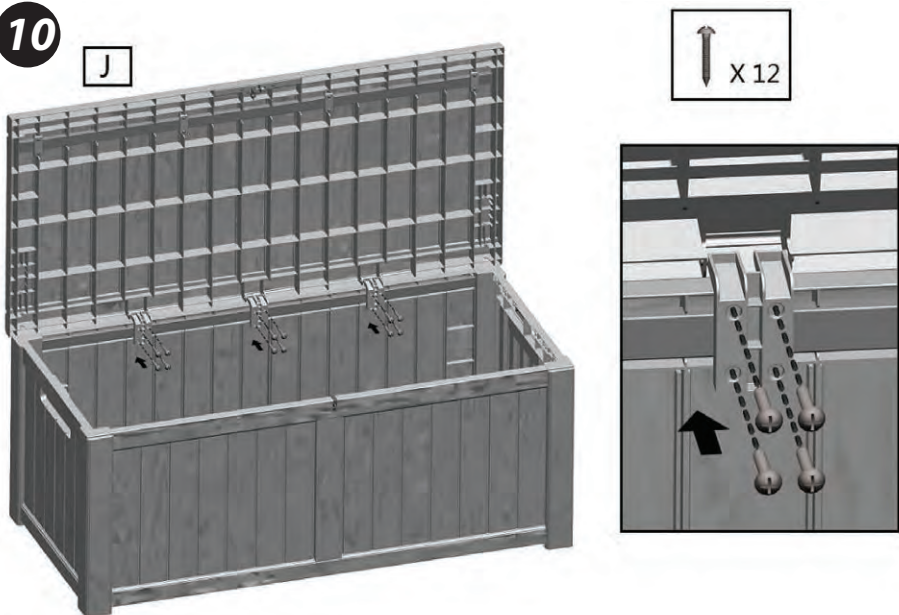



11

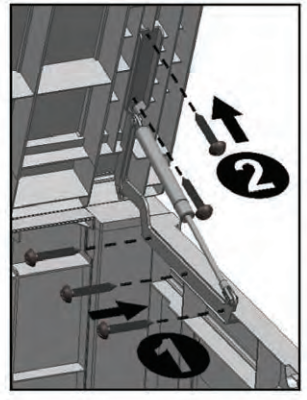
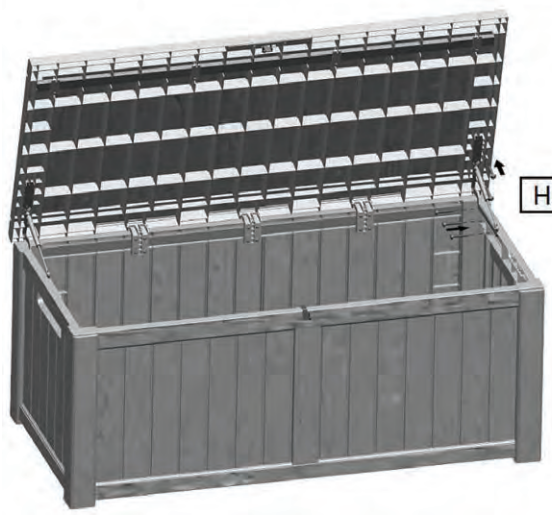
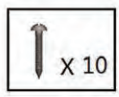

12





## Features:

- Weatherproof and Waterproof Outdoor Furniture
- UV and Fade Resistance
- Durable and Long-lasting Use
- Easy to Assemble
- Marine-grade Quality Hardware
- Comfortable Side Handles
- Updated PP Material to Prevent Bending and Fading
- Iron Rods added for Extra Support and Strength
- Use for Indoors and Outdoors, Pillows, Pool Toys, Garden Tools, Furniture and Sports Equipment
- Great Option for Home Storage and Organization

## What's in the Box:

- Outdoor Deck Box Storage
- Iron Tube
- Gas Rope
- 304 Screw

### California Prop 65 Warning

 **WARNING:**

This product contains Polycyclic aromatic hydrocarbons (PAHs) which is known to the state of California to cause cancer birth defects and other reproductive harm. Do not ingest.

For more info go to: [www.P65warnings.ca.gov](http://www.P65warnings.ca.gov)

## Technical Specs:

- Construction Materials: PP
- Maximum Capacity: 120 Gallon
- Weight Capacity: 600 lbs.
- Assembly Time: 20-25 minutes
- Overall Size: 56.3" x 26.6" x 23.8" -inches



serenelife™

**Questions? Comments?**

We are here to help!

Phone: (1) 718-535-1800

Email: [support@pyleusa.com](mailto:support@pyleusa.com)

